

MANDAN and BISMARCK

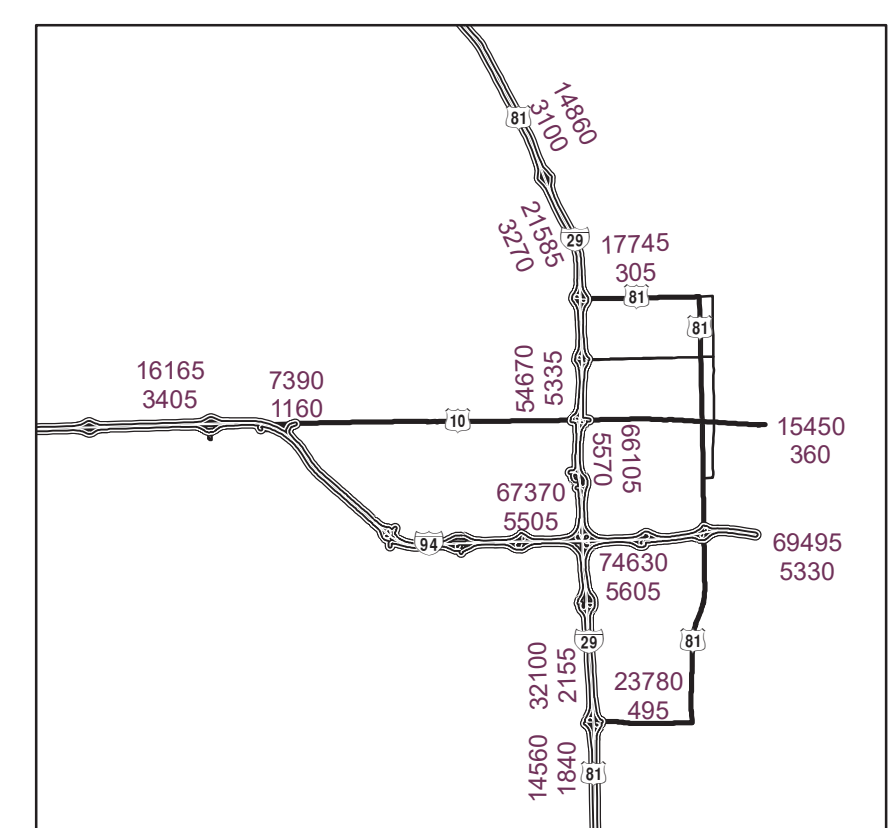

WEST FARGO and FARGO

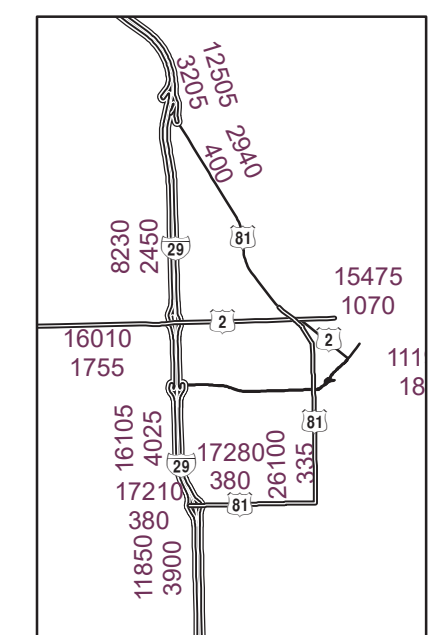

GRAND FORKS

2018 TRAFFIC VOLUME MAP

STATE OF NORTH DAKOTA

PREPARED BY THE
 NORTH DAKOTA DEPARTMENT OF TRANSPORTATION
 PLANNING / ASSET MANAGEMENT DIVISION
 IN COOPERATION WITH THE
 U.S. DEPARTMENT OF TRANSPORTATION
 FEDERAL HIGHWAY ADMINISTRATION

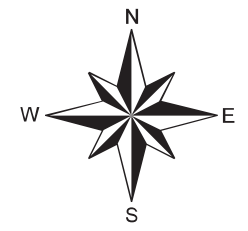

LEGEND

- INTERSTATE NUMBERED HIGHWAY
- US NUMBERED HIGHWAY
- STATE NUMBERED HIGHWAY
- COUNTY LINE

TRAFFIC LEGEND

- AA DT (Average Annual Daily Traffic) - 2500
- COMMERCIAL TRUCK TRAFFIC - 150

THE TRAFFIC FIGURES ARE THE TOTAL AT THE CLOSEST HIGHWAY INTERSECTION OR TOWN.

Notice of Disclaimer
 The North Dakota Department of Transportation (NDOT) makes this map available on an "as is" basis as a public service. Under no circumstances does NDOT warrant or certify the information to be free of errors or deficiencies of any kind. NDOT specifically disclaims all warranties, express or implied, including but not limited to the warranties of merchantability and fitness for a particular purpose.
 COPIES OF THIS MAP ARE AVAILABLE FOR PUBLIC USE AT A NOMINAL COST FROM:
 MAP SALES, ND DEPARTMENT OF TRANSPORTATION, 608 E. BLVD. AVE., BISMARCK, N.D. 58505-0700

2018 - YEAR COUNTED

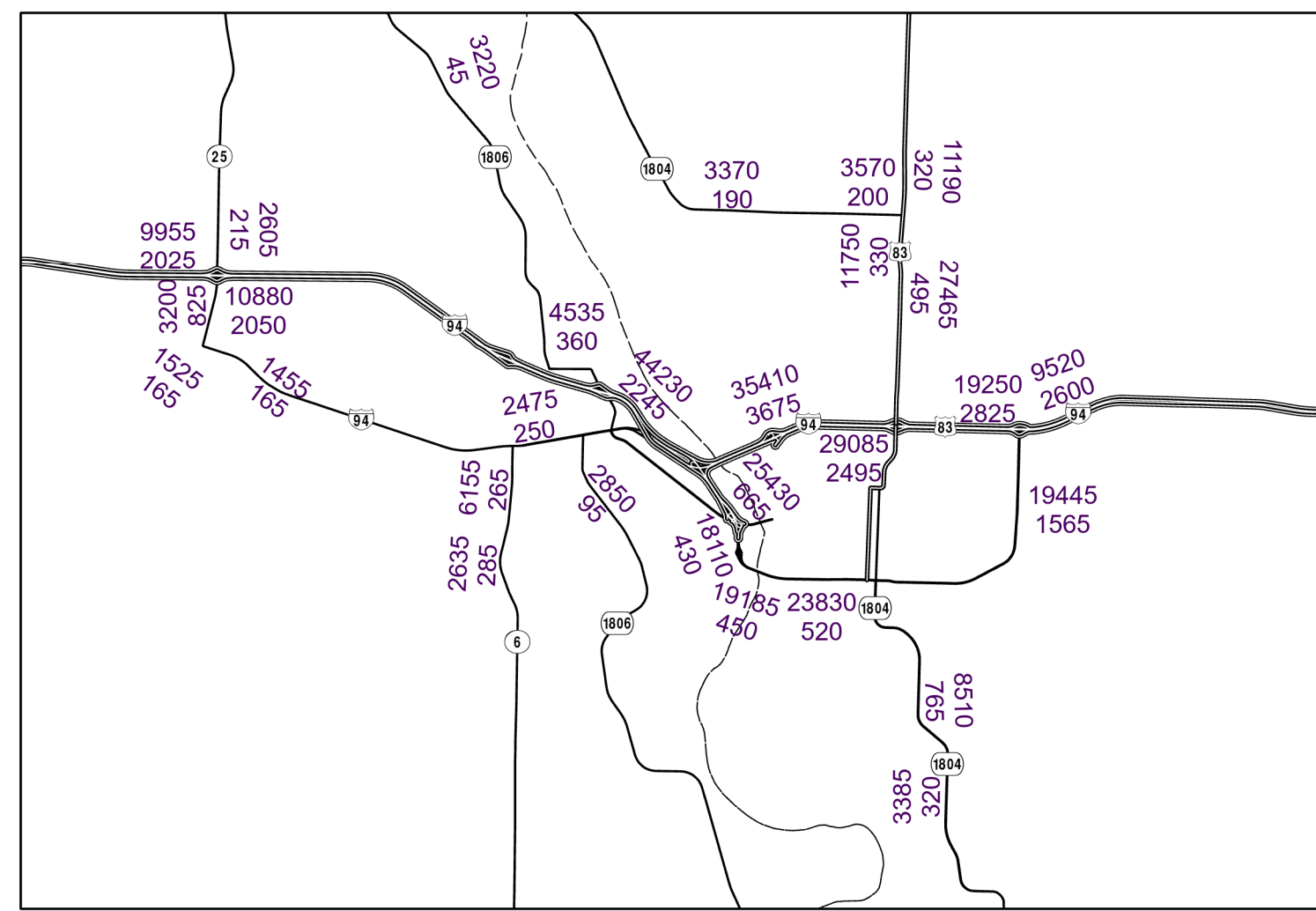

MANDAN and BISMARCK

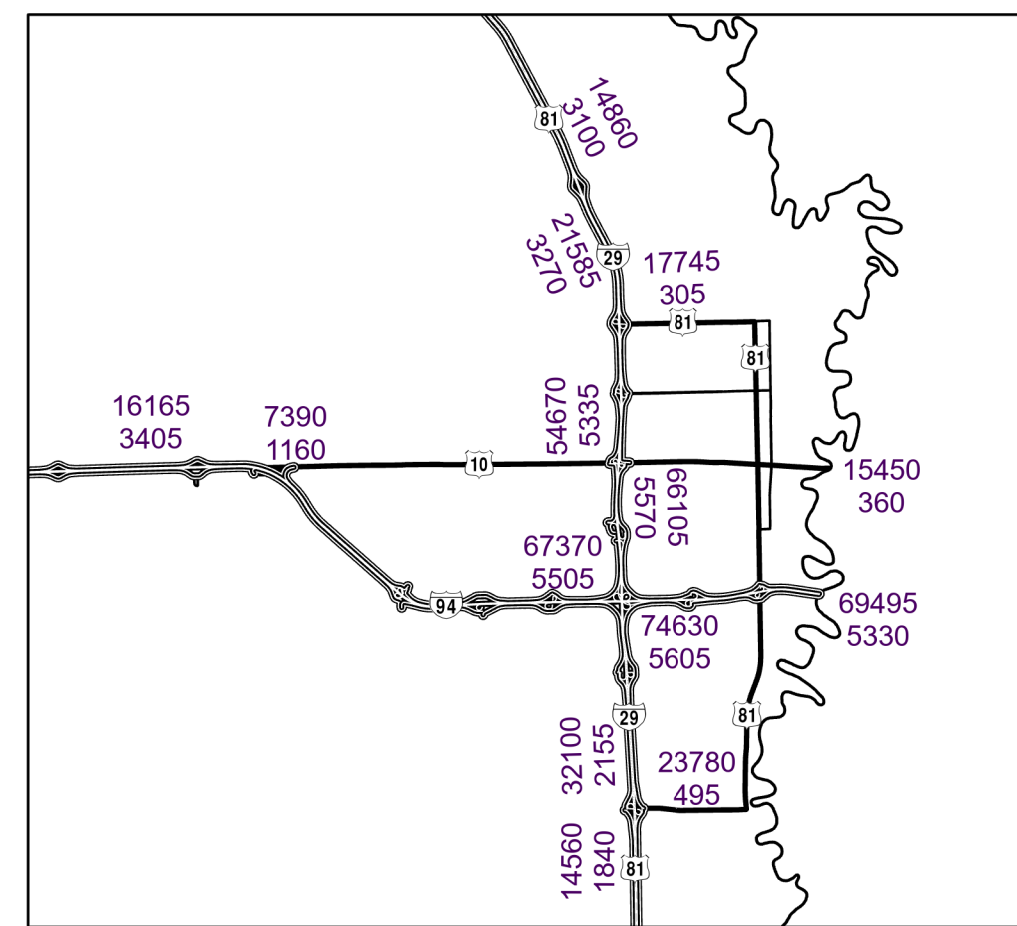

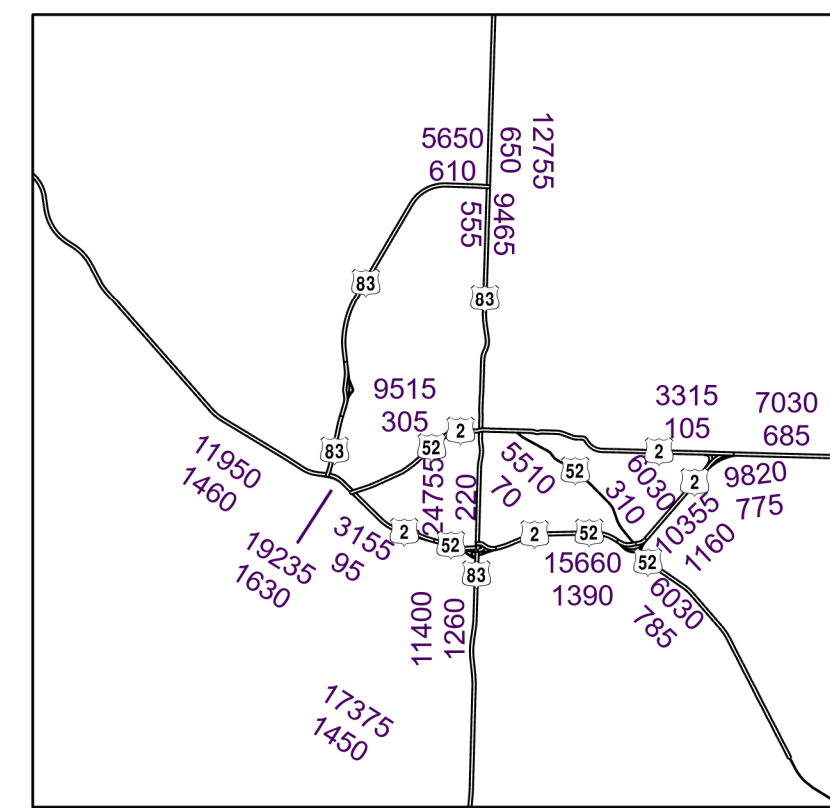

WEST FARGO and FARGO

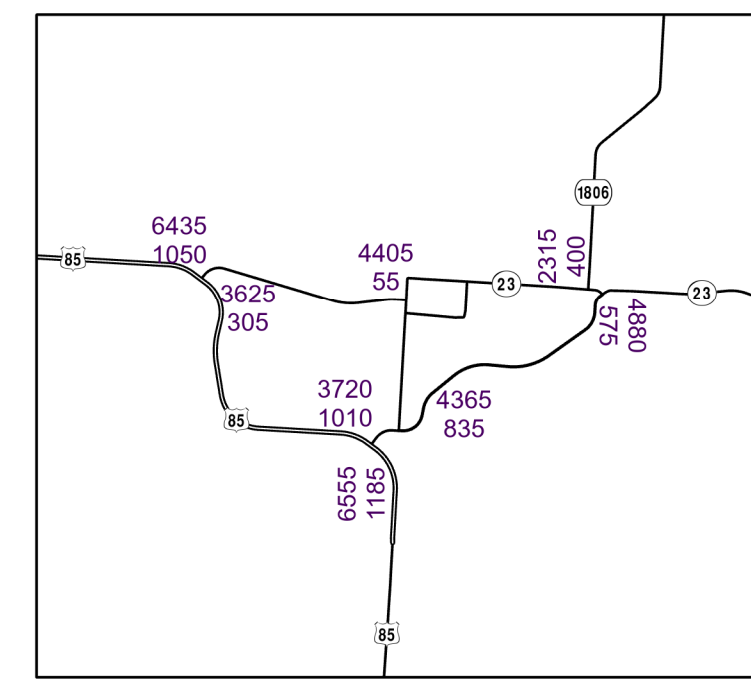

MINOT

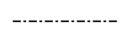
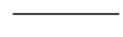

WATFORD CITY

INTERSTATE NUMBERED HIGHWAY 
 US NUMBERED HIGHWAY 
 STATE NUMBERED HIGHWAY 
 COUNTY LINE 
 STATE LINE 

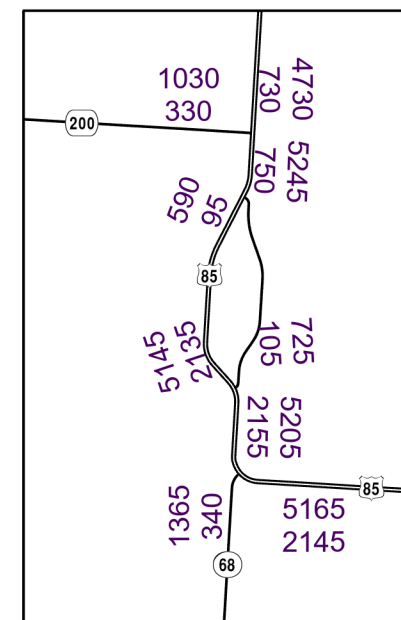

ALEXANDER

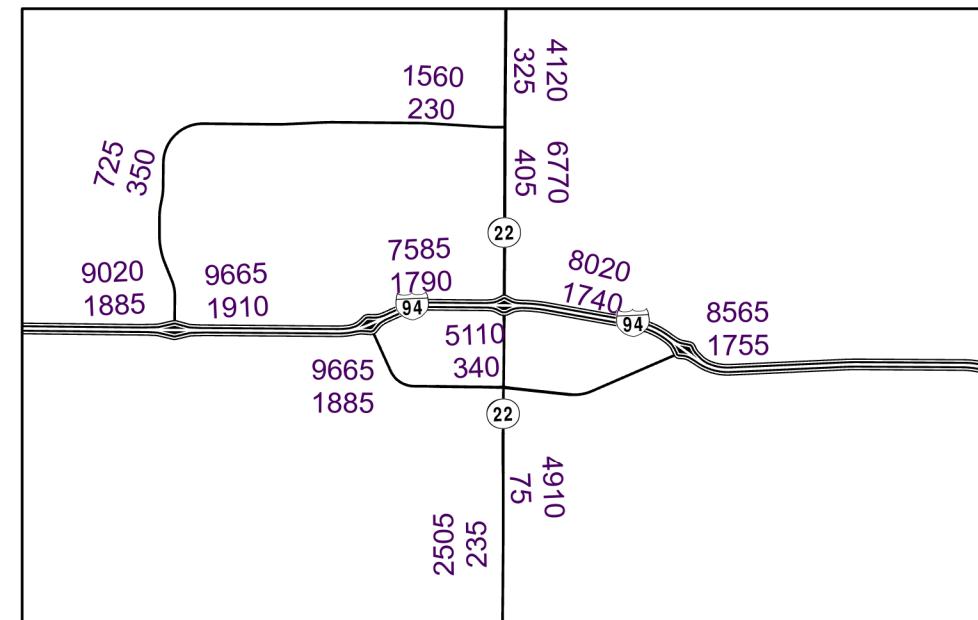

DICKINSON

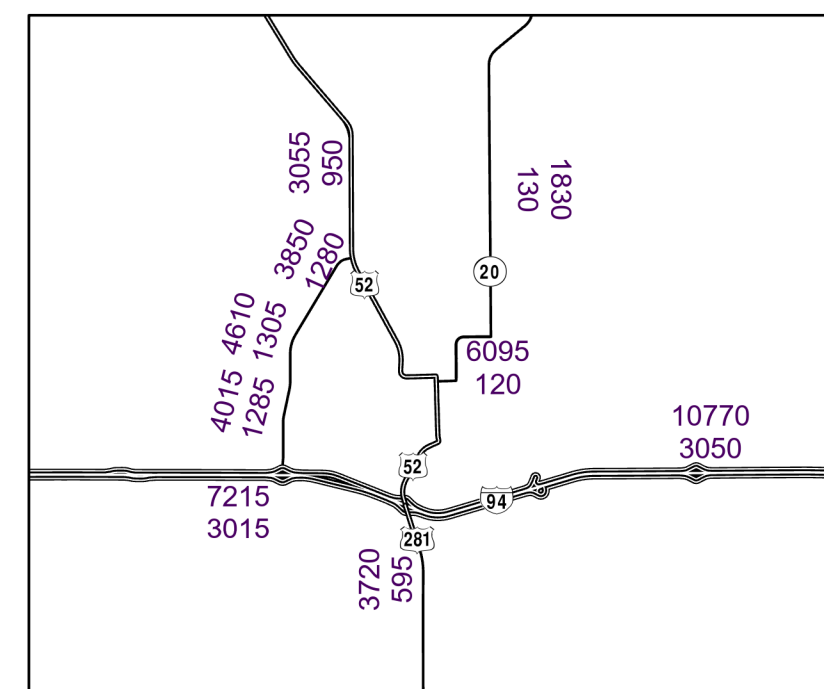

JAMESTOWN

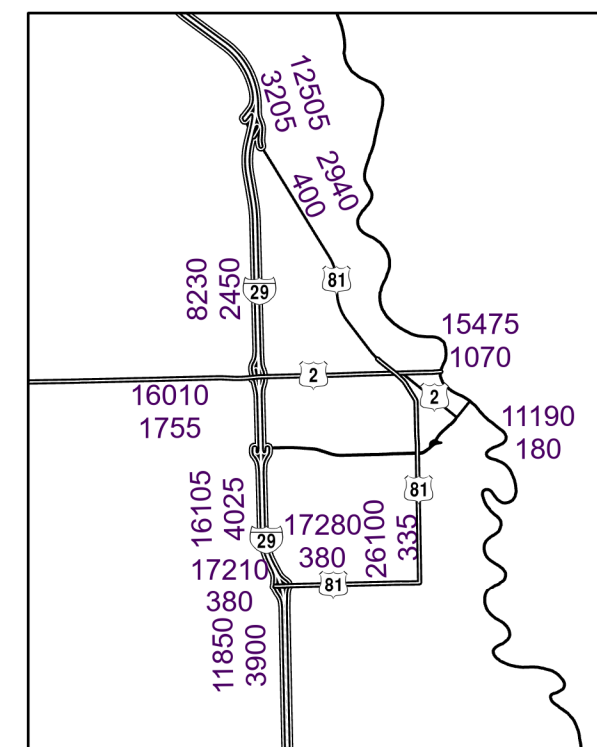

GRAND FORKS

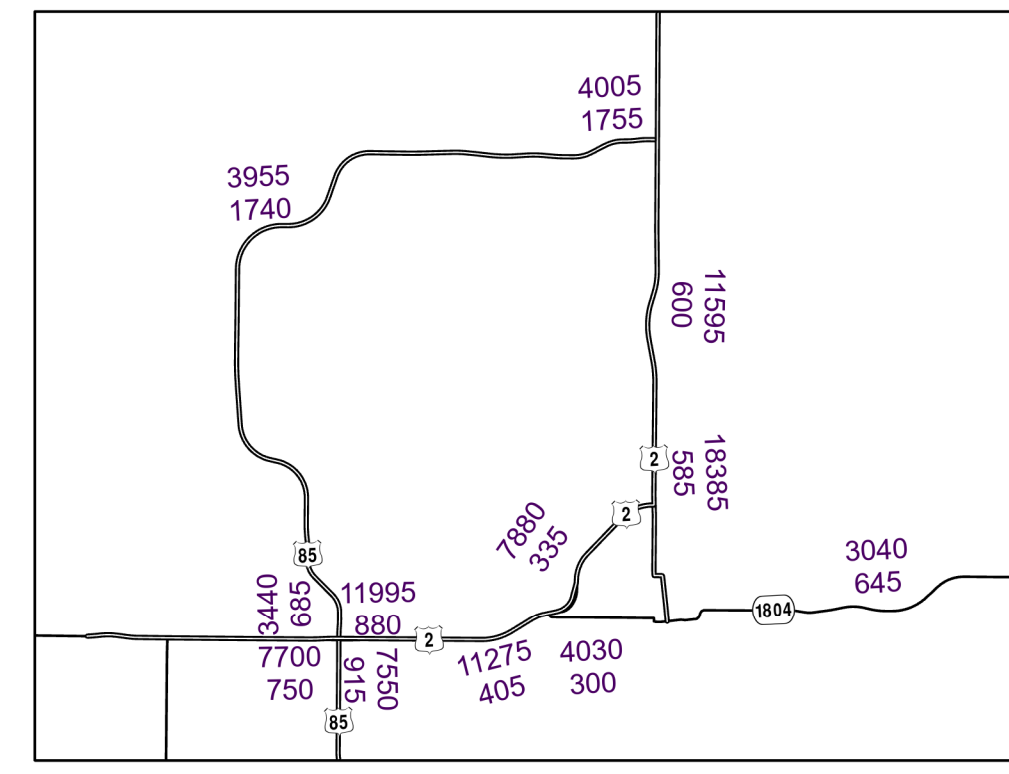

WILLISTON

AADT (Average Annual Daily Traffic) - 2500
 COMMERCIAL TRUCK TRAFFIC - 150
 THE TRAFFIC FIGURES ARE THE TOTAL AT THE CLOSEST HIGHWAY INTERSECTION OR TOWN.
 MAINLINE INTERSTATE IN ALL 3 REGIONS ARE COLLECTED EVERY YEAR

2022 - YEAR COUNTED

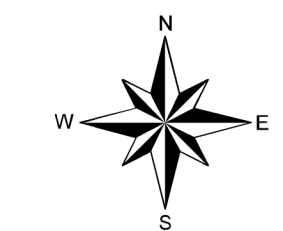

0 1 2 4 6 8 Miles

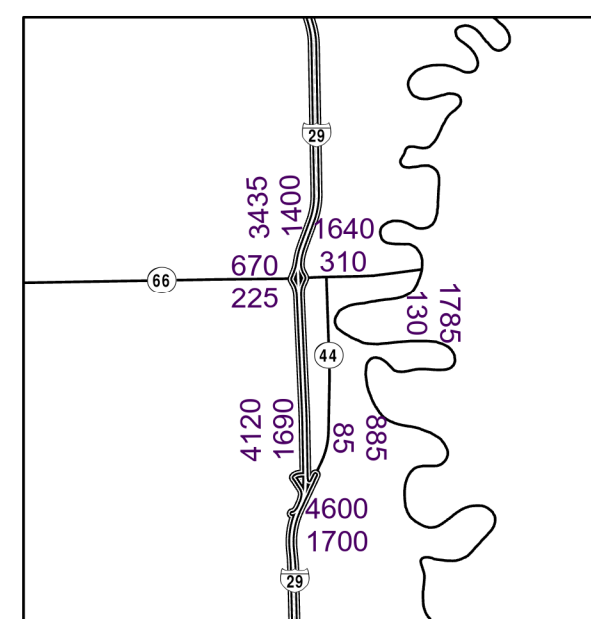

DRAYTON

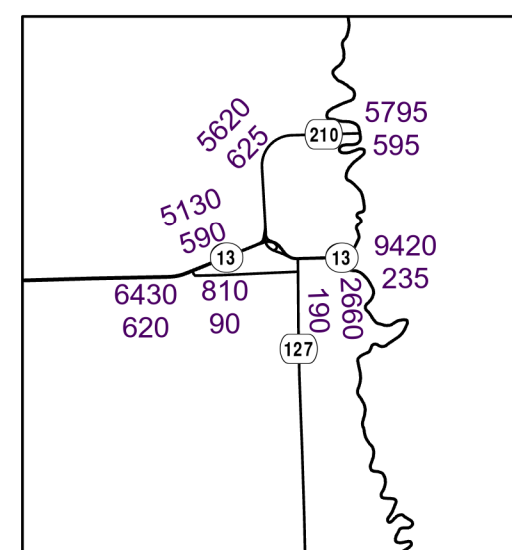

WAHPETON

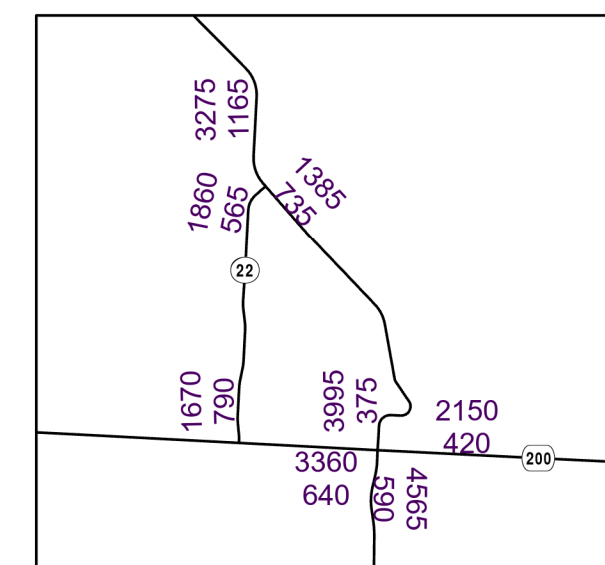

KILLDEER

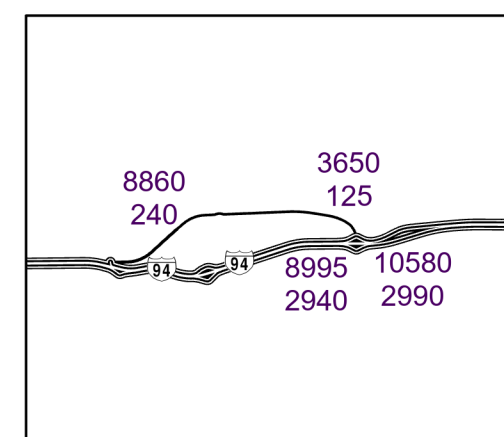

VALLEY CITY

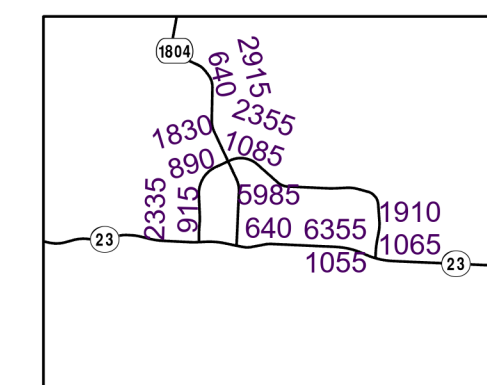

NEW TOWN

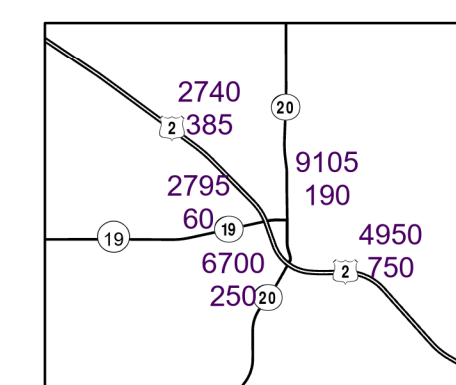

DEVILS LAKE

2022
 TRAFFIC VOLUME MAP
 STATE OF
 NORTH DAKOTA

PREPARED BY THE
 NORTH DAKOTA DEPARTMENT OF TRANSPORTATION
 PLANNING / ASSET MANAGEMENT DIVISION
 IN COOPERATION WITH THE
 U.S. DEPARTMENT OF TRANSPORTATION
 FEDERAL HIGHWAY ADMINISTRATION

Notice of Disclaimer
 The North Dakota Department of Transportation (NDDOT) makes this map available on an "as is" basis as a public service. Under no circumstances does NDDOT warrant or certify the information to be free of errors or deficiencies of any kind. NDDOT specifically disclaims all warranties, express or implied, including but not limited to the warranties of merchantability and fitness for a particular purpose.