

2007 FUNCTIONAL CLASSIFICATION

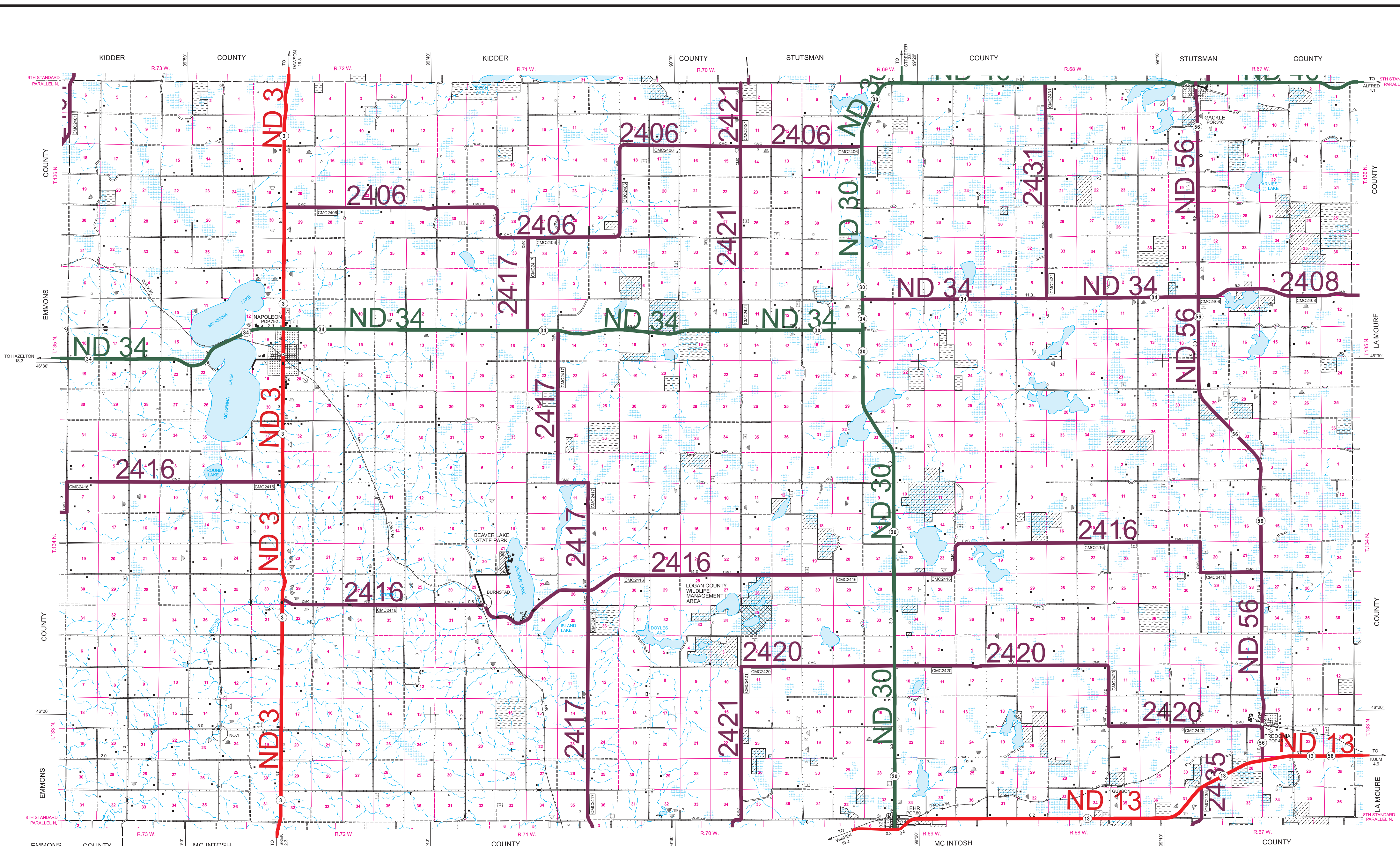

GENERAL LEGEND

ROADS AND ROADWAY FEATURES PRIMITIVE ROAD UNIMPROVED ROAD GRADED AND DRAINED ROAD GRAVEL GRADED AND DRAINED ROAD PAVED ROAD STREETS IN UNINCORPORATED AREAS COUNTY MAJOR COLLECTOR ROUTE NUMBER POINTS BETWEEN WHICH DISTANCES ARE MEASURED U.S. NUMBERED HIGHWAY STATE HIGHWAY SYSTEM	RAILROADS RAILROAD (ANY NUMBER OF TRACKS USED BY A SINGLE OPERATING CO.) RAILROAD STATION RAILROAD GRADE CROSSING RAILROAD ABOVE RAILROAD BELOW RAILROAD BRIDGE STRUCTURES HIGHWAY BRIDGE, GENERAL HIGHWAY GRADE SEPARATION DAM WITH ROAD MINOR DRAINAGE STRUCTURE CONCRETE FORD OR DIP FORD - ROAD ESTABLISHED	CONSERVATION AND RECREATION PICNIC GROUND PLAYGROUND, BALL FIELD, ETC. BATHING BEACH OR SWIMMING POOL TOURIST COURT, OR MOTEL SMALL PARK (SP-STATE, CP-COUNTY) MUNICIPAL, WP-WAYSIDE PARK GOLF GROUND OR COUNTRY CLUB AMUSEMENT PARK OR HALL FAIR GROUND, RACE COURSE, SPEEDWAY RIFLE CLUB
BOUNDARIES COUNTY LINE TOWNSHIP LINE CORPORATE LINE SECTION LINE BOUNDARY TO MARK ENLARGEMENT INSET WILDLIFE MANAGEMENT AREA WATERFOWL PRODUCTION AREA STATE PARKS STATE SCHOOL LAND	DRAINAGE INTERMITTENT STREAM (NARROW) NARROW STREAM WIDE STREAM WIDE STREAM WITH DAM LAKE, RESERVOIR, OR POND LAKE, RESERVOIR, OR POND WITH DAM MARSH OR SWAMP LAND	AIRPORTS LANDING AREA OR STRIP PUBLIC SERVICE FACILITIES POST OFFICE HIGHWAY GARAGE FIRE ENGINE HOUSE GARBAGE OR RUBBISH DUMP SEWAGE DISPOSAL PLANT AUTOMOBILE GRAVEYARD WATER SUPPLY STAND PIPE OR TANK POWER SUBSTATION
FARM UNITS, DWELLINGS, ETC. FARM UNIT (FARM UNITS SHOWN IN MUNICIPAL LIMITS INDICATE FARM BUILDINGS FOR FARM USE) DWELLING OTHER THAN FARM ROWS OR GROUPS OF DWELLINGS (CLOSELY SPACED (FIGURE DENOTES NUMBER OF DWELLINGS) SEASONAL OR SUMMER COLONY DWELLING SEASONAL DWELLINGS CLOSELY SPACED HOTEL OR INN CEMETERY CHURCH CHURCH WITH CEMETERY ADJACENT	EDUCATIONAL AND CORRECTIONAL INSTITUTIONS SCHOOLHOUSE TOWNHALL, GRANGE, OR COMMUNITY HALL INDUSTRIAL STORE OR SMALL BUSINESS ESTABLISHMENT BUSINESS AND POST OFFICE FACTORY OR INDUSTRIAL PLANT OIL TANK GAS TANK GROUP OF STORAGE TANKS (OIL OR GAS) FILLING STATION PUMPING STATION (OIL OR GAS) GAUGING OR PUMPING STATION WAREHOUSE - GENERAL GRAIN ELEVATOR BEET DUMP STOCK YARD - LOADING PEN OR CORRAL GRAVEL PIT OIL OR GAS WELL	LAND AIRPORTS PUBLIC SERVICE FACILITIES EDUCATIONAL AND CORRECTIONAL INSTITUTIONS INDUSTRIAL CITY AND VILLAGE CENTERS COUNTY SEAT OTHER CITIES AND VILLAGES INCORPORATED CITY OR VILLAGE (GENERALIZED)
MISCELLANEOUS TRIANGULATION STATION DOT TO INDICATE LOCATION OF ANY CULTURAL FEATURE SHOWN OUT OF POSITION ALL VACANT CULTURE INDICATED BY OPEN SYMBOL LATITUDE AND LONGITUDE 47°07'	GENERAL LEGEND ROAD AND ROADWAY FEATURES RAILROADS BOUNDARIES DRAINAGE FARM UNITS, DWELLINGS, ETC. MISCELLANEOUS	GENERAL LEGEND CONSERVATION AND RECREATION AIRPORTS PUBLIC SERVICE FACILITIES EDUCATIONAL AND CORRECTIONAL INSTITUTIONS INDUSTRIAL CITY AND VILLAGE CENTERS

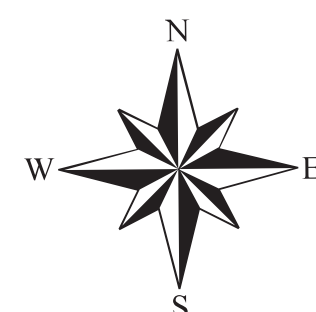

GENERAL HIGHWAY MAP LOGAN COUNTY NORTH DAKOTA

PREPARED BY THE
NORTH DAKOTA DEPARTMENT OF TRANSPORTATION
PLANNING / ASSET MANAGEMENT DIVISION
IN COOPERATION WITH THE
U.S. DEPARTMENT OF TRANSPORTATION
FEDERAL HIGHWAY ADMINISTRATION

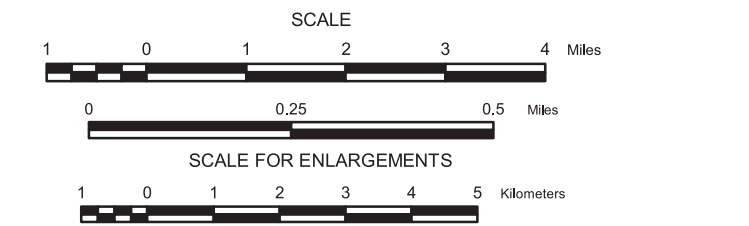

2014

BASED ON AERIAL PHOTOGRAPHY OF 1952
GROUND INVENTORY OF 2014
AERIAL INVENTORY OF 2014
UNIVERSAL TRANSVERSE MERCATOR ZONE 14
NORTH AMERICAN DATUM 83

LEGEND

	INTERSTATE
	PRINCIPAL ARTERIAL
	MINOR ARTERIAL
	MAJOR COLLECTOR

REVISION DATE AND CHANGE
05/12/2014 Added 1 mile to CMC 2435
01/23/2018 Removed 3 miles from CMC 2421
01/23/2018 Added 5 miles to CMC 2420
01/23/2018 Removed 3.8 miles from CMC 2415
01/23/2018 Added 3 miles to CMC 2417

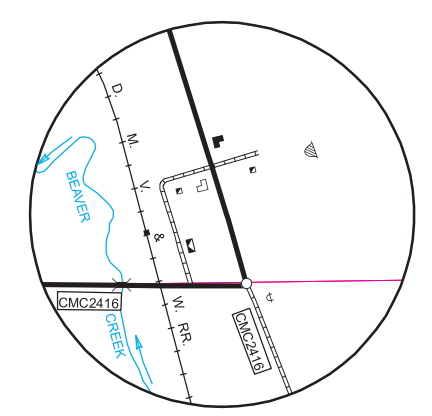

BURNSTAD
SEC'S. 29 & 32, T. 134 N., R. 71 W.

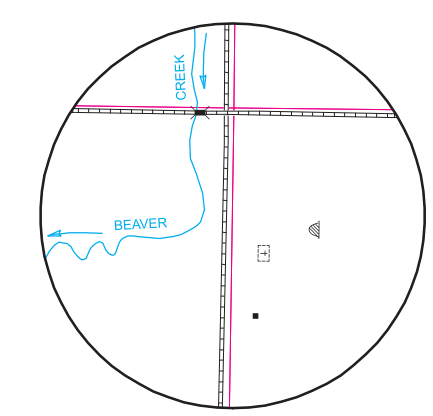

INSET NO. 1
SEC'S. 13, 14, 23 & 24, T. 133 N., R. 73 W.

NAME AND LOCATION OF ORGANIZED CIVIL TOWNSHIPS THOSE UNORGANIZED ARE SO NOTED

T. 136 N.-R. 73 W. SEALY	T. 134 N.-R. 73 W. UNORGANIZED
T. 136 N.-R. 72 W. GLENDALE	T. 134 N.-R. 72 W. STARKEY
T. 136 N.-R. 71 W. UNORGANIZED	T. 134 N.-R. 71 W. RED LAKE
T. 136 N.-R. 70 W. UNORGANIZED	T. 134 N.-R. 70 W. UNORGANIZED
T. 136 N.-R. 69 W. UNORGANIZED	T. 134 N.-R. 69 W. UNORGANIZED
T. 136 N.-R. 68 W. UNORGANIZED	T. 134 N.-R. 68 W. UNORGANIZED
T. 136 N.-R. 67 W. FINN	T. 134 N.-R. 67 W. JANKE
T. 135 N.-R. 73 W. KROEBER	T. 133 N.-R. 73 W. UNORGANIZED
T. 135 N.-R. 72 W. BRYANT	T. 133 N.-R. 72 W. UNORGANIZED
T. 135 N.-R. 71 W. DIXON	T. 133 N.-R. 71 W. UNORGANIZED
T. 135 N.-R. 70 W. UNORGANIZED	T. 133 N.-R. 70 W. UNORGANIZED
T. 135 N.-R. 69 W. UNORGANIZED	T. 133 N.-R. 69 W. UNORGANIZED
T. 135 N.-R. 68 W. UNORGANIZED	T. 133 N.-R. 68 W. UNORGANIZED
T. 135 N.-R. 67 W. GUTSCHMIEDT	T. 133 N.-R. 67 W. HAAG

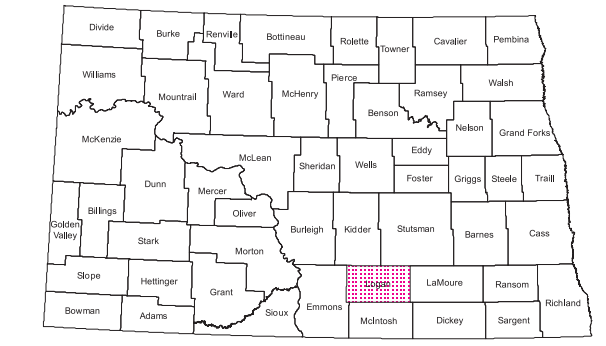

STATE OF NORTH DAKOTA
DIAGRAM OF COUNTIES

Notice of Disclaimer
The North Dakota Department of Transportation (NDDOT) makes this map available on an "as is" basis as a public service. Under no circumstances does NDDOT warrant or certify the information to be free of errors or deficiencies of any kind. NDDOT specifically disclaims all warranties, express or implied, including but not limited to the warranties of merchantability and fitness for a particular purpose.