

# 2007 FUNCTIONAL CLASSIFICATION

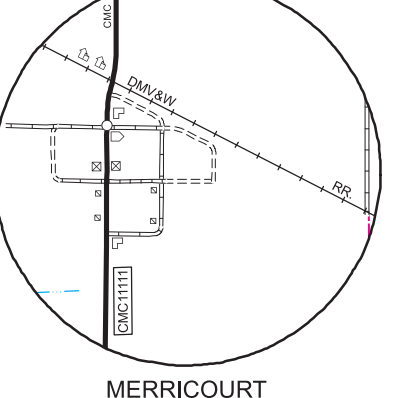
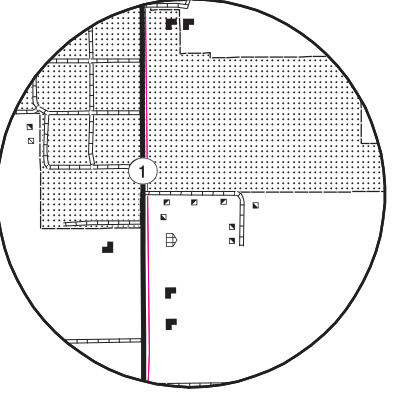
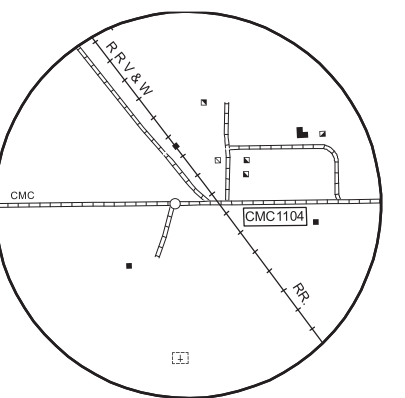
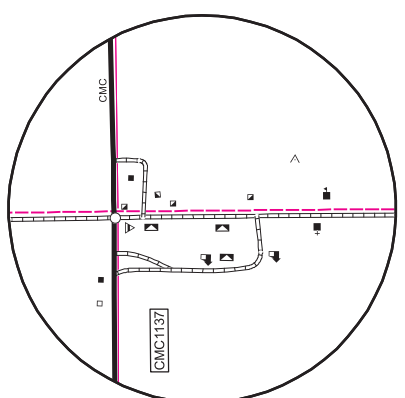
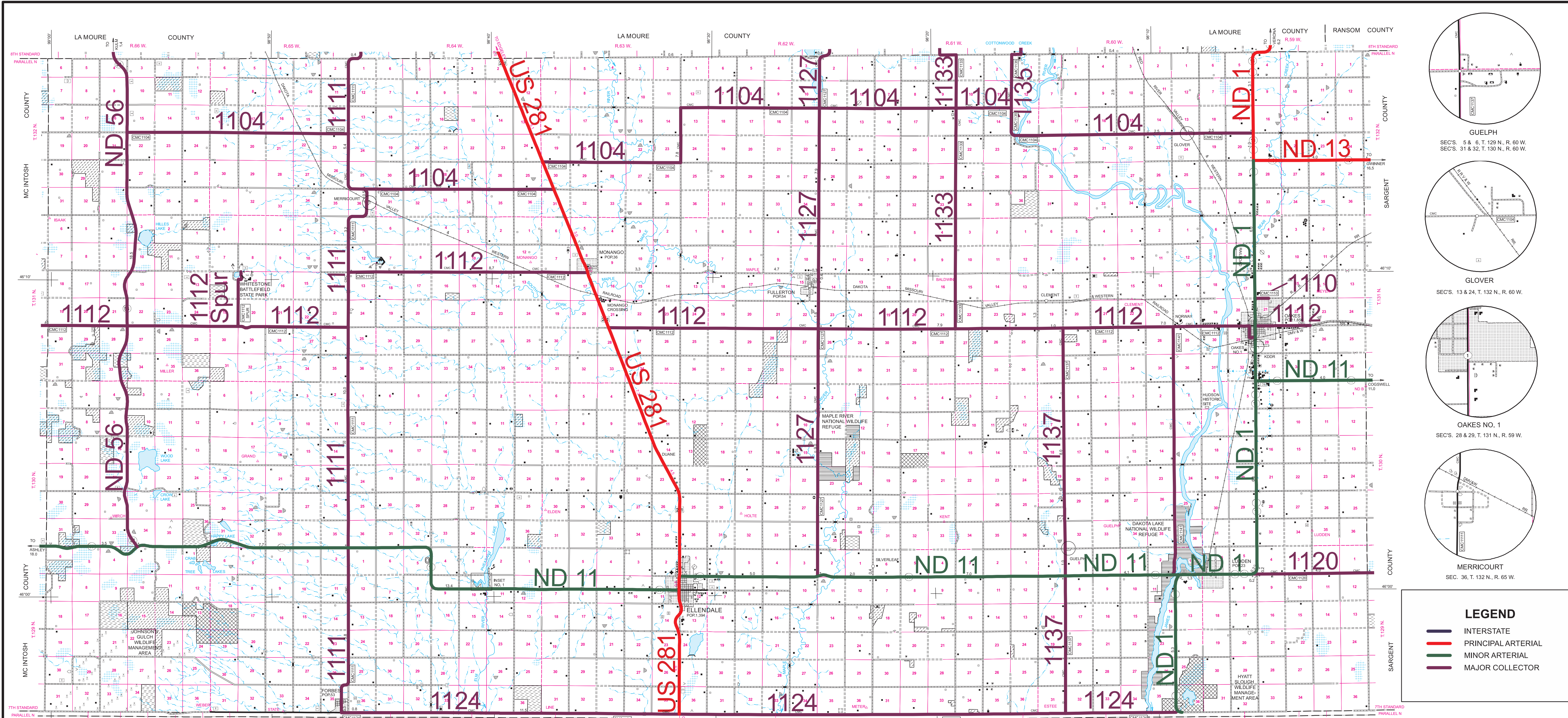

**LEGEND**

- INTERSTATE
- PRINCIPAL ARTERIAL
- MINOR ARTERIAL
- MAJOR COLLECTOR

**NAME AND LOCATION OF ORGANIZED CIVIL TOWNSHIPS THOSE UNORGANIZED ARE SO NOTED**

T. 132 N.-R. 66 W. NORTHWEST	T. 130 N.-R. 66 W. SPRING VALLEY
T. 132 N.-R. 65 W. YOUNG	T. 130 N.-R. 65 W. GRAND VALLEY
T. 132 N.-R. 64 W. POTSDAM	T. 130 N.-R. 64 W. ALBION
T. 132 N.-R. 63 W. VALLEY	T. 130 N.-R. 63 W. ELDEN
T. 132 N.-R. 62 W. PORTER	T. 130 N.-R. 62 W. KENTNER
T. 132 N.-R. 61 W. WRIGHT	T. 130 N.-R. 61 W. KENT
T. 132 N.-R. 60 W. JAMES RIVER	T. 130 N.-R. 60 W. HUDSON
T. 132 N.-R. 59 W. DIVIDE	T. 130 N.-R. 59 W. HUDSON
T. 132 N.-R. 58 W. GERMAN	T. 130 N.-R. 58 W. RIVERDALE
T. 131 N.-R. 66 W. WHITESTONE	T. 129 N.-R. 66 W. ALBERTHIA
T. 131 N.-R. 65 W. HAMBURG	T. 129 N.-R. 65 W. LORRAINE
T. 131 N.-R. 64 W. KEYSTONE	T. 129 N.-R. 64 W. ELM
T. 131 N.-R. 63 W. MAPLE	T. 129 N.-R. 63 W. ELLENDALE
T. 131 N.-R. 62 W. YORKTOWN	T. 129 N.-R. 62 W. VAN METER
T. 131 N.-R. 61 W. CLEMENT	T. 129 N.-R. 61 W. ADA
T. 131 N.-R. 60 W. CLEMENT	T. 129 N.-R. 60 W. PORT EMMA
T. 131 N.-R. 59 W. CLEMENT	T. 129 N.-R. 60 W. LOVELL
T. 131 N.-R. 59 W. BEAR CREEK	T. 129 N.-R. 59 W. LOVELL

**ROADS AND ROADWAY FEATURES**

- PRIMITIVE ROAD
- UNIMPROVED ROAD
- GRADED AND DRAINED ROAD
- GRAVEL GRADED AND DRAINED ROAD
- PAVED ROAD
- STREETS IN UNINCORPORATED AREAS
- COUNTY MAJOR COLLECTOR
- ROUTE NUMBER
- POINTS BETWEEN WHICH DISTANCES ARE MEASURED
- U.S. NUMBERED HIGHWAY
- STATE HIGHWAY SYSTEM
- AIRPORTS
- AIRFIELD LIMITED FACILITIES
- LANDING AREA OR STRIP
- RAILROADS
- RAILROAD (ANY NUMBER OF TRACKS USED BY A SINGLE OPERATING CO.)
- RAILROAD STATION

**CONSERVATION AND RECREATION**

- PLAYGROUND, BALL FIELD, ETC.
- BATHING BEACH OR SWIMMING POOL
- CAMP SITE, NO PERMANENCE (TENTS OR TRAILER PARKING)
- TOURIST COURT, OR MOTEL
- GOLF COURSE OR COUNTRY CLUB
- FAIR GROUND, RACE COURSE, SPEEDWAY
- RIFLE CLUB

**DRAINAGE**

- INTERMITTENT STREAM (NARROW)
- NARROW STREAM
- WIDE STREAM
- WIDE STREAM WITH DAM
- LAKE, RESERVOIR, OR POND
- LAKE, RESERVOIR, OR POND WITH DAM
- MARSH OR SWAMP LAND
- DRAINAGE DITCH

**NAVIGATION**

- DOCK, PIER, OR LANDING

**PUBLIC SERVICE FACILITIES**

- HIGHWAY GARAGE
- FIRE ENGINE HOUSE
- GARBAGE OR RUBBISH DUMP
- SEWAGE DISPOSAL PLANT
- AUTOMOBILE GRAVEYARD
- SCRAP METAL
- WATER SUPPLY STAND PIPE OR TANK
- POWER SUBSTATION
- BROADCASTING STATION (RADIO OR TV)
- COMMUNICATION TOWER

**EDUCATIONAL AND CORRECTIONAL INSTITUTIONS**

- SCHOOLHOUSE
- TOWNHALL, GRANGE, OR COMMUNITY HALL
- MUSEUM - GENERAL

**BOUNDARIES**

- STATE OR PROVINCE LINE
- COUNTY LINE
- TOWNSHIP LINE
- CORPORATE LINE
- SECTION LINE
- BOUNDARY TO MARK ENLARGEMENT INSET
- NATIONAL REFUGES
- MONUMENT - SMALL, HISTORIC SITE
- WILDLIFE MANAGEMENT AREA
- WATERFOWL PRODUCTION AREA
- STATE PARKS
- STATE SCHOOL LAND

**STRUCTURES**

- HIGHWAY BRIDGE, GENERAL
- DAM WITH ROAD
- MINOR DRAINAGE STRUCTURE
- CONCRETE FORD OR DIP
- FORD - ROAD ESTABLISHED

**INDUSTRIAL**

- STORE OR SMALL BUSINESS ESTABLISHMENT
- GROUP OF STORAGE TANKS (OIL OR GAS)
- PUMPING STATION (OIL OR GAS)
- GALVANIZING OR PUMPING STATION
- WAREHOUSE - GENERAL
- GRAIN ELEVATOR
- STOCK YARD - LOADING PEN OR CORRAL
- GRAVEL PIT
- GREENHOUSE
- CHURCH
- NURSERY
- WINDMILL

**MISCELLANEOUS**

- TRIANGULATION STATION
- DOT TO INDICATE LOCATION OF ANY CULTURAL FEATURE
- SHOWN OUT OF POSITION
- ALL VACANT CULTURE INDICATED BY OPEN SYMBOL
- LATITUDE AND LONGITUDE

**FARM UNITS, DWELLINGS, ETC.**

- FARM UNIT (FARM UNITS SHOWN IN MUNICIPAL LIMITS INDICATE FARM BUILDINGS FOR FARM USE)
- DWELLING OTHER THAN FARM
- ROWS OR GROUPS OF DWELLINGS CLOSELY SPACED (FIGURE DENOTES NUMBER OF DWELLINGS)
- SEASONAL OR SUMMER COLONY
- WELL
- HOTEL OR INN
- CHURCH
- CEMETERY
- CHURCH WITH CEMETERY ADJACENT
- HOSPITAL
- MILL
- TOLL HOUSE, STATE PORT OF ENTRY, OR WEIGHT STATION

**CITY AND VILLAGE CENTERS**

- COUNTY SEAT
- OTHER CITIES AND VILLAGES
- INCORPORATED CITY OR VILLAGE (GENERALIZED)

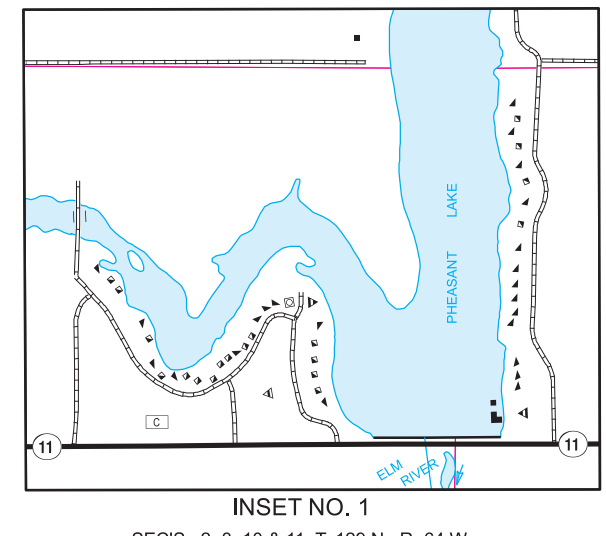

**GENERAL HIGHWAY MAP**  
**DICKEY COUNTY**  
**NORTH DAKOTA**

PREPARED BY THE  
NORTH DAKOTA DEPARTMENT OF TRANSPORTATION  
PLANNING / ASSET MANAGEMENT DIVISION

IN COOPERATION WITH THE  
U.S. DEPARTMENT OF TRANSPORTATION  
FEDERAL HIGHWAY ADMINISTRATION

SCALE  
0 1 2 3 4 Miles  
0 0.25 0.5 Miles  
0 1 2 3 4 Kilometers

2014

BASED ON AERIAL PHOTOGRAPHY OF 1957  
GROUND INVENTORY OF 2014  
AERIAL INVENTORY OF 2014

UNIVERSAL TRANSVERSE MERCATOR ZONE 14  
NORTH AMERICAN DATUM 83

SHEET 1 OF 1