

# 2007 FUNCTIONAL CLASSIFICATION

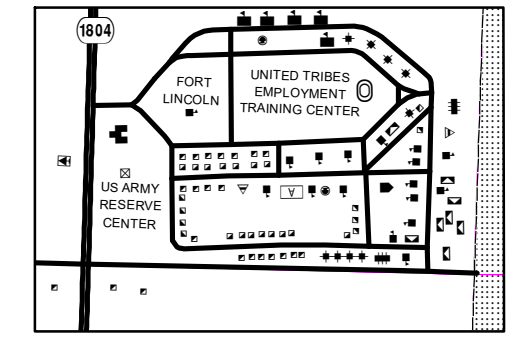
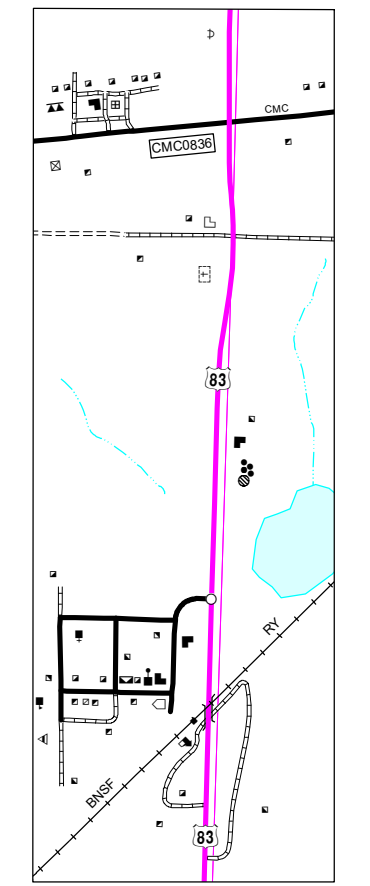
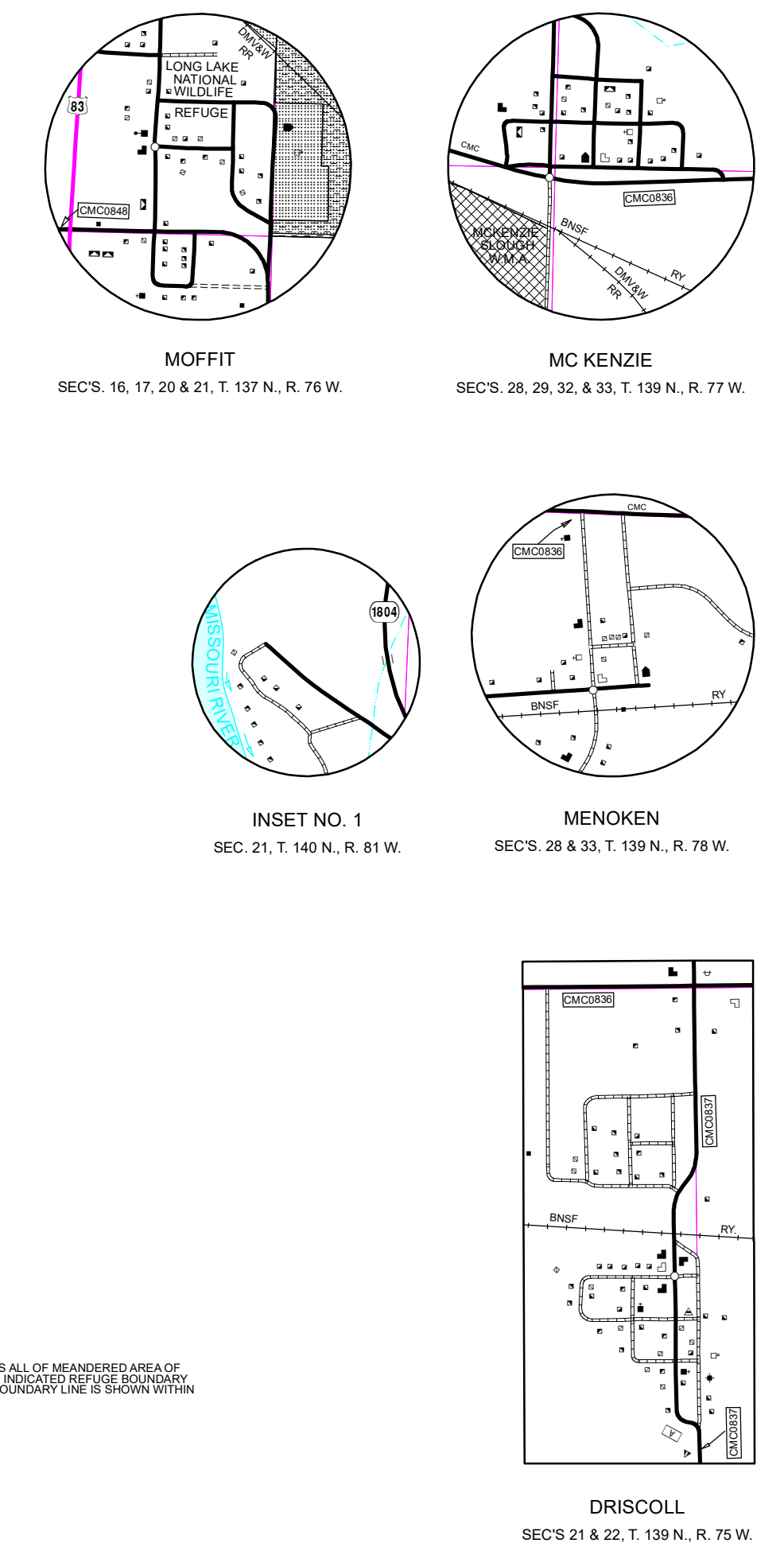
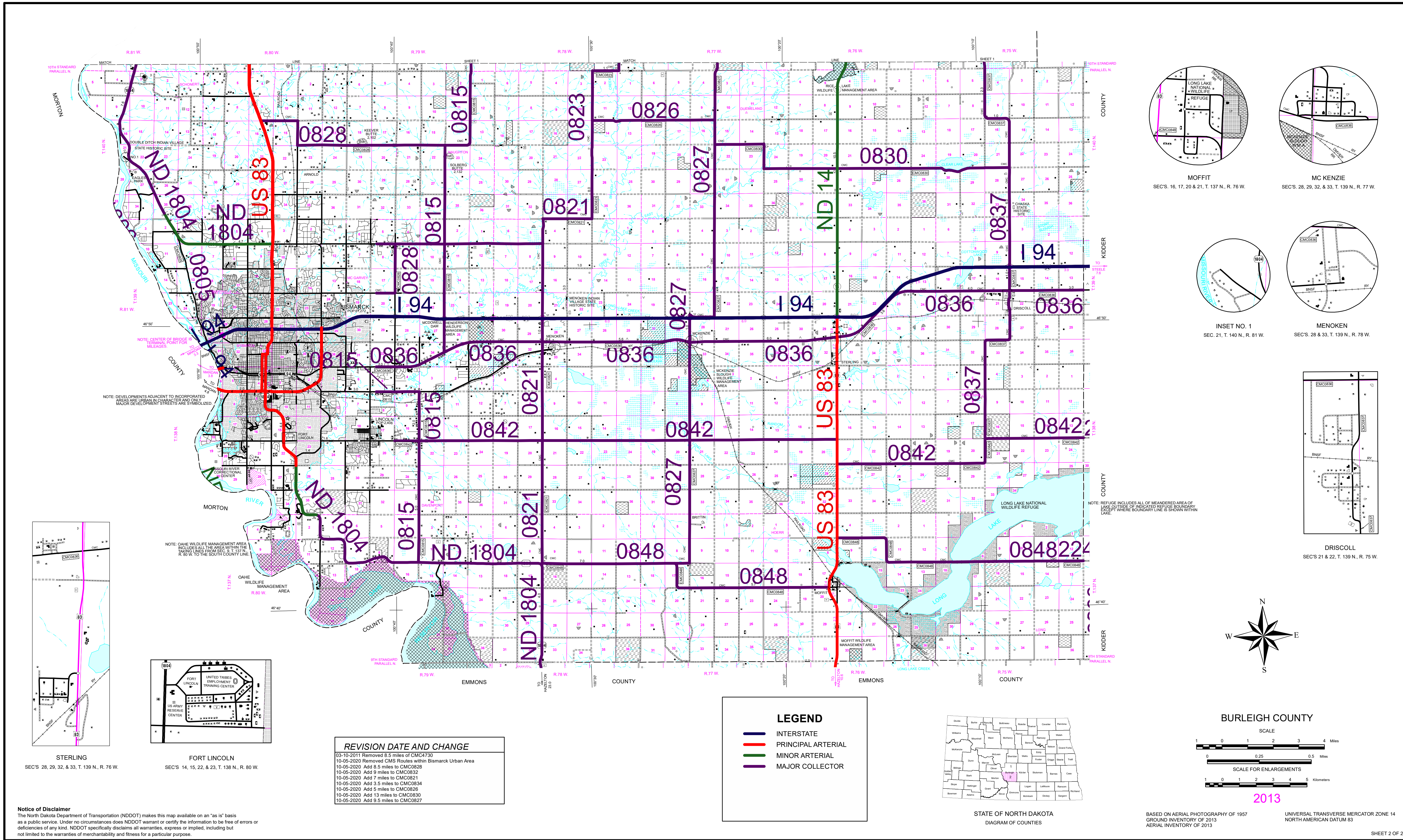

**REVISION DATE AND CHANGE**

03-10-2011	Removed 8.5 miles of CMC4730
10-05-2020	Removed CMS Routes within Bismarck Urban Area
10-05-2020	Add 8.5 miles to CMC0828
10-05-2020	Add 9 miles to CMC0832
10-05-2020	Add 7 miles to CMC0821
10-05-2020	Add 3.5 miles to CMC0834
10-05-2020	Add 5 miles to CMC0826
10-05-2020	Add 13 miles to CMC0830
10-05-2020	Add 9.5 miles to CMC0827

**LEGEND**

- INTERSTATE
- PRINCIPAL ARTERIAL
- MINOR ARTERIAL
- MAJOR COLLECTOR

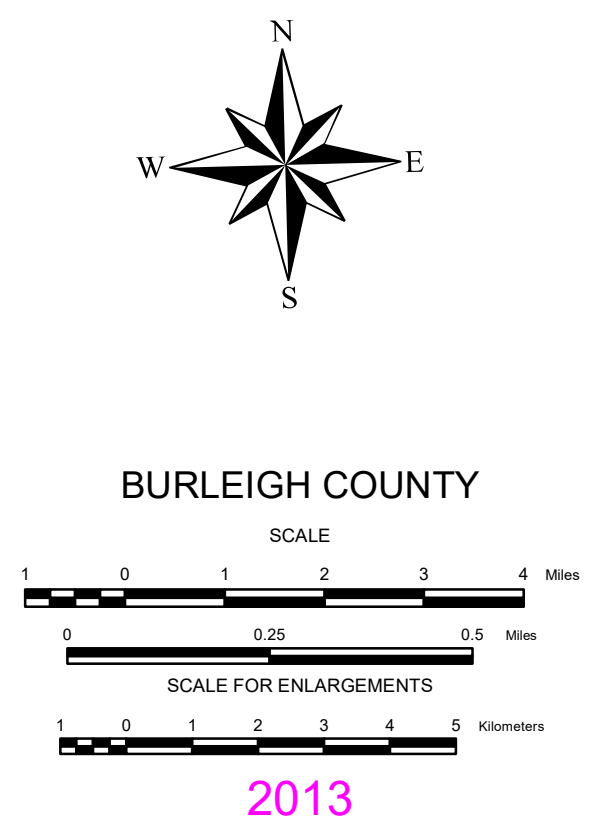

BASED ON AERIAL PHOTOGRAPHY OF 1957  
GROUND INVENTORY OF 2013  
AERIAL INVENTORY OF 2013

UNIVERSAL TRANSVERSE MERCATOR ZONE 14  
NORTH AMERICAN DATUM 83

**Notice of Disclaimer**  
The North Dakota Department of Transportation (NDDOT) makes this map available on an "as is" basis as a public service. Under no circumstances does NDDOT warrant or certify the information to be free of errors or deficiencies of any kind. NDDOT specifically disclaims all warranties, express or implied, including but not limited to the warranties of merchantability and fitness for a particular purpose.

COPIES OF THIS MAP ARE AVAILABLE FOR PUBLIC USE AT A NOMINAL COST FROM:  
MAP SALES, N.D. DEPT. OF TRANSPORTATION, 608 E. BLVD. AVE., BISMARCK, ND 58505-0700