

# 2007 FUNCTIONAL CLASSIFICATION

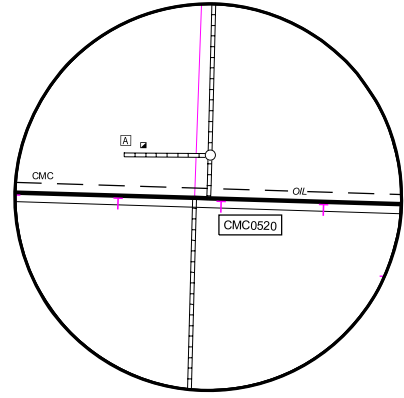

**DUNNING**  
SECS. 33 & 34, T. 161 N., R. 80 W.  
SECS. 5 & 6, T. 160 N., R. 80 W.

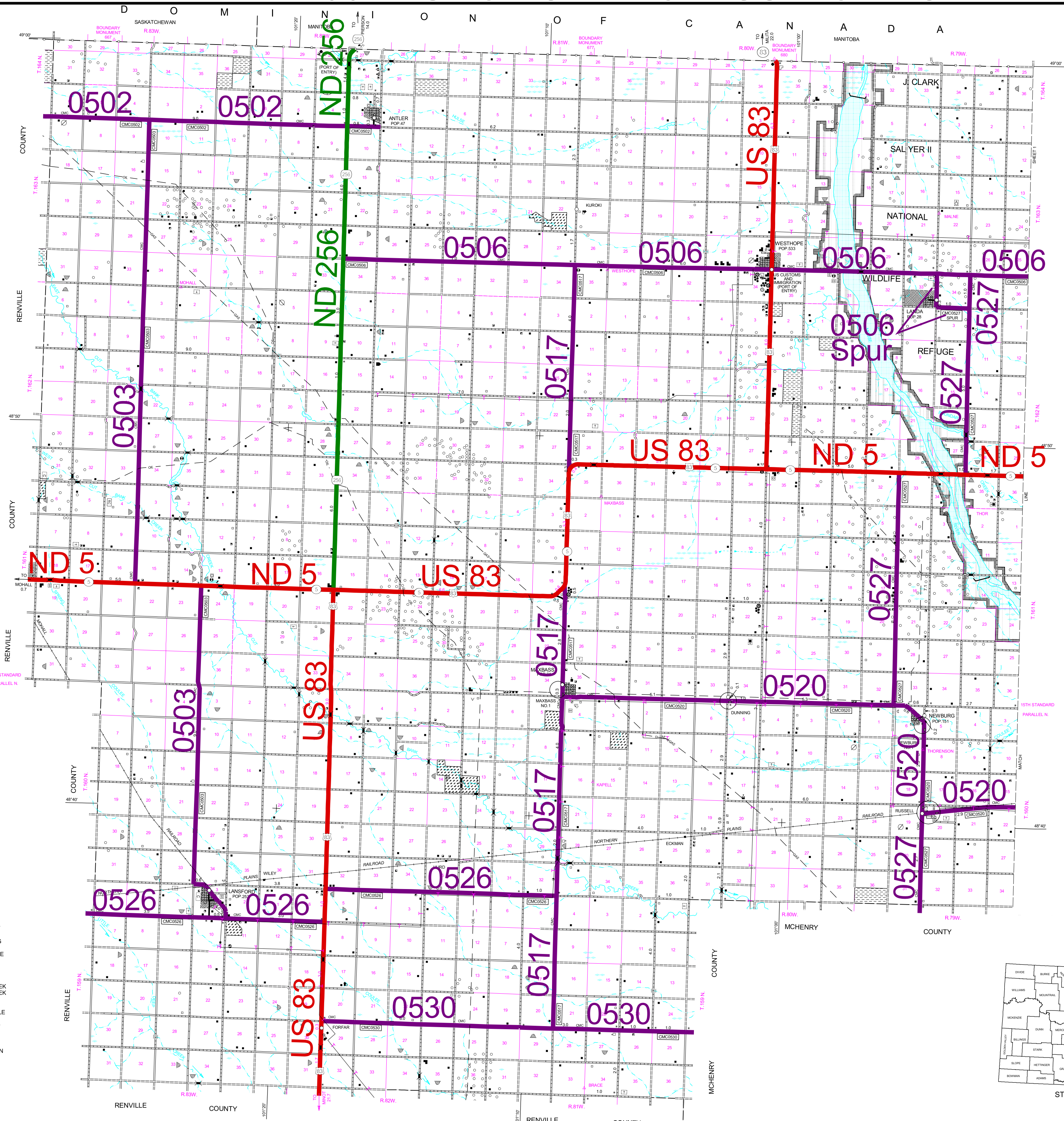
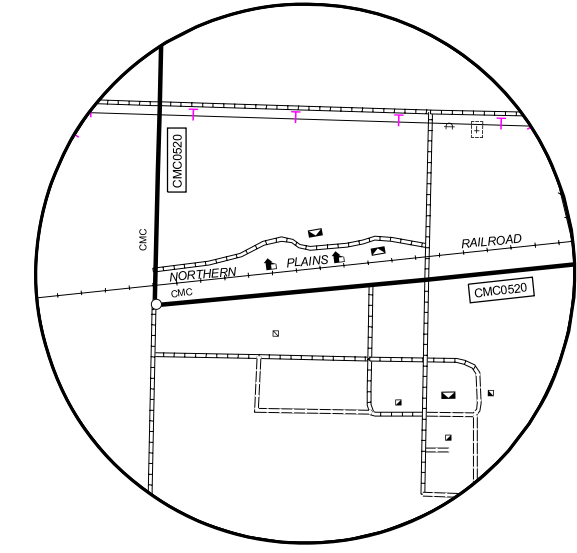

**RUSSELL**  
SECS. 17, 18, 19 & 20, T. 160 N., R. 79 W.

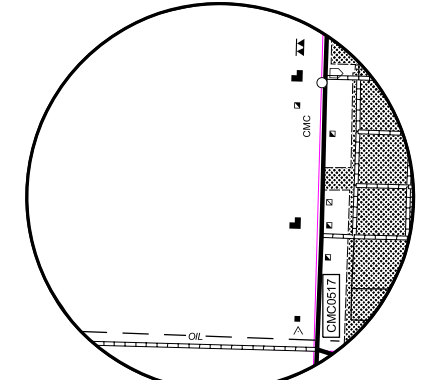

**MAXBASS NO. 1**  
SECS. 34 & 35, T. 161 N., R. 81 W.  
SECS. 4 & 5, T. 160 N., R. 81 W.

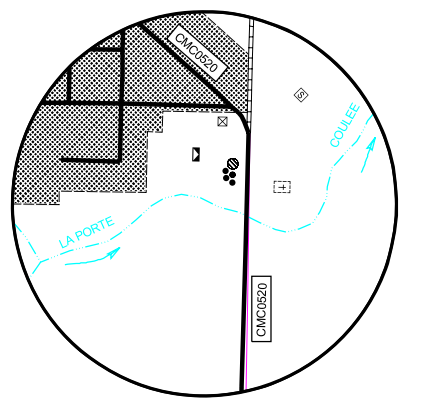

**NEWBURG NO. 1**  
SECS. 5 & 6, T. 160 N., R. 79 W.

NAME AND LOCATION OF ORGANIZED CIVIL TOWNSHIPS THOSE UNORGANIZED ARE SO NOTED

T. 164 N.-R. 83 W. WHEATON	T. 162 N.-R. 75 W. WHITTERON
T. 163 N.-R. 83 W. WHEATON	T. 162 N.-R. 74 W. CORDLIA
T. 164 N.-R. 82 W. ANTLER	T. 161 N.-R. 83 W. CUT BANK
T. 163 N.-R. 82 W. ANTLER	T. 161 N.-R. 82 W. RENVILLE
T. 164 N.-R. 81 W. WAYNE	T. 161 N.-R. 81 W. HASTINGS
T. 163 N.-R. 81 W. WAYNE	T. 161 N.-R. 80 W. BRANDER
T. 164 N.-R. 80 W. RICHBURG	T. 161 N.-R. 79 W. KANE
T. 163 N.-R. 80 W. RICHBURG	T. 161 N.-R. 78 W. KANE
T. 164 N.-R. 79 W. RICHBURG	T. 161 N.-R. 77 W. STARBUCK
T. 163 N.-R. 79 W. RICHBURG	T. 161 N.-R. 76 W. STARBUCK
T. 164 N.-R. 78 W. SCOTIA	T. 161 N.-R. 75 W. WHITBY
T. 163 N.-R. 78 W. SCOTIA	T. 161 N.-R. 74 W. OAK VALLEY
T. 164 N.-R. 77 W. SCANDIA	T. 161 N.-R. 73 W. AMITY
T. 163 N.-R. 77 W. SCANDIA	T. 160 N.-R. 83 W. BLAINE
T. 164 N.-R. 76 W. HARAM	T. 160 N.-R. 82 W. MOUNT ROSE
T. 163 N.-R. 76 W. HARAM	T. 160 N.-R. 81 W. LEWIS
T. 164 N.-R. 75 W. ROLAND	T. 160 N.-R. 80 W. NEWBORG
T. 163 N.-R. 75 W. ROLAND	T. 160 N.-R. 79 W. TACOMA
T. 164 N.-R. 74 W. HOMEN	T. 160 N.-R. 78 W. TACOMA
T. 163 N.-R. 74 W. HOMEN	T. 160 N.-R. 77 W. STONE CREEK
T. 164 N.-R. 73 W. HOFFMAN	T. 160 N.-R. 76 W. STONE CREEK
T. 163 N.-R. 73 W. HOFFMAN	T. 160 N.-R. 75 W. ELYSIAN
T. 164 N.-R. 72 W. SHERMAN	T. 160 N.-R. 74 W. OAK CREEK
T. 163 N.-R. 72 W. SHERMAN	T. 160 N.-R. 73 W. WILLOW VALE
T. 164 N.-R. 71 W. BENTONCK	T. 160 N.-R. 72 W. CECIL
T. 163 N.-R. 71 W. BENTONCK	T. 159 N.-R. 83 W. LANDSFORD
T. 164 N.-R. 70 W. SERGIUS	T. 159 N.-R. 82 W. ELMS
T. 163 N.-R. 70 W. SERGIUS	T. 159 N.-R. 81 W. CHATFIELD
T. 164 N.-R. 69 W. EDSVOLD	T. 159 N.-R. 75 W. OSTBY
T. 163 N.-R. 69 W. EDSVOLD	T. 159 N.-R. 74 W. WELLINGTON
T. 164 N.-R. 68 W. PICKERING	
T. 163 N.-R. 68 W. PICKERING	

## LEGEND

- PRINCIPAL ARTERIALS
- MINOR ARTERIALS
- MAJOR COLLECTORS

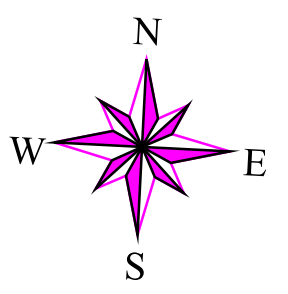

BOTTINEAU COUNTY

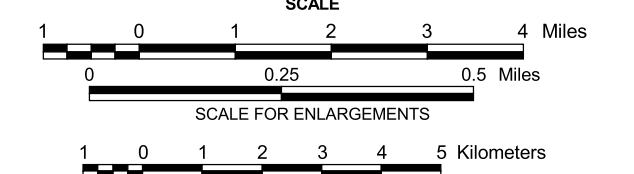

2003



STATE OF NORTH DAKOTA  
DIAGRAM OF COUNTIES

COPIES OF THIS MAP ARE AVAILABLE FOR PUBLIC USE AT A NOMINAL COST FROM:  
MAP SALES, N.D. DEPT. OF TRANSPORTATION, 608 E. BLVD. AVE., BISMARCK, N.D. 58505-0700

BASED ON AERIAL PHOTOGRAPHY OF 1953  
GROUND INVENTORY OF 2003  
AERIAL INVENTORY OF 2003  
UNIVERSAL TRANSVERSE MERCATOR ZONE 14  
NORTH AMERICAN DATUM 83  
SHEET 2 OF 2