

INSET NO. 5  
 SEC'S. 1, 12, 13, & 24, T. 153 N., R. 65 W.  
 SEC'S. 5, 6, 7, 8, 18, 19, 20 & 24 T. 153 N., R. 64 W.

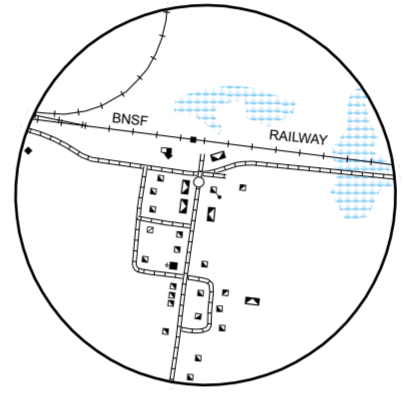

DOYON  
 SEC. 19, T. 153 N., R. 61 W.

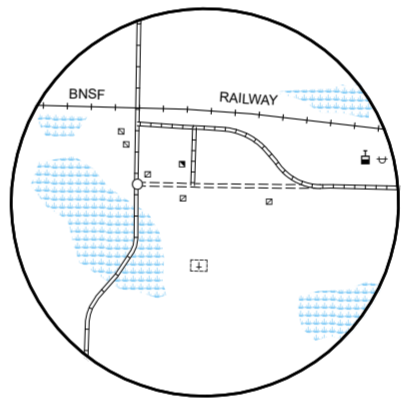

BARTLETT  
 SEC. 25, T. 153 N., R. 61 W.

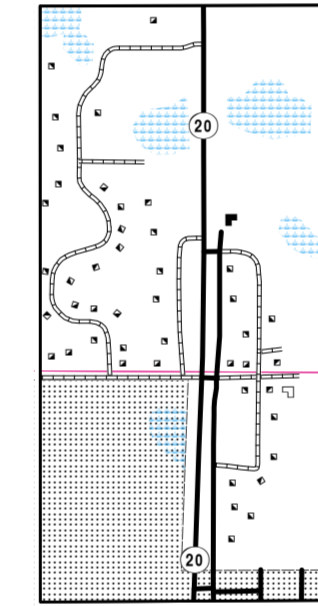

INSET NO. 1  
 SEC'S. 22 & 27, T. 154 N., R. 64 W.

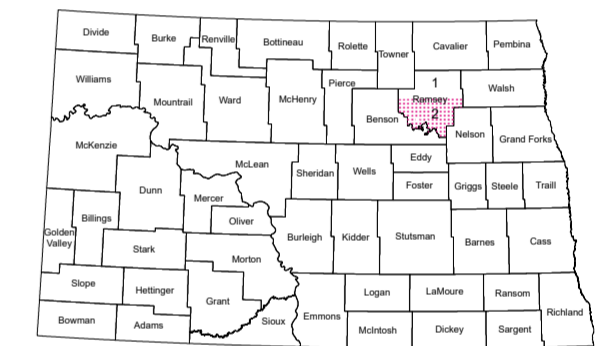

STATE OF NORTH DAKOTA  
 DIAGRAM OF COUNTIES

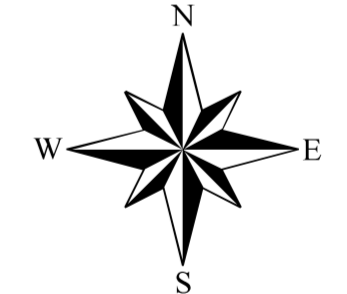

# GENERAL HIGHWAY MAP RAMSEY COUNTY NORTH DAKOTA

PREPARED BY THE  
 NORTH DAKOTA DEPARTMENT OF TRANSPORTATION  
 PLANNING AND ASSET MANAGEMENT DIVISION  
 IN COOPERATION WITH THE  
 U.S. DEPARTMENT OF TRANSPORTATION  
 FEDERAL HIGHWAY ADMINISTRATION

SCALE  
 1 0.5 0 1 2 3 4 Miles

SCALE FOR ENLARGEMENTS UNLESS OTHERWISE NOTED  
 0 0.25 0.5 Miles

1 0.5 0 1 2 3 4 Kilometers

2022

BASED ON AERIAL PHOTOGRAPHY OF 1954  
 AERIAL INVENTORY OF 2022  
 UNIVERSAL TRANSVERSE MERCATOR ZONE 14  
 NORTH AMERICAN DATUM 83

PENN  
 SEC'S. 25 & 26, T. 155 N., R. 66 W.

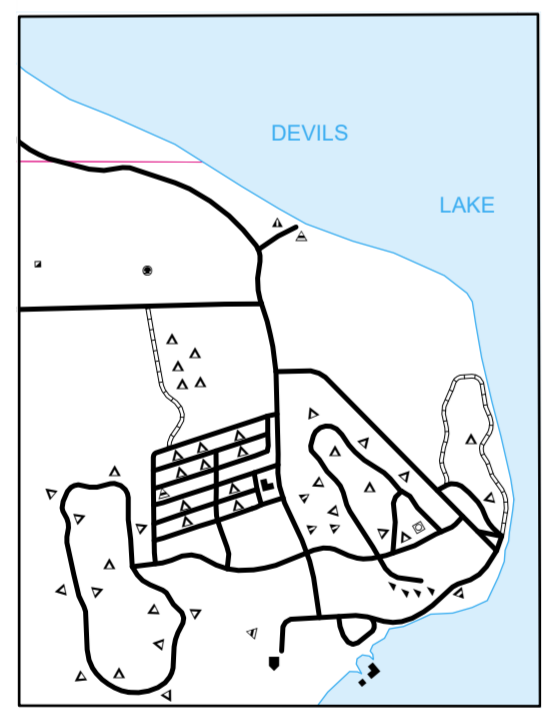

GRAHAMS ISLAND STATE PARK  
 SEC'S. 19, 20, 29, & 30, T. 153 N., R. 65 W.

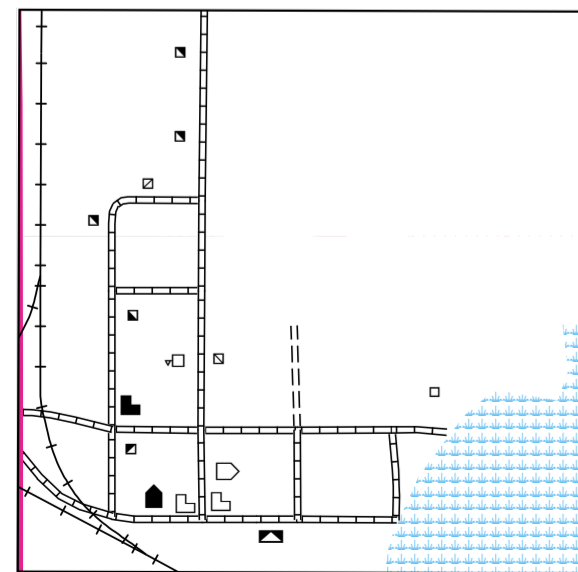

CHURCHS FERRY  
 SEC. 6, T. 155 N., R. 66 W.

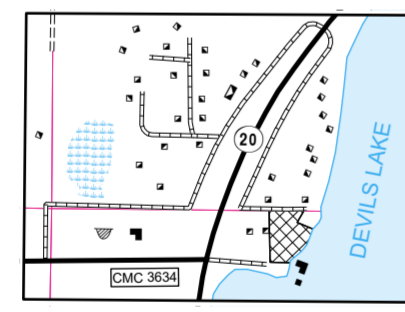

INSET NO. 3  
 SEC'S. 16, 17, 20, & 21, T. 153 N., R. 64 W.

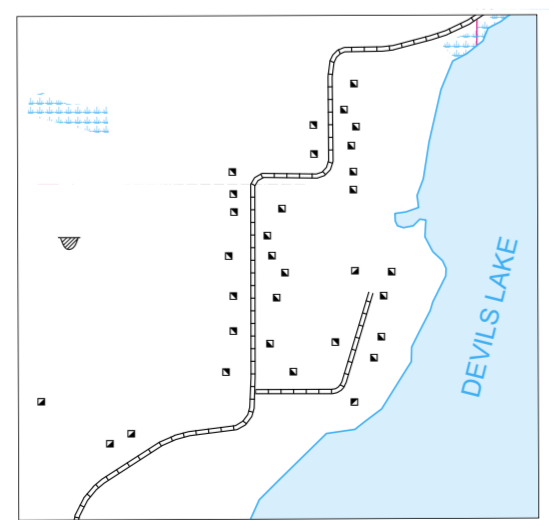

INSET NO. 4  
 SEC'S 27 & 28, T. 154 N., R. 65 W.

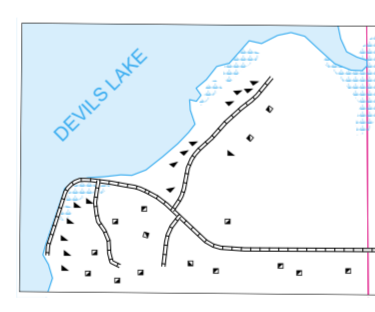

INSET NO. 6  
 SEC'S 26 & 27, T. 154 N., R. 65 W.

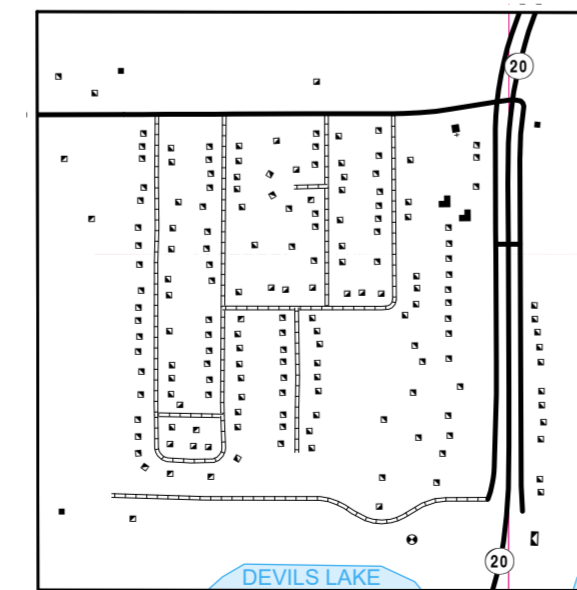

INSET NO. 2  
 SEC'S. 9 & 10, T. 153 N., R. 64 W.

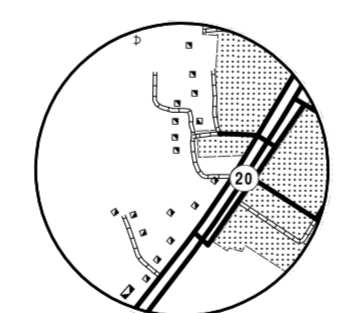

DEVILS LAKE NO. 1  
 SEC. 3, T. 153 N., R. 64 W.

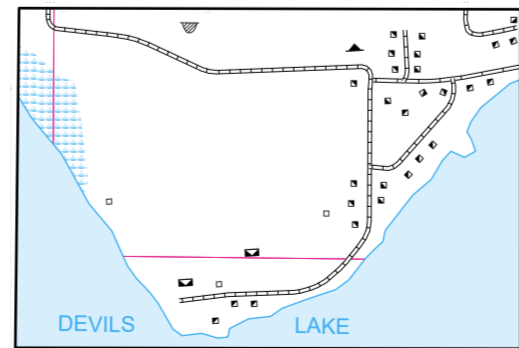

INSET NO. 7  
 SEC'S. 14 & 23, T. 153 N., R. 65 W.

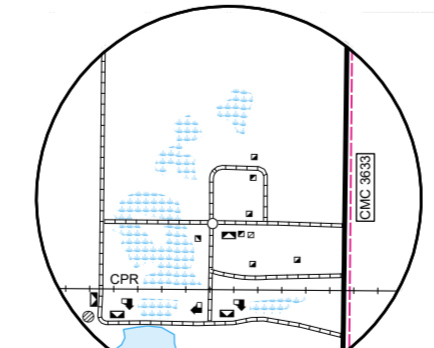

SOUTHAM  
 SEC. 13, T. 154 N., R. 62 W.  
 SEC. 18, T. 154 N., R. 61 W.

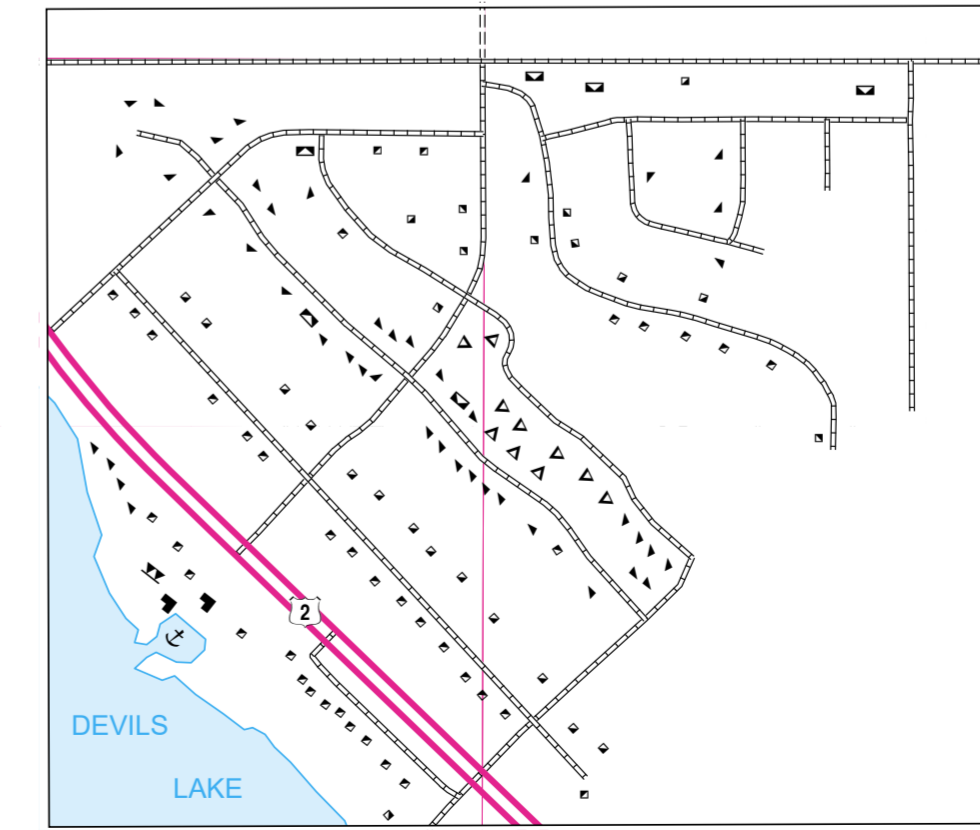

INSET NO. 8  
 SEC'S 7, 8, 17 & 18, T. 153 N., R. 63 W.

**Notice of Disclaimer**  
 The North Dakota Department of Transportation (NDDOT) makes this map available on an "as is" basis as a public service. Under no circumstances does NDDOT warrant or certify the information to be free of errors or deficiencies of any kind. NDDOT specifically disclaims all warranties, express or implied, including but not limited to the warranties of merchantability and fitness for a particular purpose.