

**GENERAL LEGEND**

- |  |   |
|--|---|
| <b>ROADS AND ROADWAY FEATURES</b>                                      | <b>FARM UNITS, DWELLINGS, ETC.</b>  |
| PRIMITIVE ROAD   | FARM UNIT (FARM UNITS SHOWN IN MUNICIPAL LIMITS INDICATE FARM BUILDINGS FOR FARM USE) |
| UNIMPROVED ROAD  | DWELLING OTHER THAN FARM  |
| GRADED AND DRAINED ROAD  | CEMETERY  |
| GRAVEL GRADED AND DRAINED ROAD   | CHURCH WITH CEMETERY ADJACENT   |
| PAVED ROAD   | HOSPITAL  |
| STREETS IN UNINCORPORATED AREAS  | WELL  |
| COUNTY MAJOR COLLECTOR   | TOLL HOUSE, STATE PORT OF ENTRY, OR WEIGHT STATION                                    |
| ROUTE NUMBER   | FIRST AID STATION OR HEALTH CENTER  |
| POINTS BETWEEN WHICH DISTANCES ARE MEASURED                            |   |
| U.S. NUMBERED HIGHWAY  |   |
| STATE HIGHWAY SYSTEM   |   |
|  | <b>CONSERVATION AND RECREATION</b>  |
| <b>STRUCTURES</b>  | PICNIC GROUND   |
| HIGHWAY BRIDGE, GENERAL  | PLAYGROUND, BALL FIELD, ETC.  |
| MINOR DRAINAGE STRUCTURE   | BATHING BEACH OR SWIMMING POOL  |
|  | SMALL PARK (SP-STATE, CP-COUNTY, MP-MUNICIPAL, WP-WAYSIDE PARK)                       |
| <b>BOUNDARIES</b>  | GOLF GROUND OR COUNTRY CLUB   |
| TOWNSHIP LINE  | FAIR GROUND, RACE COURSE, SLEDWAY   |
| CORPORATE LINE   | DRIVE-IN THEATER  |
| SECTION LINE   |   |
| BOUNDARY TO MARK ENLARGEMENT INSET                                     | <b>PUBLIC SERVICE FACILITIES</b>  |
| NATIONAL REFUGES   | HIGHWAY GARAGE  |
| WILDLIFE MANAGEMENT AREA   | GARBAGE OR RUBBISH DUMP   |
| WATERFOUL PRODUCTION AREA  | SEWAGE DISPOSAL PLANT   |
| STATE SCHOOL LAND  | AUTOMOBILE GRAVEYARD  |
| NATIONAL PARKS AND OTHER RESERVATIONS                                  | WATER SUPPLY STAND PIPE OR TANK   |
|  | POWER SUBSTATION  |
|  | COMMUNICATION TOWER   |
| <b>DRAINAGE</b>  |   |
| INTERMITTENT STREAM (NARROW)   | <b>INDUSTRIAL</b>   |
| NARROW STREAM  | STORE OR SMALL BUSINESS ESTABLISHMENT   |
| WIDE STREAM  | FACTORY OR INDUSTRIAL PLANT   |
| WIDE STREAM WITH DAM   | GROUP OF STORAGE TANKS (OIL OR GAS)   |
| LAKE, RESERVOIR, OR POND   | PUMPING STATION (OIL OR GAS)  |
| LAKE, RESERVOIR, OR POND WITH DAM                                      | Gauging or Pumping Station  |
| MARSH OR SWAMP LAND  | WAREHOUSE - GENERAL   |
| CANAL  | GRAIN ELEVATOR  |
|  | GRAVEL PIT  |
| <b>NAVIGATION</b>  |   |
| DOCK, PIER, OR LANDING   | <b>CITY AND VILLAGE CENTERS</b>   |
|  | COUNTY SEAT   |
| <b>RAILROADS</b>   | OTHER CITIES AND VILLAGES   |
| RAILROAD (ANY NUMBER OF TRACKS USED BY A SINGLE OPERATING CO.)         | INCORPORATED CITY OR VILLAGE (GENERALIZED)  |
| RAILROAD STATION   |   |
| RAILROAD GRADE CROSSING  | <b>EDUCATIONAL AND CORRECTIONAL INSTITUTIONS</b>                                      |
| RAILROAD ABOVE   | SCHOOLHOUSE   |
|  | TOWNHALL, GRANGE, OR COMMUNITY HALL   |
| <b>AIRPORTS</b>  |   |
| AIRPORT, COMPLETE FACILITIES   | <b>NATURAL FEATURES</b>   |
| LANDING AREA OR STRIP  | PROMINENT ELEVATION - WITH NAME   |
| AIRWAY LIGHT BEACON, GENERAL   |   |
|  |   |
| <b>MISCELLANEOUS</b>   |   |
| TRIANGULATION STATION  |   |
| DOT TO INDICATE LOCATION OF ANY CULTURAL FEATURE SHOWN OUT OF POSITION |   |
| ALL VACANT CULTURE INDICATED BY OPEN SYMBOL                            |   |
| LATITUDE AND LONGITUDE   |   |

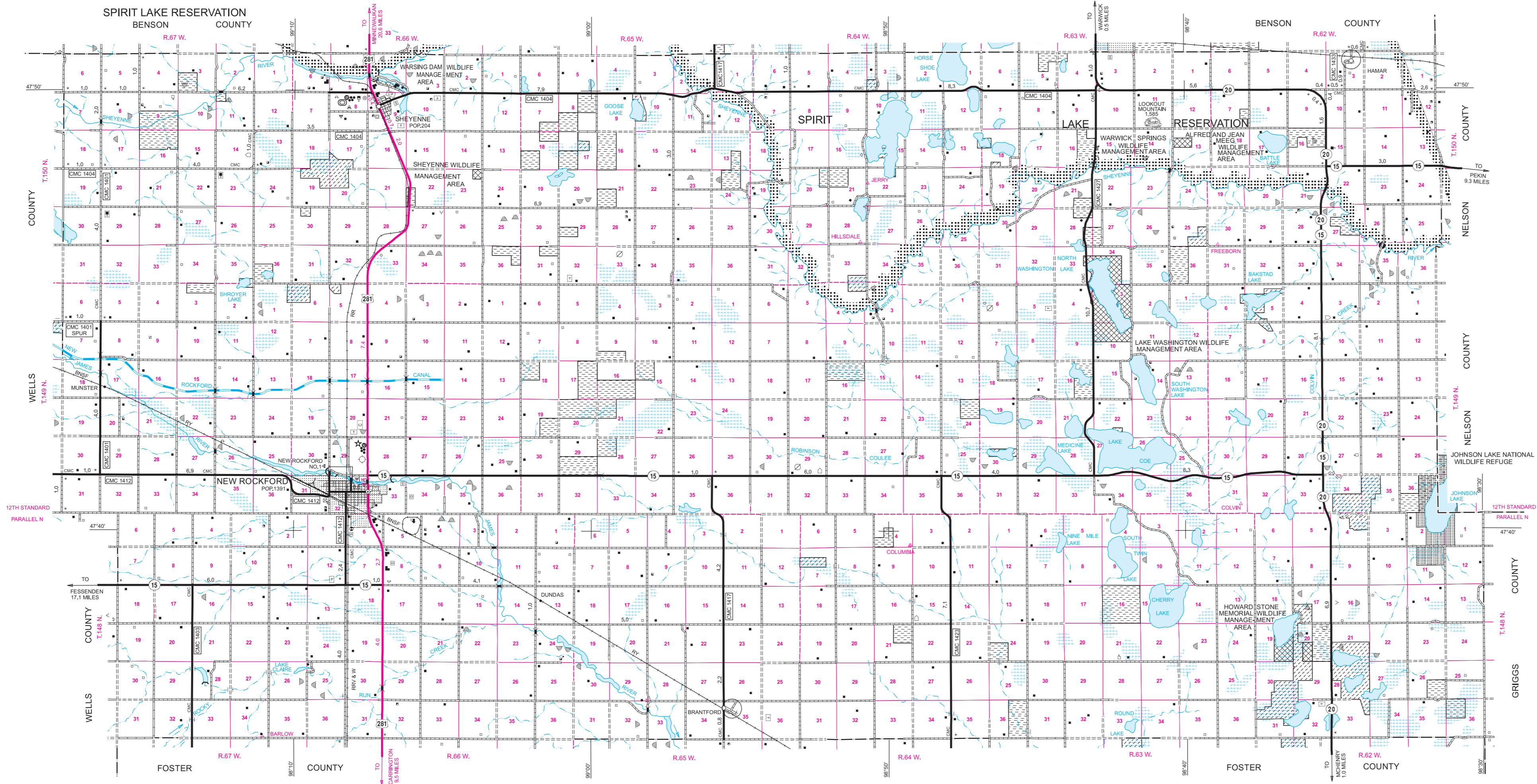
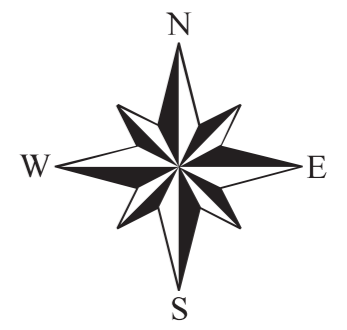

**NAME AND LOCATION OF ORGANIZED CIVIL TOWNSHIPS THOSE UNORGANIZED ARE SO NOTED**

- T. 150 N.-R. 67 W. GRANDFIELD
- T. 150 N.-R. 66 W. GATES
- T. 150 N.-R. 65 W. BUSH
- T. 150 N.-R. 64 W. HILLSDALE
- T. 150 N.-R. 63 W. EDDY
- T. 150 N.-R. 62 W. FREEBORN
- T. 149 N.-R. 67 W. MUNSTER
- T. 149 N.-R. 66 W. NEW ROCKFORD
- T. 149 N.-R. 65 W. SHELDON
- T. 149 N.-R. 64 W. TIFFANY
- T. 149 N.-R. 63 W. LAKE WASHINGTON
- T. 149 N.-R. 62 W. COLVIN
- T. 148 N.-R. 67 W. ROSEFIELD
- T. 148 N.-R. 66 W. SUPERIOR
- T. 148 N.-R. 65 W. PLEASANT PRAIRIE
- T. 148 N.-R. 64 W. COLUMBIA
- T. 148 N.-R. 63 W. CHERRY LAKE
- T. 148 N.-R. 62 W. PARADISE

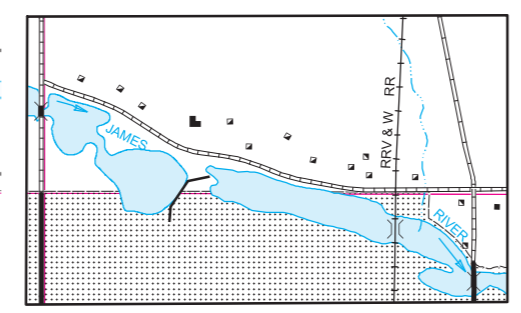

**NEW ROCKFORD NO. 1**  
SECS. 29, 30, 31, & 32 T. 149 N., R. 66 W.

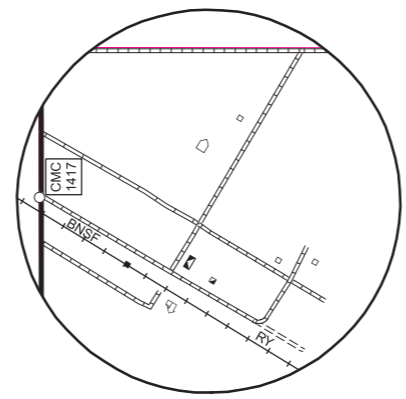

**BRANTFORD**  
SECS. 26, 34, & 35 T. 148 N., R. 65 W.

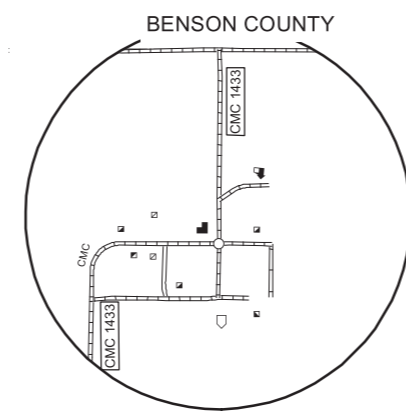

**HAMAR**  
SEC. 3, T. 150 N., R. 62 W.

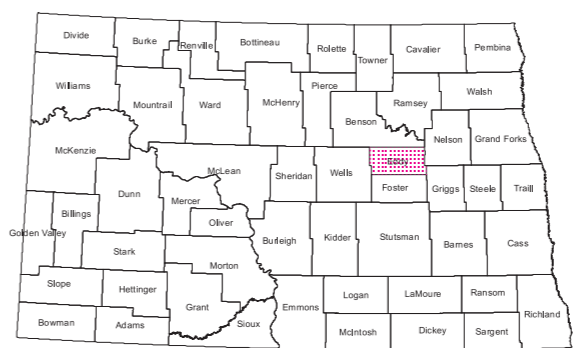

**STATE OF NORTH DAKOTA**  
DIAGRAM OF COUNTIES

**GENERAL HIGHWAY MAP**  
**EDDY COUNTY**  
**NORTH DAKOTA**

PREPARED BY THE  
NORTH DAKOTA DEPARTMENT OF TRANSPORTATION  
PLANNING / ASSET MANAGEMENT DIVISION  
IN COOPERATION WITH THE  
U.S. DEPARTMENT OF TRANSPORTATION  
FEDERAL HIGHWAY ADMINISTRATION

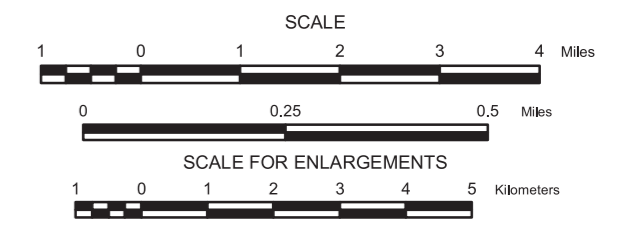

**2016**

BASED ON AERIAL PHOTOGRAPHY OF 1954 AERIAL INVENTORY OF 2016  
UNIVERSAL TRANSVERSE MERCATOR ZONE 14  
NORTH AMERICAN DATUM 83

**Notice of Disclaimer**  
The North Dakota Department of Transportation (NDDOT) makes this map available on an "as is" basis as a public service. Under no circumstances does NDDOT warrant or certify the information to be free of errors or deficiencies of any kind. NDDOT specifically disclaims all warranties, express or implied, including but not limited to the warranties of merchantability and fitness for a particular purpose.  
COPIES OF THIS MAP ARE AVAILABLE FOR PUBLIC USE AT A NOMINAL COST FROM:  
MAP SALES, ND DEPARTMENT OF TRANSPORTATION, 608 E. BLVD. AVE., BISMARCK, N.D. 58505-0700