

COLGAN  
SECS. 13 & 14, T. 163 N., R. 100 W.

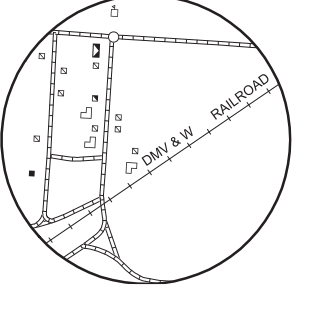

ALKABO  
SECS. 11 & 14, T. 162 N., R. 102 W.

**NAME AND LOCATION OF ORGANIZED CIVIL TOWNSHIPS THOSE UNORGANIZED ARE SO NOTED**

- |                                     |                                    |
|-------------------------------------|------------------------------------|
| T. 164 N.-R. 103 W. ELKHORN         | T. 162 N.-R. 98 W. TROY            |
| T. 163 N.-R. 103 W. ELKHORN         | T. 162 N.-R. 97 W. HAWKEYE         |
| T. 162 N.-R. 102 W. ELKHORN         | T. 162 N.-R. 96 W. BLOOMING VALLEY |
| T. 164 N.-R. 101 W. DE WITT         | T. 162 N.-R. 95 W. COALVILLE       |
| T. 163 N.-R. 101 W. DE WITT         | T. 161 N.-R. 103 W. DANVILLE       |
| T. 164 N.-R. 100 W. GOOSENECK       | T. 161 N.-R. 102 W. DANVILLE       |
| T. 163 N.-R. 100 W. GOOSENECK       | T. 161 N.-R. 101 W. WRITING ROCK   |
| T. 164 N.-R. 99 W. AMBROSE          | T. 161 N.-R. 100 W. ALEXANDRIA     |
| T. 163 N.-R. 99 W. AMBROSE          | T. 161 N.-R. 99 W. BUNKER          |
| T. 164 N.-R. 98 W. BLOOMING PRAIRIE | T. 161 N.-R. 98 W. PLUMER          |
| T. 163 N.-R. 98 W. BLOOMING PRAIRIE | T. 161 N.-R. 97 W. FRAZIER         |
| T. 164 N.-R. 97 W. FILLMORE         | T. 161 N.-R. 96 W. UPLAND          |
| T. 163 N.-R. 97 W. FILLMORE         | T. 161 N.-R. 95 W. BORDER          |
| T. 164 N.-R. 96 W. LONG CREEK       | T. 160 N.-R. 103 W. FERTILE VALLEY |
| T. 163 N.-R. 96 W. LONG CREEK       | T. 160 N.-R. 102 W. FERTILE VALLEY |
| T. 164 N.-R. 95 W. MENTOR           | T. 160 N.-R. 101 W. SIOUX TRAIL    |
| T. 163 N.-R. 95 W. MENTOR           | T. 160 N.-R. 100 W. SMOKEY BUTTE   |
| T. 164 N.-R. 94 W. MENTOR           | T. 160 N.-R. 99 W. GARNET          |
| T. 163 N.-R. 94 W. MENTOR           | T. 160 N.-R. 98 W. FREDERICK       |
| T. 164 N.-R. 93 W. WESTBY           | T. 160 N.-R. 97 W. PALMER          |
| T. 163 N.-R. 93 W. WESTBY           | T. 160 N.-R. 96 W. HAYLAND         |
| T. 162 N.-R. 101 W. CLINTON         | T. 160 N.-R. 95 W. STONE VIEW      |
| T. 162 N.-R. 100 W. LINCOLN VALLEY  |                                    |
| T. 162 N.-R. 99 W. TWIN BUTTE       |                                    |

**ROADS AND ROADWAY FEATURES**

- PRIMITIVE ROAD
- UNIMPROVED ROAD
- GRADED AND DRAINED ROAD
- GRAVEL GRADED AND DRAINED ROAD
- PAVED ROAD
- STREETS IN UNINCORPORATED AREAS
- INTERCHANGE
- INDIAN SERVICE ROAD
- COUNTY MAJOR COLLECTOR ROUTE NUMBER
- POINTS BETWEEN WHICH DISTANCES ARE MEASURED
- INTERSTATE NUMBERED HIGHWAY
- U.S. NUMBERED HIGHWAY
- STATE HIGHWAY SYSTEM
- PUBLIC SERVICE FACILITIES
- COMMUNICATION TOWER

**RAILROADS**

- RAILROAD (ANY NUMBER OF TRACKS USED BY A SINGLE OPERATING CO.)
- RAILROAD STATION
- RAILROAD GRADE CROSSING
- RAILROAD ABOVE
- RAILROAD BELOW
- RAILROAD BRIDGE
- BOUNDARIES
- MONUMENTED BOUNDARY MARKER
- NATIONAL BOUNDARY LINE
- STATE OR PROVINCE LINE
- COUNTY LINE
- TOWNSHIP LINE
- CORPORATE LINE
- SECTION LINE
- MONUMENT - SMALL, HISTORIC SITE
- WILDLIFE MANAGEMENT AREA
- STATE SCHOOL LAND
- NATIONAL GRASSLANDS

**GENERAL LEGEND**

- DRAINAGE
- INTERMITTENT STREAM (NARROW)
- NARROW STREAM
- WIDE STREAM
- WIDE STREAM WITH DAM
- LAKE, RESERVOIR, OR POND
- LAKE, RESERVOIR, OR POND WITH DAM
- MARSH OR SWAMP LAND
- STRUCTURES
- HIGHWAY BRIDGE, GENERAL
- DAM WITH ROAD
- MINOR DRAINAGE STRUCTURE
- CONCRETE FORD OR DIP
- FORD - ROAD ESTABLISHED
- CONSERVATION AND RECREATION
- BATHING BEACH OR SWIMMING POOL
- SCENIC SITE
- RIFLE CLUB

**CITY AND VILLAGE CENTERS**

- COUNTY SEAT
- OTHER CITIES AND VILLAGES
- INCORPORATED CITY OR VILLAGE (GENERALIZED)
- FARM UNITS, DWELLINGS, ETC.
- FARM UNIT (FARM UNITS SHOWN IN MUNICIPAL LIMITS INDICATE FARM BUILDINGS FOR FARM USE)
- DWELLING OTHER THAN FARM
- CHURCH
- CEMETERY
- EDUCATIONAL AND CORRECTIONAL INSTITUTIONS
- SCHOOLHOUSE
- AIRPORTS
- LANDING AREA OR STRIP

**INDUSTRIAL**

- STORE OR SMALL BUSINESS ESTABLISHMENT
- GAUGING OR PUMPING STATION
- GRAVEL PIT
- OIL OR GAS WELL
- MINE - SHAFT OR DRIFT (ANY KIND)
- MISCELLANEOUS
- TRIANGULATION STATION
- DOT TO INDICATE LOCATION OF ANY CULTURAL FEATURE
- SHOWN OUT OF POSITION
- ALL VACANT CULTURE INDICATED BY OPEN SYMBOL
- LATITUDE AND LONGITUDE

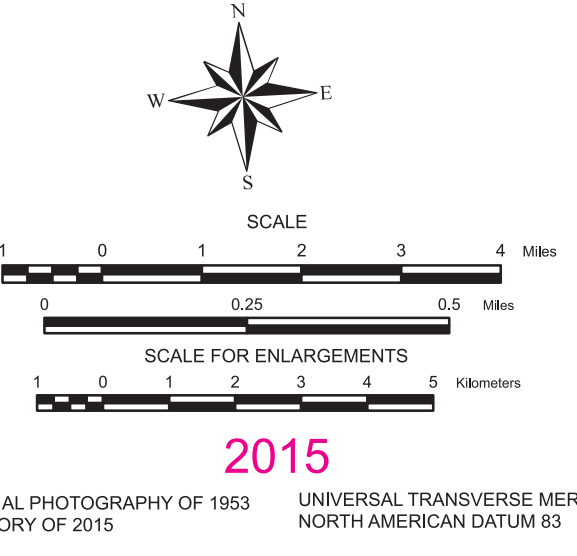

**GENERAL HIGHWAY MAP  
DIVIDE COUNTY  
NORTH DAKOTA**

PREPARED BY THE  
NORTH DAKOTA DEPARTMENT OF TRANSPORTATION  
PLANNING / ASSET MANAGEMENT DIVISION  
IN COOPERATION WITH THE  
U.S. DEPARTMENT OF TRANSPORTATION  
FEDERAL HIGHWAY ADMINISTRATION

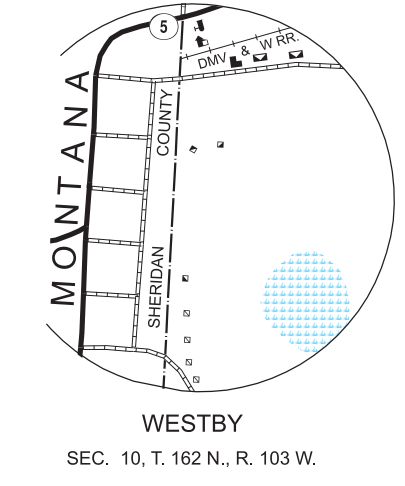

WESTBY  
SEC. 10, T. 162 N., R. 103 W.

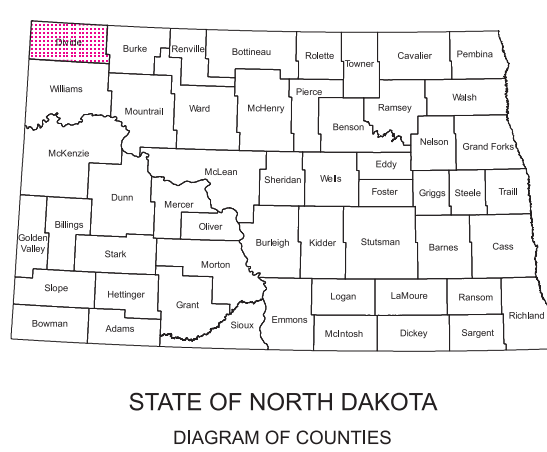

**Notice of Disclaimer**  
The North Dakota Department of Transportation (NDDOT) makes this map available on an "as is" basis as a public service. Under no circumstances does NDDOT warrant or certify the information to be free of errors or deficiencies of any kind. NDDOT specifically disclaims all warranties, express or implied, including but not limited to the warranties of merchantability and fitness for a particular purpose. COPIES OF THIS MAP ARE AVAILABLE FOR PUBLIC USE AT A NOMINAL COST FROM: MAP SALES, N.D. DEPT. OF TRANSPORTATION, 608 E. BLVD. AVE., BISMARCK, ND 58505-0700