

# 2007 FUNCTIONAL CLASSIFICATION

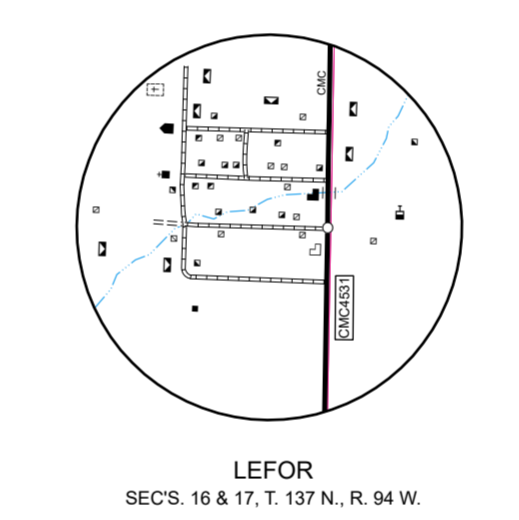
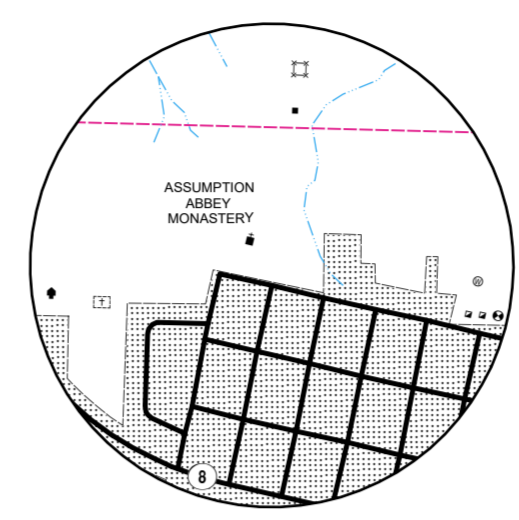
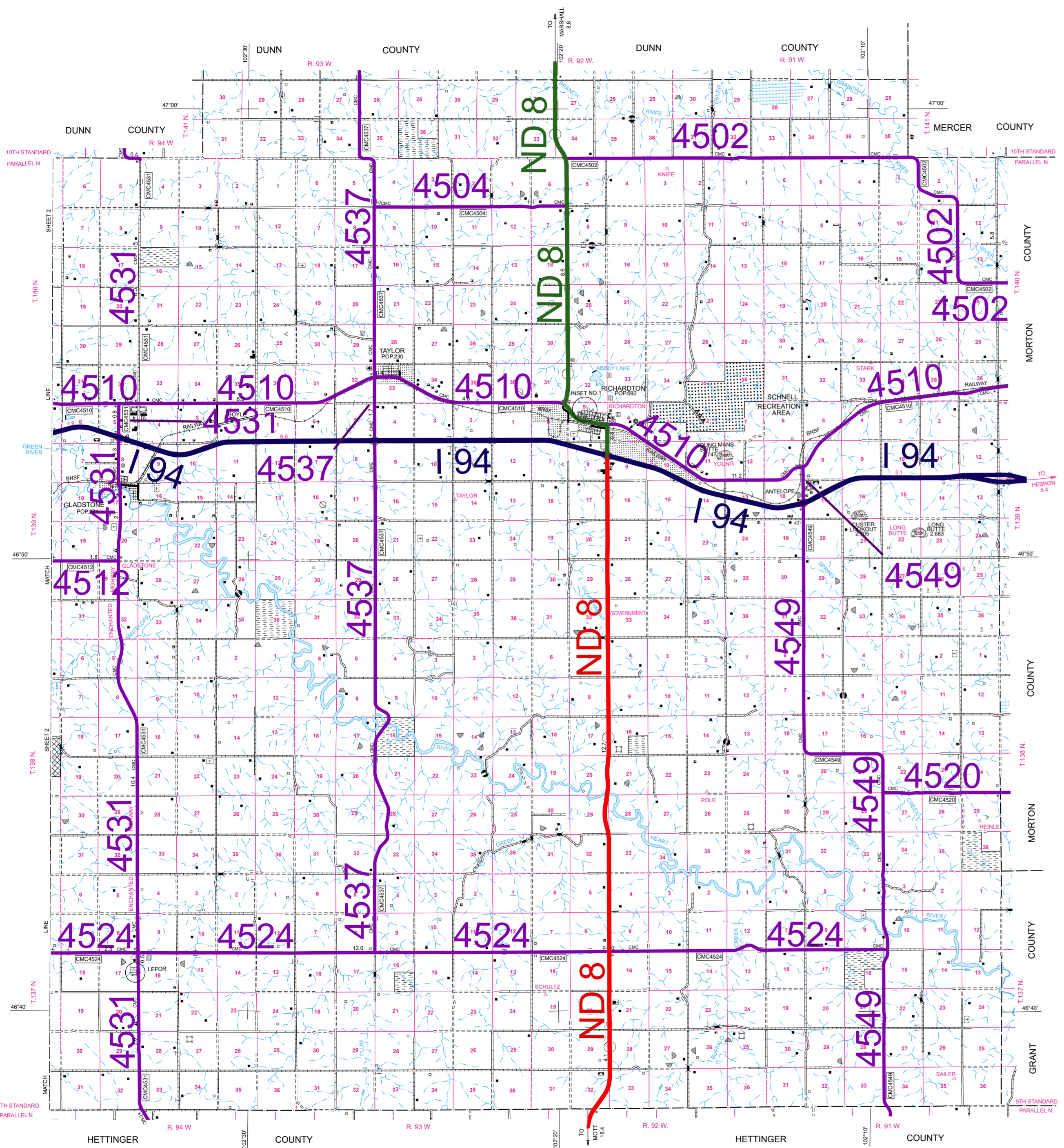

GENERAL LEGEND	
<b>ROADS AND ROADWAY FEATURES</b>	<b>INDUSTRIAL</b>
PRIMITIVE ROAD	STORE OR SMALL BUSINESS ESTABLISHMENT
UNIMPROVED ROAD	FACTORY OR INDUSTRIAL PLANT
GRAVEL GRADED AND DRAINED ROAD	OIL TANK
PAVED ROAD	GAS TANK
STREETS IN UNINCORPORATED AREAS	GROUP OF STORAGE TANKS (OIL OR GAS)
INTERCHANGE	FILLING STATION
COUNTY MAJOR COLLECTOR ROUTE NUMBER	PUMPING STATION (OIL OR GAS)
POINTS BETWEEN WHICH DISTANCES ARE MEASURED	Gauging or Pumping Station
INTERSTATE NUMBERED HIGHWAY	WAREHOUSE - GENERAL
U.S. NUMBERED HIGHWAY	GRAIN ELEVATOR
STATE HIGHWAY SYSTEM	STOCK YARD - LOADING PEN OR CORRAL
	MINE - SHAFT OR DRIFT (ANY KIND)
	NURSERY
	WIND TURBINE
<b>BOUNDARIES</b>	<b>STRUCTURES</b>
COUNTY LINE	4 LANE HIGHWAY BRIDGE
TOWNSHIP LINE	HIGHWAY BRIDGE, GENERAL
CORPORATE LINE	HIGHWAY GRADE SEPARATION
SECTION LINE	DAM WITH ROAD
MATCH LINE BETWEEN ADJOINING SHEETS OF SAME COUNTY	WILDLIFE MANAGEMENT STRUCTURE
BOUNDARY TO MARK ENLARGEMENT INSET	CONCRETE FORD OR DIP
NATIONAL REFUGES	FORD - ROAD ESTABLISHED
WILDLIFE MANAGEMENT AREA	
STATE SCHOOL LAND	
NATIONAL GRASSLANDS	
NATIONAL PARKS AND OTHER RESERVATIONS	
<b>DRAINAGE</b>	<b>AIRPORTS</b>
INTERMITTENT STREAM (NARROW)	AIRPORT, COMPLETE FACILITIES
NARROW STREAM	LANDING AREA OR STRIP
WIDE STREAM	AIRPORT, GENERAL
WIDE STREAM WITH DAM	
LAKE, RESERVOIR, OR POND	
WITH DAM	
MARSH OR SWAMP LAND	
DRAINAGE DITCH	
<b>RAILROADS</b>	<b>EDUCATIONAL AND CORRECTIONAL INSTITUTIONS</b>
RAILROAD (ANY NUMBER OF TRACKS USED BY A SINGLE OPERATING CO.)	SCHOOLHOUSE
RAILROAD STATION	TOWNHALL, GRANGE, OR COMMUNITY HALL
RAILROAD GRADE CROSSING	
RAILROAD ABOVE	
RAILROAD BELOW	
RAILROAD BRIDGE	<b>CITY AND VILLAGE CENTERS</b>
	COUNTY SEAT
	OTHER CITIES AND VILLAGES
	INCORPORATED CITY OR VILLAGE (GENERALIZED)
	<b>NATURAL FEATURES</b>
	PROMINENT ELEVATION - WITH NAME
	<b>FARM UNITS, DWELLINGS, ETC.</b>
	FARM UNIT (FARM UNITS SHOWN IN MUNICIPAL LIMITS INDICATE FARM BUILDINGS FOR FARM USE)
	DWELLINGS OTHER THAN FARM
	GROUPS OF DWELLINGS
	CLOSELY SPACED (FIGURE DENOTES NUMBER OF DWELLINGS)
	CHURCH
	CEMETERY
	CHURCH WITH CEMETERY ADJACENT
	FRESH AIR FARM OR REST HOME
	<b>CONSERVATION AND RECREATION</b>
	PICNIC GROUND
	PLAYGROUND, BALL FIELD, ETC.
	BATHING BEACH OR SWIMMING POOL
	CAMP SITE, NO PERMANENCE
	(TENTS OR TRAILER PARKING)
	TOURIST COURT OR MOTEL
	CAMP OR LODGE
	(PERMANENT SITE WITH BUILDINGS)
	GOLF GROUND OR COUNTRY CLUB
	FAIR GROUND, RACE COURSE, SPEEDWAY
	RIFLE CLUB
	<b>PUBLIC SERVICE FACILITIES</b>
	HIGHWAY GARAGE
	FIRE ENGINE HOUSE
	GARBAGE OR RUBBISH DUMP
	SEWAGE DISPOSAL PLANT
	AUTOMOBILE GRAVEYARD
	WATER SUPPLY STAND PIPE OR TANK
	RADIO RANGE STATION
	POWER SUBSTATION
	BROADCASTING TOWER (RADIO OR TV)
	COMMUNICATION TOWER
	MUNICIPAL BUILDING
	<b>MISCELLANEOUS</b>
	TRIANGULATION STATION
	DOT TO INDICATE LOCATION OF ANY CULTURAL FEATURE
	SHOWN OUT OF POSITION
	ALL VACANT CULTURE INDICATED BY OPEN SYMBOL
	LATITUDE AND LONGITUDE

**FUNCTIONAL CLASSIFICATION**

- INTERSTATE
- PRINCIPAL ARTERIAL
- MINOR ARTERIAL
- MAJOR COLLECTOR

REVISION DATE AND CHANGE

03-10-2011 Removed 8.5 miles of CMC4730

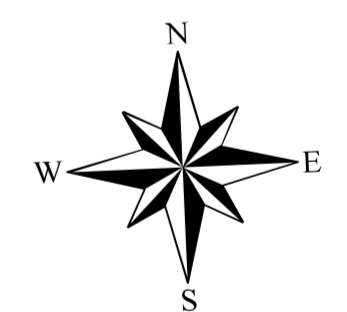

## GENERAL HIGHWAY MAP STARK COUNTY NORTH DAKOTA

PREPARED BY THE  
NORTH DAKOTA DEPARTMENT OF TRANSPORTATION  
PLANNING AND ASSET MANAGEMENT DIVISION

IN COOPERATION WITH THE  
U.S. DEPARTMENT OF TRANSPORTATION  
FEDERAL HIGHWAY ADMINISTRATION

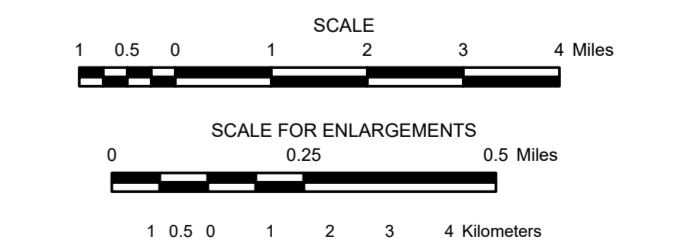

2020

BASED ON AERIAL PHOTOGRAPHY OF 1993  
AERIAL INVENTORY OF 2020

UNIVERSAL TRANSVERSE MERCATOR ZONE 14  
NORTH AMERICAN DATUM 83

**Notice of Disclaimer**  
The North Dakota Department of Transportation (NDOT) makes this map available on an "as is" basis as a public service. Under no circumstances does NDOT warrant or certify the information to be free of errors or deficiencies of any kind. NDOT specifically disclaims all warranties, express or implied, including but not limited to the warranties of merchantability and fitness for a particular purpose.