

2007 FUNCTIONAL CLASSIFICATION

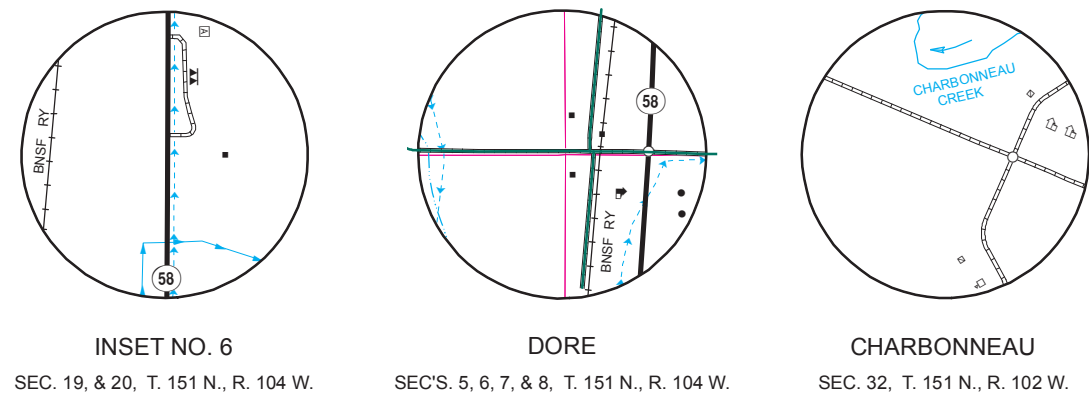

Notice of Disclaimer
The North Dakota Department of Transportation (NDDOT) makes this map available on an "as is" basis as a public service. Under no circumstances does NDDOT warrant or certify the information to be free of errors or deficiencies of any kind. NDDOT specifically disclaims all warranties, express or implied, including but not limited to the warranties of merchantability and fitness for a particular purpose.

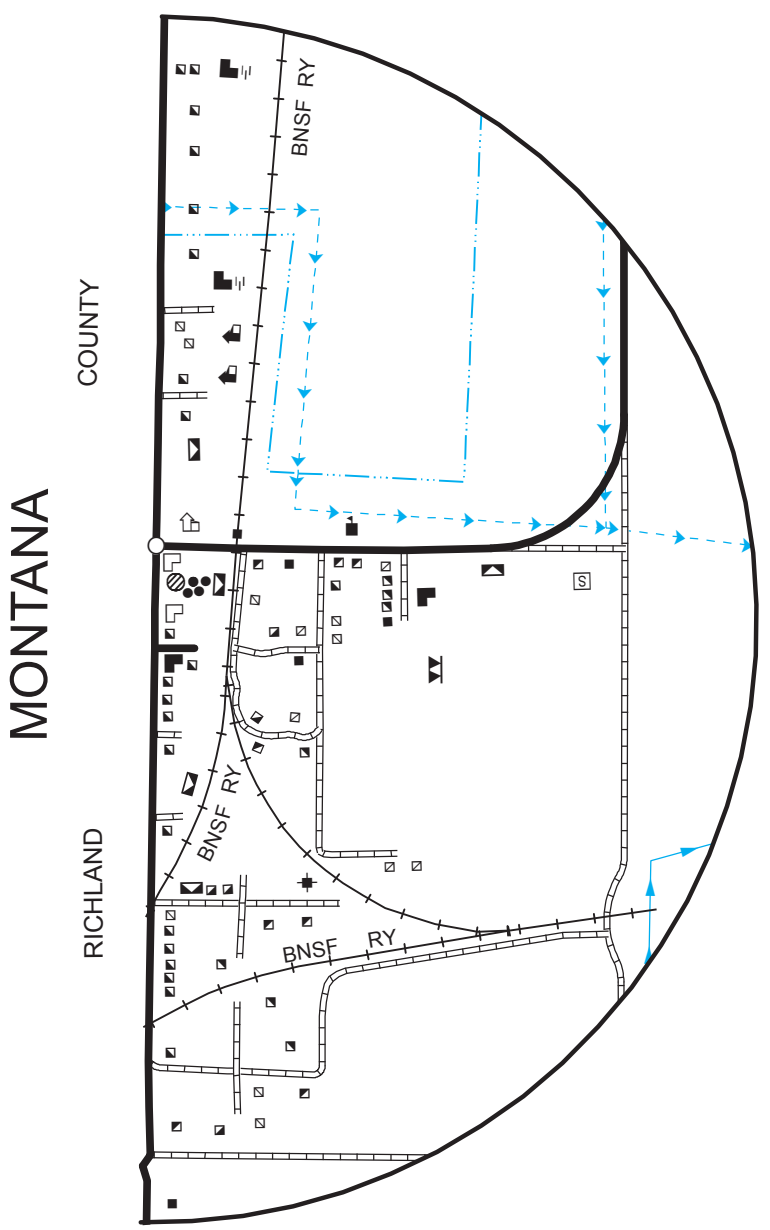
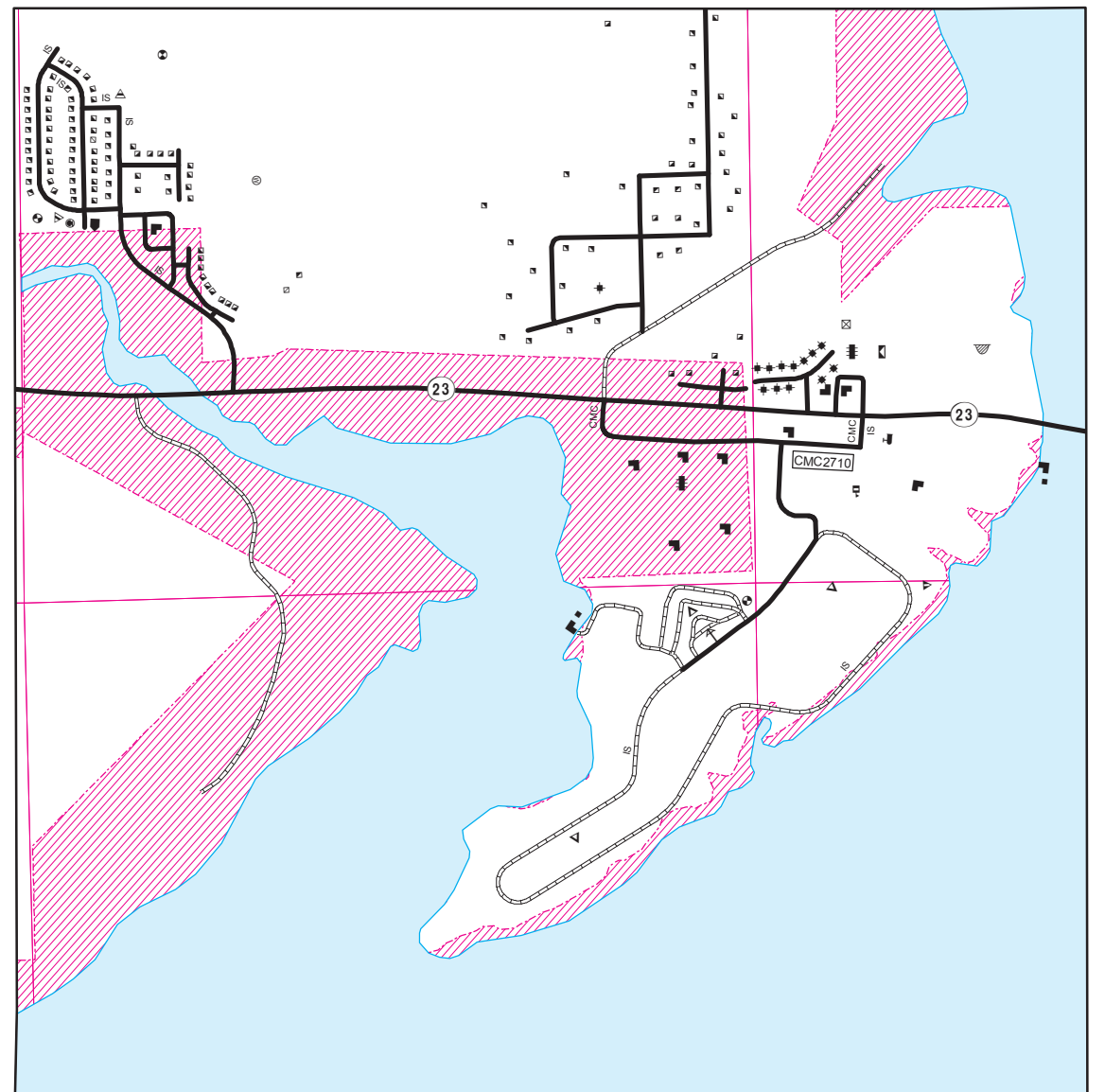
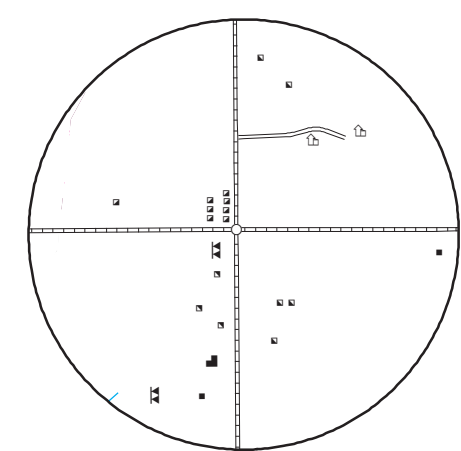
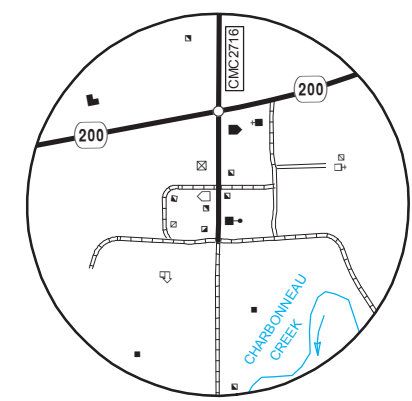

LEGEND

- PRINCIPAL ARTERIAL
- MINOR ARTERIAL
- MAJOR COLLECTOR
- PROPOSED MAJOR COLLECTOR
- INDIAN SERVICE ROAD (IS)
- FOREST SERVICE
- DUAL ROUTES

REVISION DATE AND CHANGE

- 05-16-2014 Addition of 23.5 miles to CMC2710
- 05-16-2014 Addition of 2.3 miles to a planned route CMC2710
- 09-15-2015 Addition of 5.0 miles to CMC2717
- 09-15-2015 Addition of 6.4 miles to CMC2713
- 09-15-2015 Addition of 14.1 miles to CMC2726
- 09-15-2015 Addition of 5.0 miles to CMC2731
- 05-31-2017 Reroute 4 miles of CMC2726

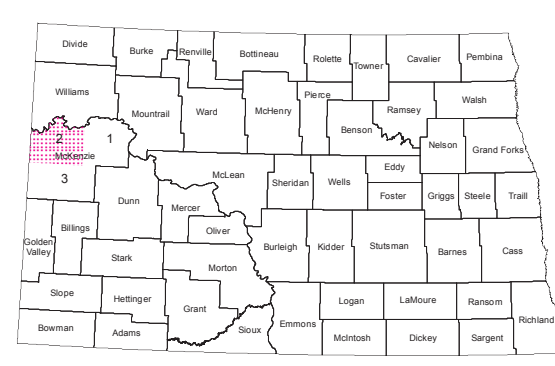
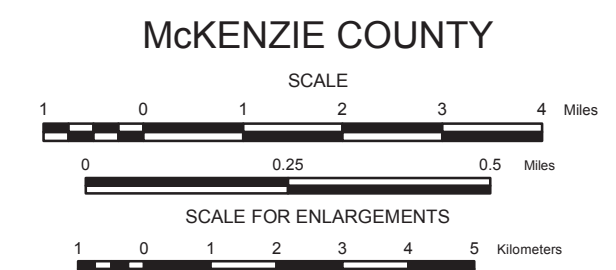
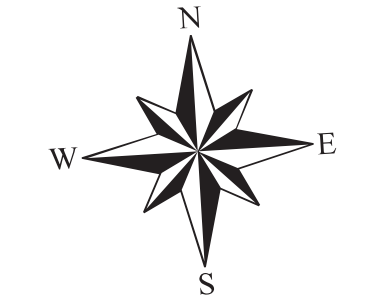

BASED ON AERIAL PHOTOGRAPHY OF 1958
GROUND INVENTORY OF 2013
AERIAL INVENTORY OF 2013

UNIVERSAL TRANSVERSE MERCATOR ZONE 14
NORTH AMERICAN DATUM 83

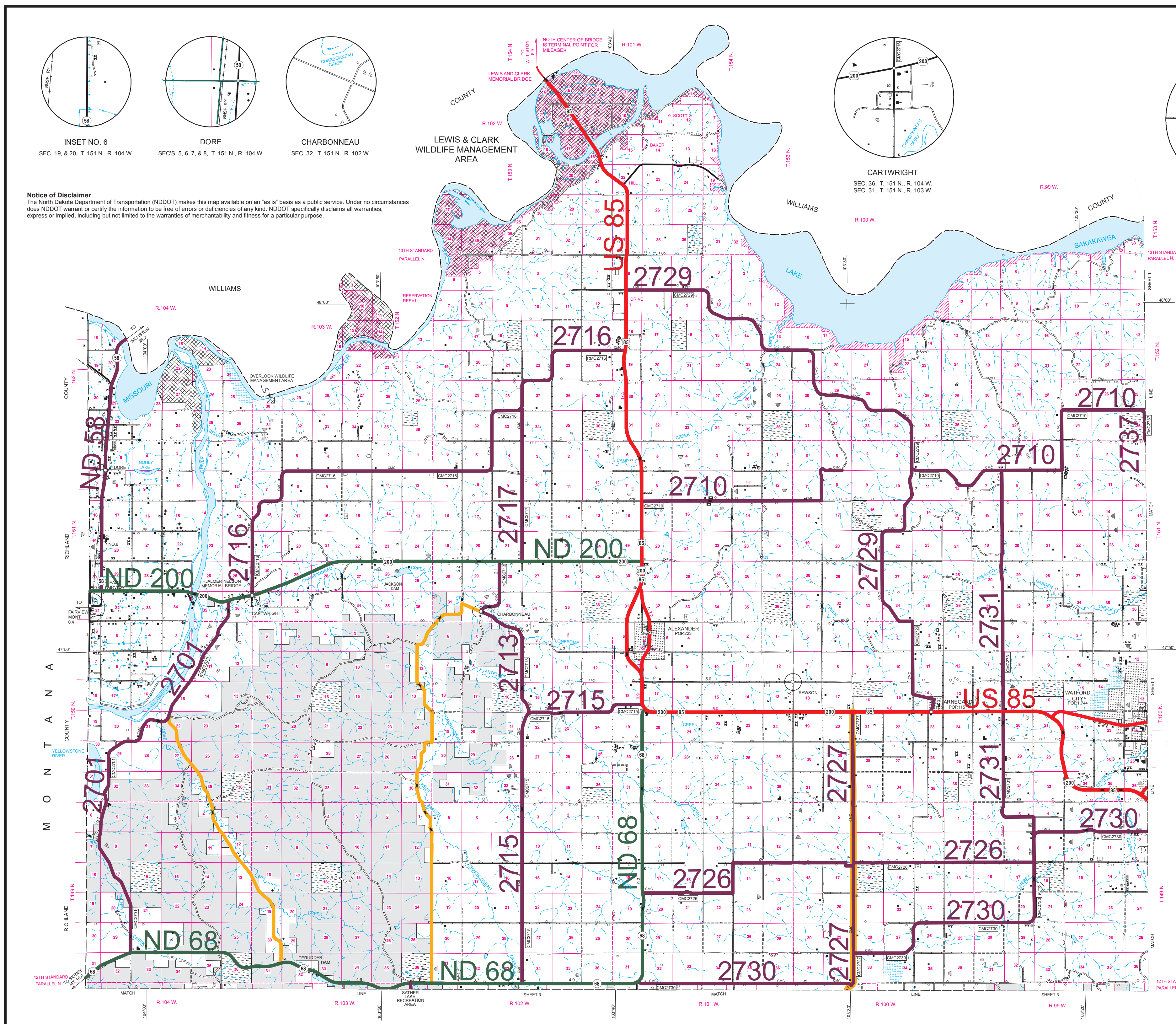

COPIES OF THIS MAP ARE AVAILABLE FOR PUBLIC USE AT A NOMINAL COST FROM:
MAP SALES, N.D. DEPT. OF TRANSPORTATION, 608 E. BLVD. AVE., BISMARCK, N.D. 58505-0700