

2007 FUNCTIONAL CLASSIFICATION

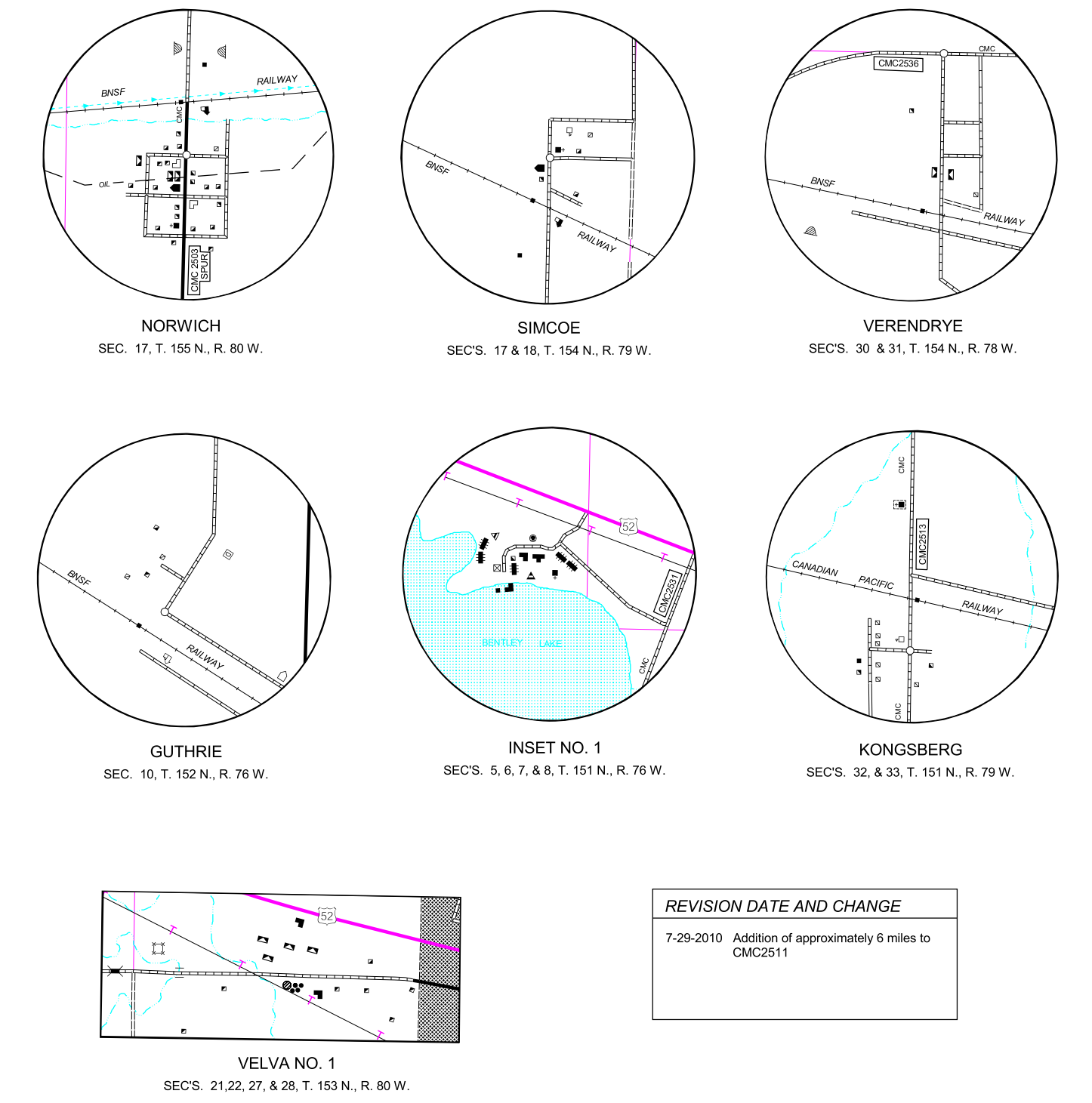
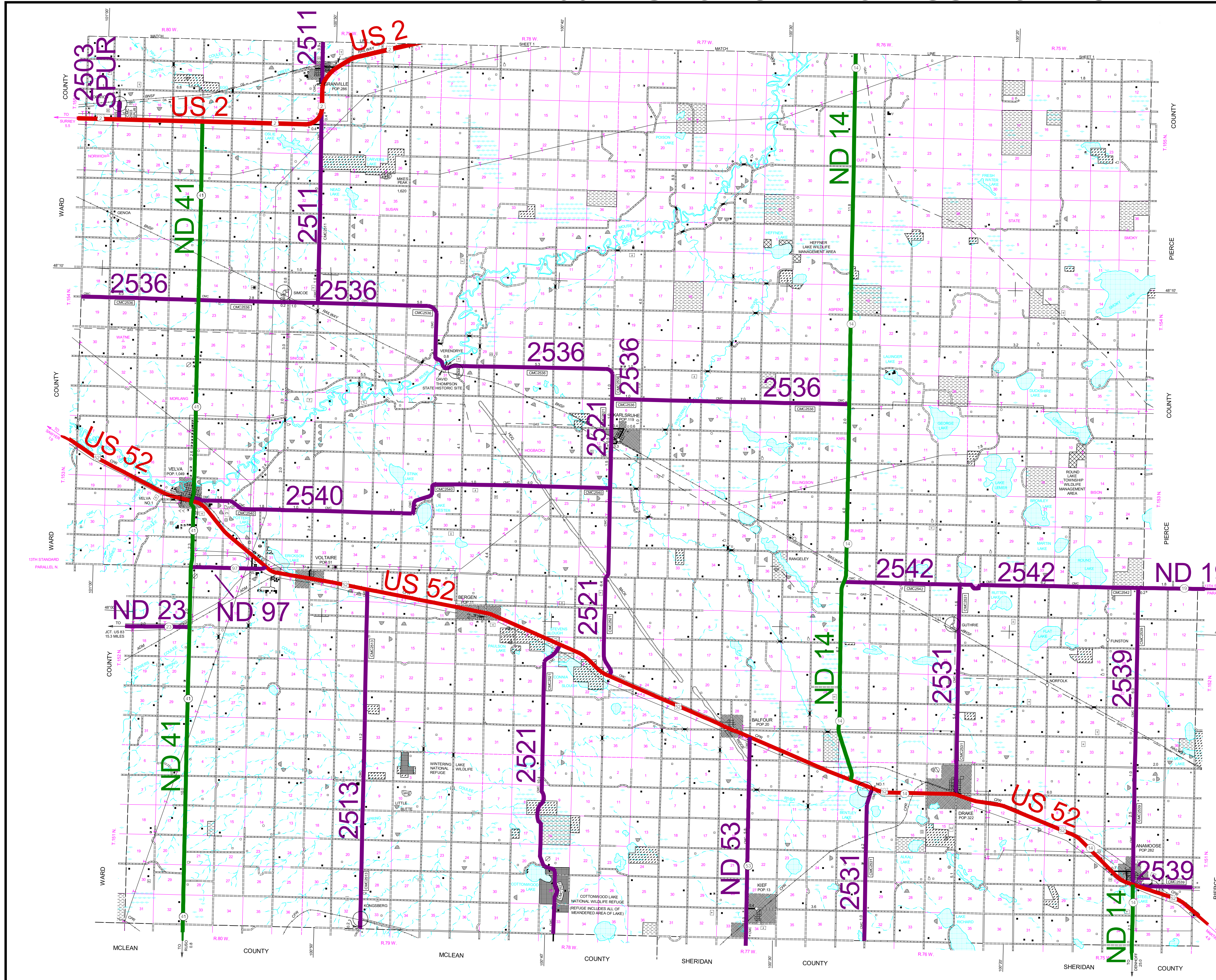

REVISION DATE AND CHANGE
 7-29-2010 Addition of approximately 6 miles to CMC2511

LEGEND

- PRINCIPAL ARTERIALS
- MINOR ARTERIALS
- MAJOR COLLECTORS

NAME AND LOCATION OF ORGANIZED CIVIL TOWNSHIPS THOSE UNORGANIZED ARE SO NOTED

- T. 159 N.-R. 80 W. PRATT
- T. 159 N.-R. 78 W. DEEP RIVER
- T. 159 N.-R. 78 W. MEADOW
- T. 159 N.-R. 77 W. MOUSE RIVER
- T. 159 N.-R. 76 W. WILLOW CREEK
- T. 158 N.-R. 80 W. GRILLEY
- T. 158 N.-R. 79 W. LITTLE DEEP
- T. 158 N.-R. 78 W. LAYTON
- T. 158 N.-R. 77 W. SANTRY
- T. 158 N.-R. 76 W. UNORGANIZED
- T. 158 N.-R. 75 W. NORMAL
- T. 157 N.-R. 80 W. DEERING
- T. 157 N.-R. 79 W. SALINE
- T. 157 N.-R. 78 W. GILMORE
- T. 157 N.-R. 77 W. WAGAR
- T. 157 N.-R. 76 W. UNORGANIZED
- T. 157 N.-R. 75 W. UNORGANIZED
- T. 156 N.-R. 80 W. KOTTKE VALLEY
- T. 156 N.-R. 79 W. EGG CREEK
- T. 156 N.-R. 78 W. RIGA
- T. 156 N.-R. 77 W. DENBIGH
- T. 156 N.-R. 76 W. NEWPORT
- T. 156 N.-R. 75 W. BERWICK
- T. 155 N.-R. 80 W. NORWICH
- T. 155 N.-R. 79 W. GRANVILLE
- T. 155 N.-R. 78 W. ROSE HILL
- T. 155 N.-R. 77 W. UNORGANIZED
- T. 155 N.-R. 76 W. UNORGANIZED
- T. 155 N.-R. 75 W. UNORGANIZED
- T. 154 N.-R. 80 W. NORTH PRAIRIE
- T. 154 N.-R. 79 W. HENDRICKSON
- T. 154 N.-R. 78 W. FALSIN
- T. 154 N.-R. 77 W. VILLARD
- T. 154 N.-R. 76 W. UNORGANIZED
- T. 154 N.-R. 75 W. UNORGANIZED
- T. 153 N.-R. 80 W. VELVA
- T. 153 N.-R. 79 W. LESBANO
- T. 153 N.-R. 78 W. LAKE HESTER
- T. 153 N.-R. 77 W. KARLSRUHE
- T. 153 N.-R. 76 W. LAKE GEORGE
- T. 153 N.-R. 75 W. ROUND LAKE
- T. 152 N.-R. 80 W. BROWN
- T. 152 N.-R. 79 W. VOLTAIRE
- T. 152 N.-R. 78 W. ODIN
- T. 152 N.-R. 77 W. BALFOUR
- T. 152 N.-R. 76 W. STREGIE
- T. 152 N.-R. 75 W. SCHILLER
- T. 151 N.-R. 80 W. BJORNSON
- T. 151 N.-R. 79 W. OLIVA
- T. 151 N.-R. 78 W. COTTONWOOD LAKE
- T. 151 N.-R. 77 W. LAND
- T. 151 N.-R. 76 W. SPRING GROVE
- T. 151 N.-R. 75 W. ANAMOOSE

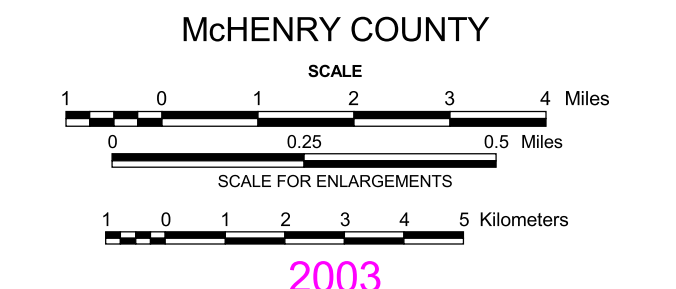
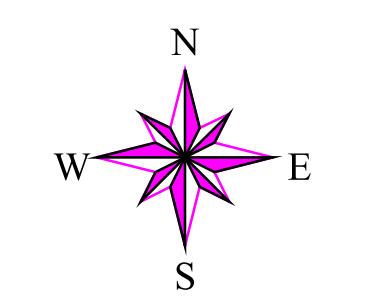
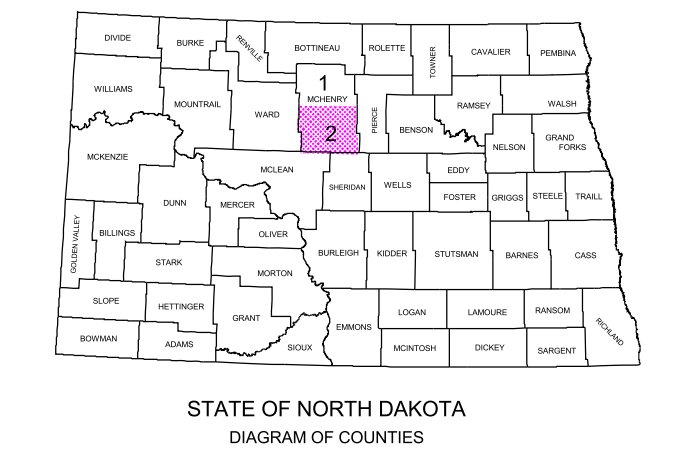

2003

COPIES OF THIS MAP ARE AVAILABLE FOR PUBLIC USE AT A NOMINAL COST FROM:
 MAP SALES, N.D. DEPT. OF TRANSPORTATION, 606 E. BLVD. AVE., BISMARCK, N.D. 58505-0700
 f:\planningarcview\stevemcmcbk\.....