

2007 FUNCTIONAL CLASSIFICATION

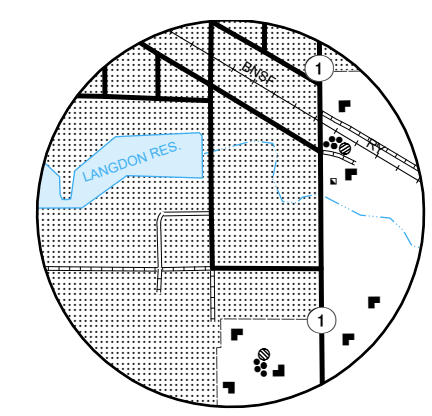

LANGDON NO. 1
SECS 23 & 24, T. 161 N., R. 60 W.

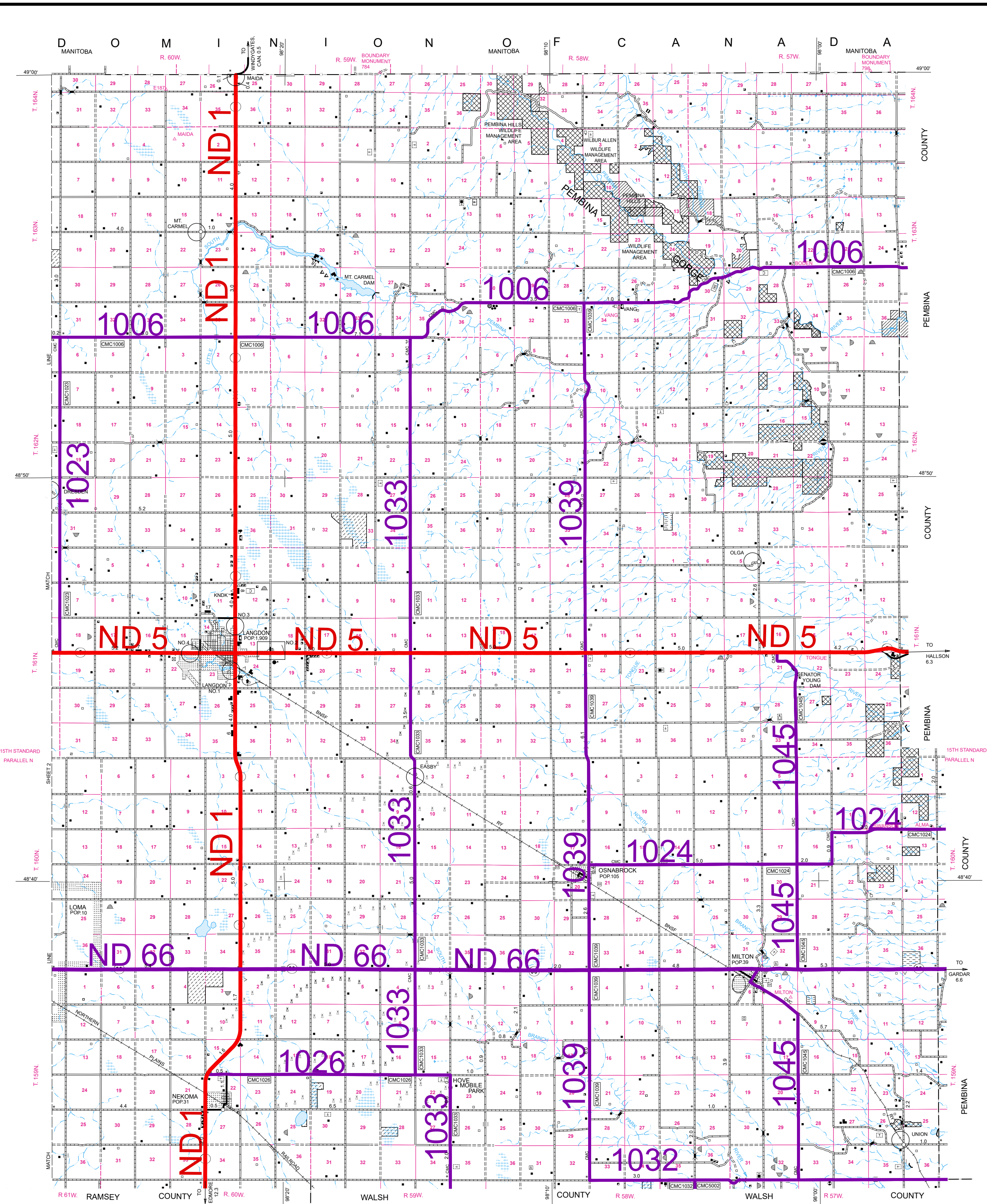
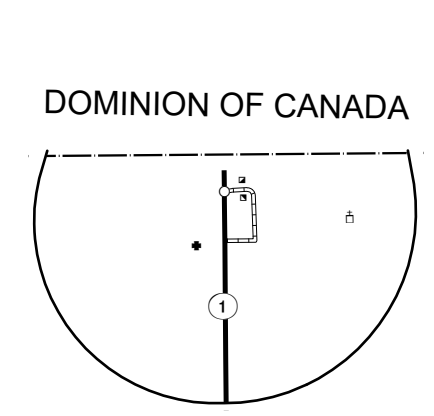

MAIDA
SECS 25, 26, T. 164 N., R. 60 W.

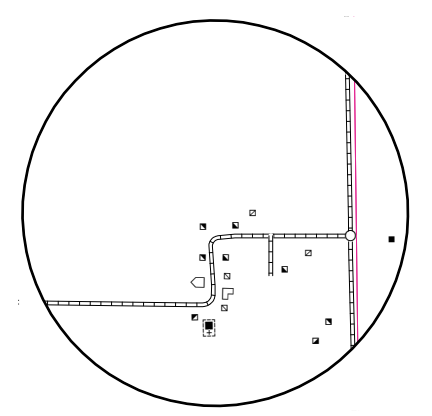

OLGA
SECS 4 & 5, T. 161 N., R. 57 W.

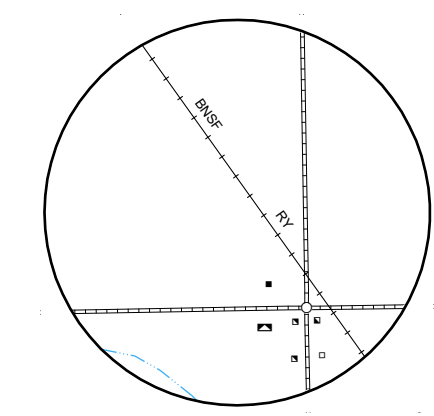

UNION
SECS 25, 26, 35, & 36, T. 159 N., R. 57 W.

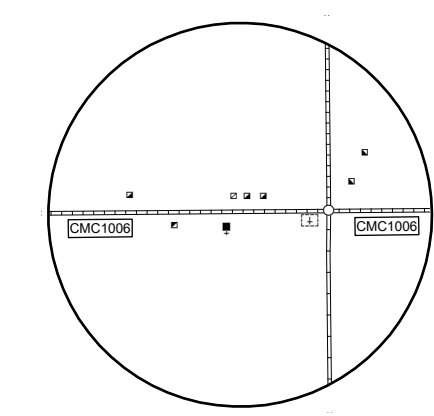

MT. CARMEL
SECS 14, 15, 22, & 23, T. 163 N., R. 60 W.

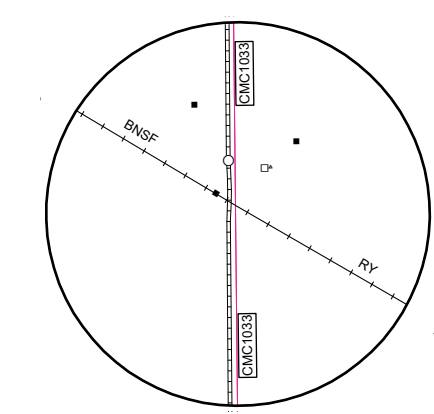

EASBY
SECS 3 & 4, T. 160 N., R. 59 W.

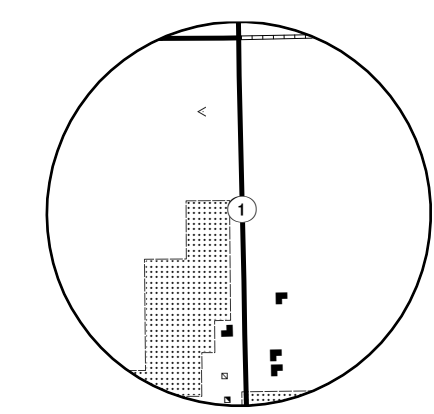

INSET NO. 3
SECS 13, & 14, T. 161 N., R. 60 W.

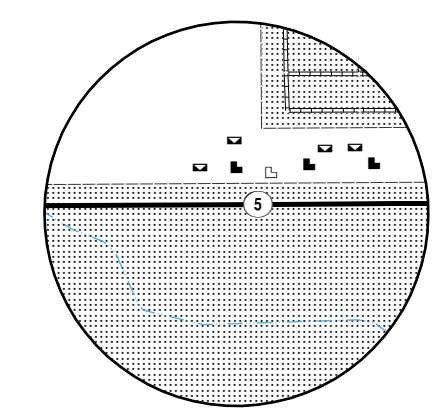

INSET NO. 4
SECS 15, & 22, T. 161 N., R. 60 W.

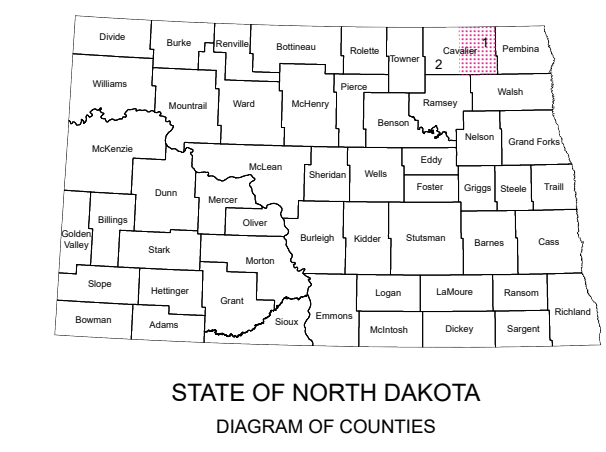

STATE OF NORTH DAKOTA
DIAGRAM OF COUNTIES

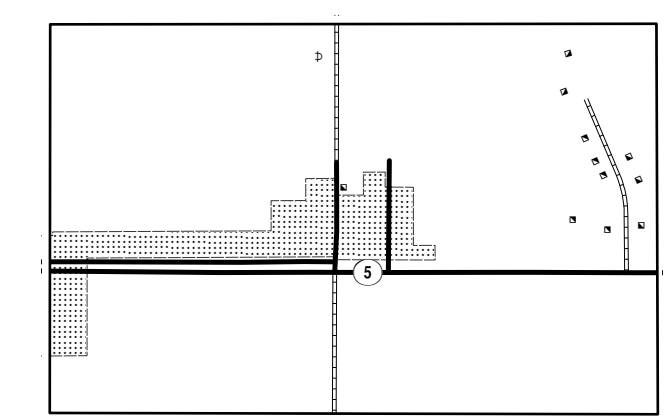

INSET NO. 2
SECS 18, & 19, T. 161 N., R. 59 W.
SECS 13, & 24, T. 161 N., R. 60 W.

DRESDEN INSET ENLARGEMENT
IS SHOWN ON SHEET 2.

FUNCTIONAL CLASSIFICATION	
—	PRINCIPAL ARTERIAL
—	MINOR ARTERIAL
—	MAJOR COLLECTOR

REVISION DATE AND CHANGE	
03-18-2011	Remove 7.0 miles from CMC1032
11-16-2018	Remove 11.0 miles from CMC1006
11-16-2018	Add 11.0 miles to CMC1006
11-16-2018	Remove 3.0 miles from CMC1023
11-16-2018	Transfer 3.0 miles from CMC1017 to CMC1006

GENERAL LEGEND

<p>ROADS AND ROADWAY FEATURES</p> <ul style="list-style-type: none"> PRIMITIVE ROAD UNIMPROVED ROAD GRADED AND DRAINED ROAD GRAVEL GRADED AND DRAINED ROAD PAVED ROAD STREETS IN UNINCORPORATED AREAS COUNTY MAJOR COLLECTOR ROUTE NUMBER POINTS BETWEEN WHICH DISTANCES ARE MEASURED U.S. NUMBERED HIGHWAY STATE HIGHWAY SYSTEM <p>BOUNDARIES</p> <ul style="list-style-type: none"> MONUMENTED BOUNDARY MARKER NATIONAL BOUNDARY LINE COUNTY LINE TOWNSHIP LINE CORPORATE LINE SECTION LINE MATCH LINE BETWEEN ADJOINING SHEETS OF SAME COUNTY BOUNDARY TO MARK ENLARGEMENT INSET WILDLIFE MANAGEMENT AREA WATERFOWL PRODUCTION AREA STATE FOREST STATE SCHOOL LAND <p>STRUCTURES</p> <ul style="list-style-type: none"> HIGHWAY BRIDGE, GENERAL HIGHWAY GRADE SEPARATION DAM WITH ROAD MINOR DRAINAGE STRUCTURE CONCRETE FORD OR DIP FORD - ROAD ESTABLISHED <p>RAILROADS</p> <ul style="list-style-type: none"> RAILROAD (ANY NUMBER OF TRACKS USED BY A SINGLE OPERATING CO.) RAILROAD STATION RAILROAD GRADE CROSSING <p>CITY AND VILLAGE CENTERS</p> <ul style="list-style-type: none"> COUNTY SEAT OTHER CITIES AND VILLAGES INCORPORATED CITY OR VILLAGE (GENERALIZED) <p>NAVIGATION</p> <ul style="list-style-type: none"> DOCK, PIER, OR LANDING 	<p>FARM UNITS, DWELLINGS, ETC.</p> <ul style="list-style-type: none"> FARM UNIT (FARM UNITS SHOWN IN BUILDINGS FOR FARM USE) DWELLING OTHER THAN FARM ROWS OR GROUPS OF DWELLINGS CLOSELY SPACED (FIGURE DENOTES NUMBER OF DWELLINGS) SEASONAL OR SUMMER COLONY DWELLING SEASONAL DWELLINGS CLOSELY SPACED CHURCH CHURCH WITH CEMETERY ADJACENT WELL <p>INDUSTRIAL</p> <ul style="list-style-type: none"> STORE OR SMALL BUSINESS ESTABLISHMENT FACTORY OR INDUSTRIAL PLANT GAS TANK GROUP OF STORAGE TANKS (OIL OR GAS) GAUGING OR PUMPING STATION WAREHOUSE - GENERAL GRAIN ELEVATOR GRAVEL PIT OIL OR GAS WELL WIND TURBINE <p>PUBLIC SERVICE FACILITIES</p> <ul style="list-style-type: none"> HIGHWAY GARAGE GARBAGE OR RUBBISH DUMP SEWAGE DISPOSAL PLANT AUTOMOBILE GRAVEYARD WATER SUPPLY STAND PIPE OR TANK POWER SUBSTATION BROADCASTING STATION (RADIO OR TV) COMMUNICATION TOWER U.S. BORDER CUSTOMS STATION <p>EDUCATIONAL AND CORRECTIONAL INSTITUTIONS</p> <ul style="list-style-type: none"> SCHOOLHOUSE TOWNHALL, GRANGE, OR COMMUNITY HALL AGRICULTURAL EXPERIMENT STATION MUSEUM - GENERAL <p>CONSERVATION AND RECREATION</p> <ul style="list-style-type: none"> PICNIC GROUND SCENIC SITE CAMP SITE, NO PERMANENCE (TENTS OR TRAILER PARKING) SKI AREA GOLF GROUND OR COUNTRY CLUB <p>AIRPORTS</p> <ul style="list-style-type: none"> LANDING AREA OR STRIP <p>MISCELLANEOUS</p> <ul style="list-style-type: none"> TRIANGULATION STATION DOT TO INDICATE LOCATION OF ANY CULTURAL FEATURE SHOWN OUT OF POSITION ALL VACANT CULTURE INDICATED BY OPEN SYMBOL LATITUDE AND LONGITUDE
---	--

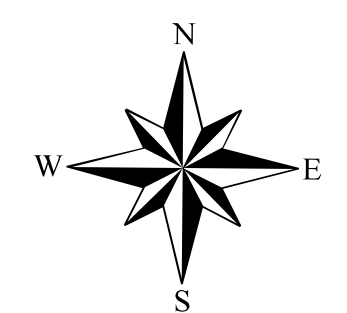

GENERAL HIGHWAY MAP CAVALIER COUNTY NORTH DAKOTA

PREPARED BY THE
NORTH DAKOTA DEPARTMENT OF TRANSPORTATION
PLANNING AND ASSET MANAGEMENT DIVISION
IN COOPERATION WITH THE
U.S. DEPARTMENT OF TRANSPORTATION
FEDERAL HIGHWAY ADMINISTRATION

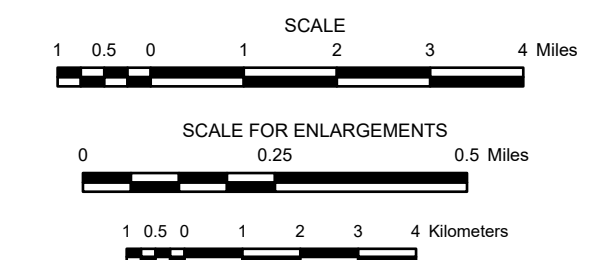

2021

BASED ON AERIAL PHOTOGRAPHY OF 1959
AERIAL INVENTORY OF 2021

UNIVERSAL TRANSVERSE MERCATOR ZONE 14
NORTH AMERICAN DATUM 83

Notice of Disclaimer
The North Dakota Department of Transportation (NDOT) makes this map available on an "as is" basis as a public service. Under no circumstances does NDOT warrant or certify the information to be free of errors or deficiencies of any kind. NDOT specifically disclaims all warranties, express or implied, including but not limited to the warranties of merchantability and fitness for a particular purpose.