

FUNCTIONAL CLASSIFICATION

- PRINCIPAL ARTERIAL
- MINOR ARTERIAL
- MAJOR COLLECTOR

REVISION DATE AND CHANGE

12-11-2007	Changed CMC0329 in Oberon
06-10-2010	Removed 3 miles of CMC0314
07-27-2015	Added 2 miles to CMC0309

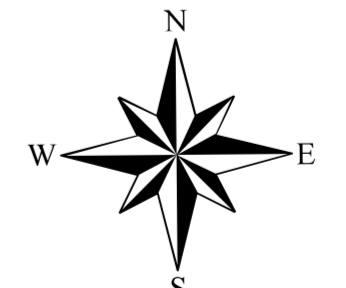

GENERAL HIGHWAY MAP
BENSON COUNTY
 NORTH DAKOTA

PREPARED BY THE
 NORTH DAKOTA DEPARTMENT OF TRANSPORTATION
 PLANNING AND ASSET MANAGEMENT DIVISION

IN COOPERATION WITH THE
 U.S. DEPARTMENT OF TRANSPORTATION
 FEDERAL HIGHWAY ADMINISTRATION

SCALE
 1 0.5 0 1 2 3 4 Miles

SCALE FOR ENLARGEMENTS
 0 0.25 0.5 Miles

1 0.5 0 1 2 3 4 Kilometers

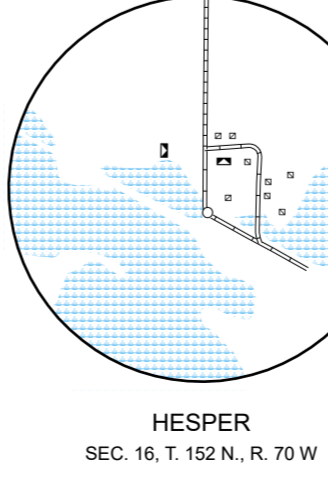
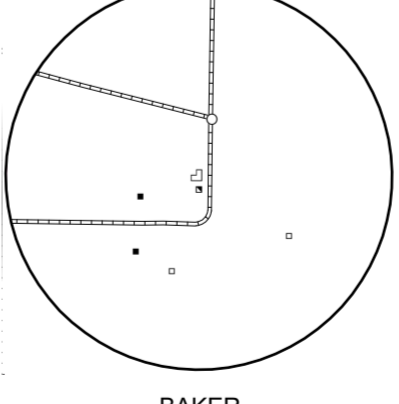
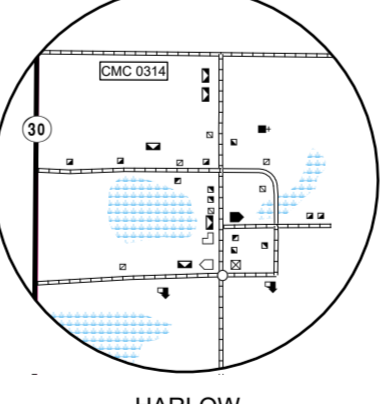
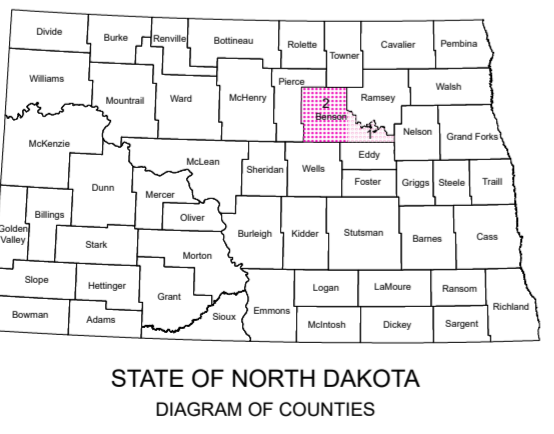
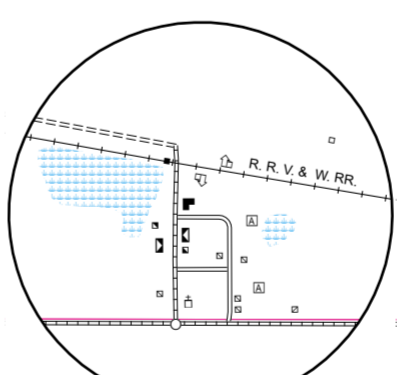
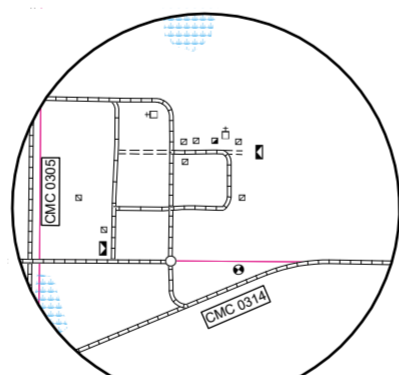
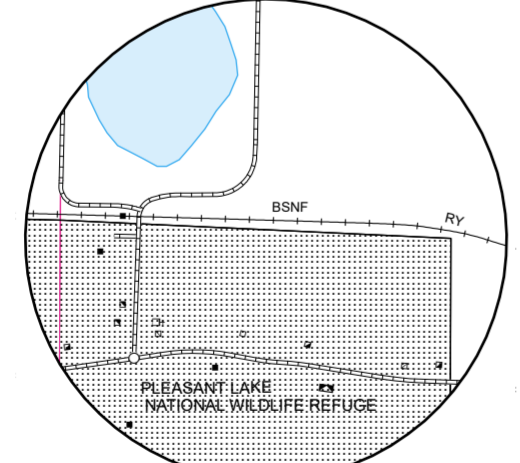

NAME AND LOCATION OF ORGANIZED CIVIL TOWNSHIPS
 THOSE UNORGANIZED ARE SO NOTED

T. 156 N. - R. 71 W. PLEASANT LAKE	T. 153 N. - R. 71 W. ESMOND	T. 151 N. - R. 67 W. OBERON
T. 156 N. - R. 70 W. KNOX	T. 153 N. - R. 70 W. ISABEL	T. 152 N. - R. 67 W. LALLIE
T. 156 N. - R. 69 W. YORK	T. 153 N. - R. 69 W. ALBERT	T. 153 N. - R. 66 W. LALLIE
T. 156 N. - R. 68 W. LEEDS	T. 153 N. - R. 68 W. ELDON	T. 152 N. - R. 66 W. LALLIE
T. 156 N. - R. 67 W. IRVINE	T. 153 N. - R. 67 W. WEST BAY	T. 151 N. - R. 65 W. UNORGANIZED
T. 155 N. - R. 71 W. IOWA	T. 153 N. - R. 66 W. UNORGANIZED	T. 152 N. - R. 65 W. GRAND HARBOR
T. 155 N. - R. 70 W. TWIN LAKE	T. 153 N. - R. 64 W. MISSION	T. 151 N. - R. 71 W. EAST FORK
T. 155 N. - R. 69 W. BEAVER	T. 153 N. - R. 63 W. MISSION	T. 151 N. - R. 70 W. ARNE
T. 155 N. - R. 68 W. LAKE IBSEN	T. 152 N. - R. 65 W. CREEK	T. 151 N. - R. 69 W. SOUTH VIKING
T. 155 N. - R. 67 W. NORMANIA	T. 152 N. - R. 64 W. MISSION	T. 151 N. - R. 68 W. WEST ANTELOPE
T. 154 N. - R. 71 W. IMPARK	T. 152 N. - R. 63 W. MISSION	T. 151 N. - R. 66 W. ROCK
T. 154 N. - R. 70 W. BROE	T. 152 N. - R. 63 W. LOHNES	T. 151 N. - R. 65 W. TWIN TREE
T. 154 N. - R. 69 W. BUTTE VALLEY	T. 152 N. - R. 71 W. RICH VALLEY	T. 151 N. - R. 71 W. WOOD LAKE
T. 154 N. - R. 68 W. MC CLELLAN	T. 152 N. - R. 70 W. HESPER	T. 151 N. - R. 62 W. WARWICK
T. 154 N. - R. 67 W. RIGGIN	T. 152 N. - R. 69 W. NORTH VIKING	T. 151 N. - R. 63 W. WARWICK
T. 154 N. - R. 66 W. RIGGIN	T. 152 N. - R. 68 W. AURORA	T. 151 N. - R. 62 W. MINCO
T. 153 N. - R. 66 W. RIGGIN	T. 152 N. - R. 67 W. OBERON	

Notice of Disclaimer
 The North Dakota Department of Transportation (NDOT) makes this map available on an "as is" basis as a public service. Under no circumstances does NDOT warrant or certify the information to be free of errors or deficiencies of any kind. NDOT specifically disclaims all warranties, express or implied, including but not limited to the warranties of merchantability and fitness for a particular purpose.

BASED ON AERIAL PHOTOGRAPHY OF 1957
 AERIAL INVENTORY OF 2022

UNIVERSAL TRANSVERSE MERCATOR ZONE 14
 NORTH AMERICAN DATUM 83