

YPSILANTI  
SEC'S. 6, 7 & 18 T. 138 N., R. 62 W.  
SEC'S. 1, 12 & 13 T. 138 N., R. 63 W.

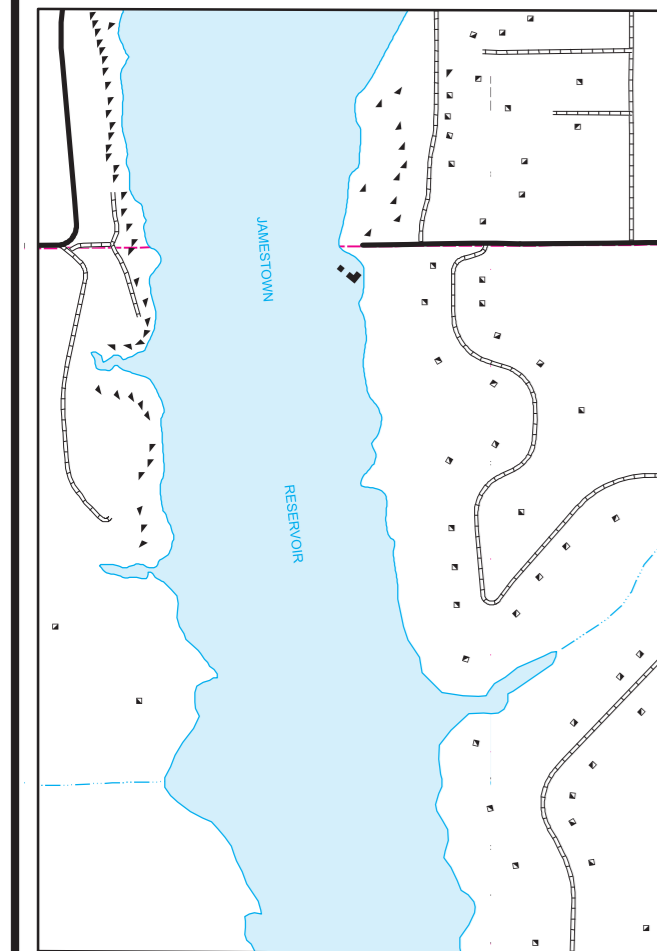

INSET NO. 3  
SEC'S. 1 & 2, T. 140 N., R. 64 W.  
SEC'S. 31 & 32, T. 141 N., R. 63 W.

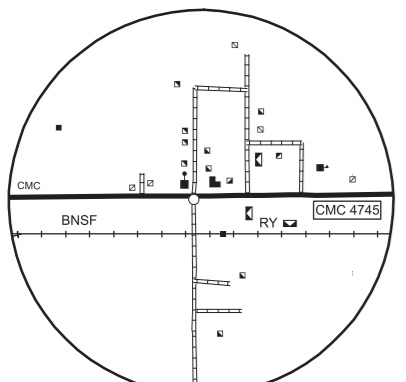

SPRITWOOD  
SEC'S. 15 & 22, T. 140 N., R. 62 W.

NAME AND LOCATION OF ORGANIZED CIVIL TOWNSHIPS  
THOSE UNORGANIZED ARE SO NOTED

T. 144 N.-R. 69 W. LOWERY	T. 140 N.-R. 69 W. PETERSON
T. 144 N.-R. 68 W. CONKLIN	T. 140 N.-R. 68 W. FLINT
T. 144 N.-R. 67 W. GLACIER	T. 140 N.-R. 67 W. WELD
T. 144 N.-R. 66 W. WALTERS	T. 140 N.-R. 66 W. WINDSOR
T. 144 N.-R. 65 W. EDMUNDS	T. 140 N.-R. 65 W. ELDRIDGE
T. 144 N.-R. 64 W. KENSAL	T. 140 N.-R. 64 W. MIDWAY
T. 144 N.-R. 63 W. NOGOSEK	T. 140 N.-R. 63 W. BLOOM
T. 144 N.-R. 62 W. CORINNE	T. 140 N.-R. 62 W. SPIRITWOOD
T. 143 N.-R. 69 W. GERBER	T. 139 N.-R. 69 W. SAINT PAUL
T. 143 N.-R. 68 W. WADSWORTH	T. 139 N.-R. 68 W. CHICAGO
T. 143 N.-R. 67 W. UNORGANIZED	T. 139 N.-R. 67 W. STIRTON
T. 143 N.-R. 66 W. PIPESTEM VALLEY	T. 139 N.-R. 66 W. MOON LAKE
T. 143 N.-R. 65 W. PINGREE	T. 139 N.-R. 65 W. LIPPERT
T. 143 N.-R. 64 W. LYON	T. 139 N.-R. 64 W. WOODBURY
T. 143 N.-R. 63 W. DURHAM	T. 139 N.-R. 63 W. HOMER
T. 143 N.-R. 62 W. COURTENAY	T. 139 N.-R. 62 W. WINFIELD
T. 142 N.-R. 69 W. MARSTON MOOR	T. 138 N.-R. 69 W. NEWBURY
T. 142 N.-R. 68 W. STRONG	T. 138 N.-R. 68 W. BLOOMFIELD
T. 142 N.-R. 67 W. PARIS	T. 138 N.-R. 67 W. SINCLAIR
T. 142 N.-R. 66 W. ROUND TOP	T. 138 N.-R. 66 W. CUSATOR
T. 142 N.-R. 65 W. PLAINVIEW	T. 138 N.-R. 65 W. LENTON
T. 142 N.-R. 64 W. JIM RIVER VALLEY	T. 138 N.-R. 64 W. SYDNEY
T. 142 N.-R. 63 W. ASHLAND	T. 138 N.-R. 63 W. CORWIN
T. 142 N.-R. 62 W. GRAY	T. 138 N.-R. 62 W. YPSILANTI
T. 141 N.-R. 69 W. UNORGANIZED	T. 137 N.-R. 69 W. STREETER
T. 141 N.-R. 68 W. IOSCO	T. 137 N.-R. 68 W. GERMANIA
T. 141 N.-R. 67 W. VALLEY SPRING	T. 137 N.-R. 67 W. GRIFFIN
T. 141 N.-R. 66 W. DEER LAKE	T. 137 N.-R. 66 W. ALEXANDER
T. 141 N.-R. 65 W. HIDDEN	T. 137 N.-R. 65 W. SHARLOW
T. 141 N.-R. 64 W. BUCHANAN	T. 137 N.-R. 64 W. SEVERN
T. 141 N.-R. 63 W. FRIED	T. 137 N.-R. 63 W. MONTPELIER
T. 141 N.-R. 62 W. ROSE	T. 137 N.-R. 62 W. MANN'S

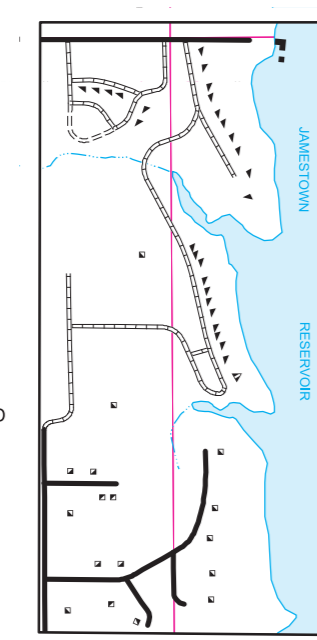

INSET NO. 5  
SEC'S. 1, 2, 11, & 12, T. 140 N., R. 64 W.

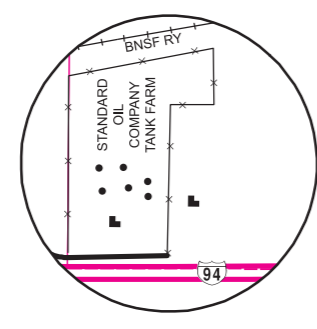

INSET NO. 2  
SEC'S. 32 & 33, T. 140 N., R. 65 W.  
SEC'S. 4, 5, T. 139 N., R. 65 W.

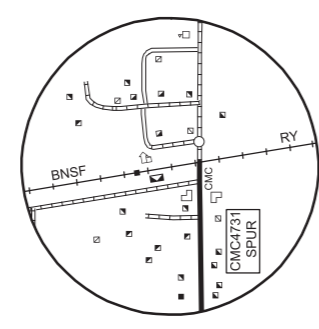

ELDRIDGE  
SEC. 35, T. 140 N., R. 65 W.

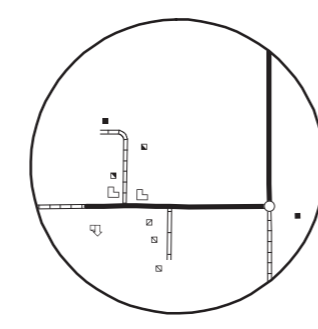

MILLARTON  
SEC'S. 21, & 22, T. 137 N., R. 64 W.

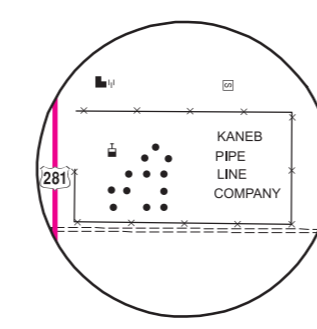

WINDSOR  
SEC'S. 11, 12, & 13, T. 139 N., R. 64 W.

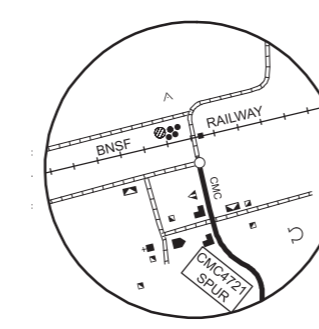

WINDSOR  
SEC'S. 32, T. 140 N., R. 66 W.

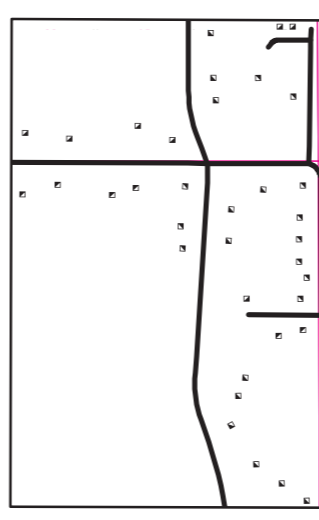

INSET NO. 6  
SEC'S. 11, 12, 13, & 14, T. 140 N., R. 64 W.

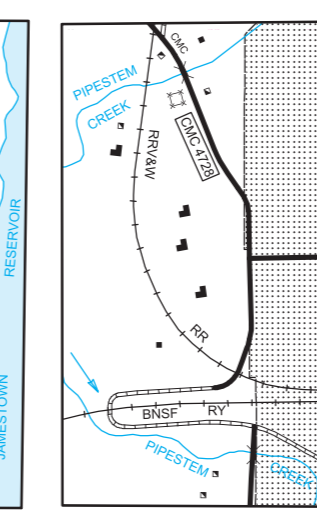

JAMESTOWN NO. 1  
SEC'S. 26, & 27, T. 140 N., R. 64 W.

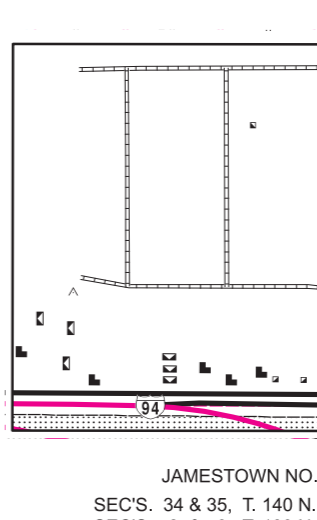

JAMESTOWN NO. 2  
SEC'S. 34 & 35, T. 140 N., R. 64 W.  
SEC'S. 2 & 3, T. 139 N., R. 64 W.

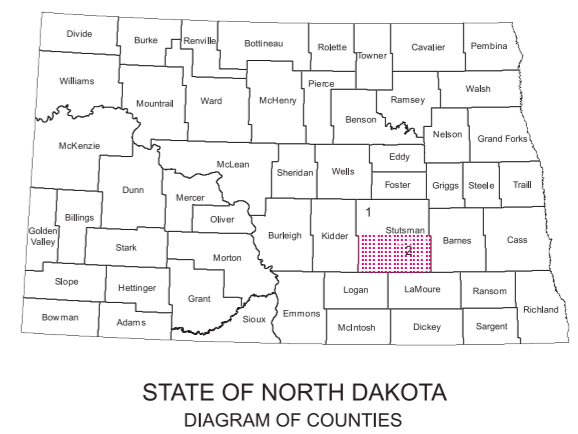

STATE OF NORTH DAKOTA  
DIAGRAM OF COUNTIES

BASED ON AERIAL PHOTOGRAPHY OF 1954  
GROUND INVENTORY OF 2016

UNIVERSAL TRANSVERSE MERCATOR ZONE 14  
NORTH AMERICAN DATUM 83

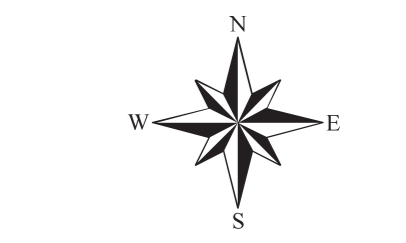

STUTSMAN COUNTY

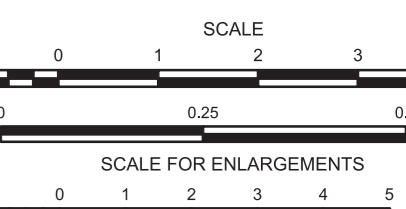

2016