

NAME AND LOCATION OF ORGANIZED CIVIL TOWNSHIPS  
THOSE UNORGANIZED ARE SO NOTED

T. 141 N.-R. 93 W. UNORGANIZED	T. 139 N.-R. 98 W. UNORGANIZED	T. 138 N.-R. 94 W. UNORGANIZED
T. 141 N.-R. 92 W. UNORGANIZED	T. 139 N.-R. 97 W. UNORGANIZED	T. 138 N.-R. 93 W. UNORGANIZED
T. 141 N.-R. 91 W. UNORGANIZED	T. 139 N.-R. 96 W. UNORGANIZED	T. 138 N.-R. 92 W. UNORGANIZED
T. 140 N.-R. 99 W. UNORGANIZED	T. 139 N.-R. 95 W. UNORGANIZED	T. 137 N.-R. 91 W. UNORGANIZED
T. 140 N.-R. 98 W. UNORGANIZED	T. 139 N.-R. 94 W. UNORGANIZED	T. 137 N.-R. 90 W. UNORGANIZED
T. 140 N.-R. 97 W. UNORGANIZED	T. 139 N.-R. 93 W. UNORGANIZED	T. 137 N.-R. 89 W. UNORGANIZED
T. 140 N.-R. 96 W. UNORGANIZED	T. 139 N.-R. 92 W. UNORGANIZED	T. 137 N.-R. 88 W. UNORGANIZED
T. 140 N.-R. 95 W. UNORGANIZED	T. 139 N.-R. 91 W. UNORGANIZED	T. 137 N.-R. 87 W. UNORGANIZED
T. 140 N.-R. 94 W. UNORGANIZED	T. 138 N.-R. 99 W. UNORGANIZED	T. 137 N.-R. 86 W. UNORGANIZED
T. 140 N.-R. 93 W. UNORGANIZED	T. 138 N.-R. 98 W. UNORGANIZED	T. 137 N.-R. 85 W. UNORGANIZED
T. 140 N.-R. 92 W. UNORGANIZED	T. 138 N.-R. 97 W. UNORGANIZED	T. 137 N.-R. 84 W. UNORGANIZED
T. 140 N.-R. 91 W. UNORGANIZED	T. 138 N.-R. 96 W. UNORGANIZED	T. 137 N.-R. 83 W. UNORGANIZED
T. 139 N.-R. 99 W. UNORGANIZED	T. 138 N.-R. 95 W. UNORGANIZED	T. 137 N.-R. 82 W. UNORGANIZED
T. 139 N.-R. 98 W. UNORGANIZED	T. 138 N.-R. 94 W. UNORGANIZED	T. 137 N.-R. 81 W. UNORGANIZED

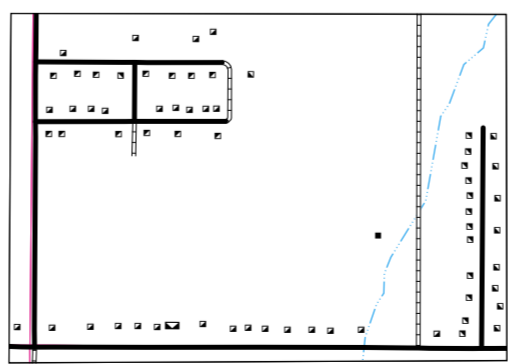

STATE OF NORTH DAKOTA  
DIAGRAM OF COUNTIES



INSET NO. 5  
SEC'S 16, 17, 20, & 21, T. 139 N., R. 96 W.

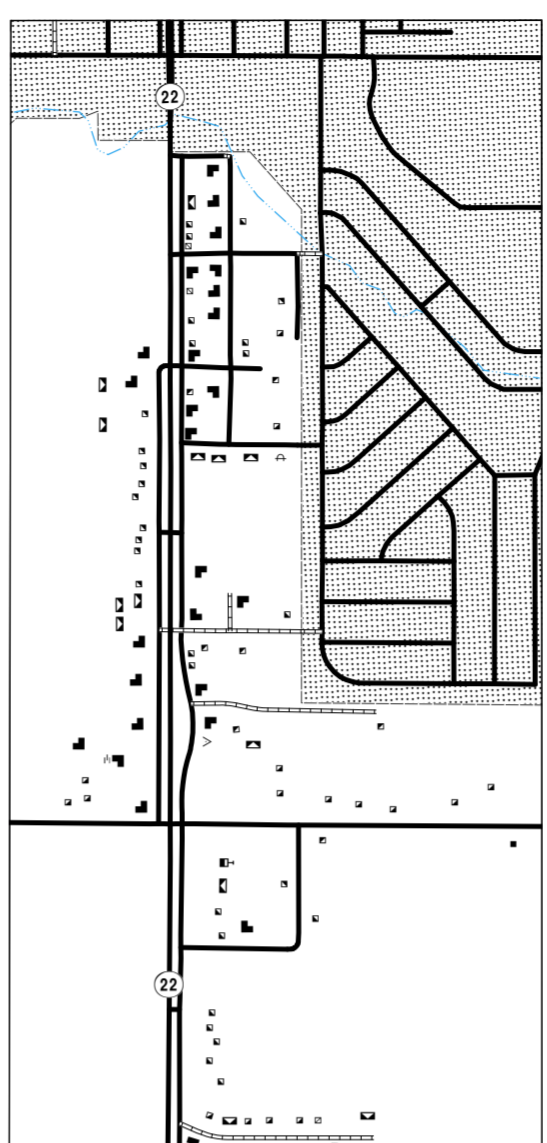

DICKINSON NO. 1  
SEC'S 9, 10, 15, 16, 21, & 22, T. 139 N., R. 96 W.

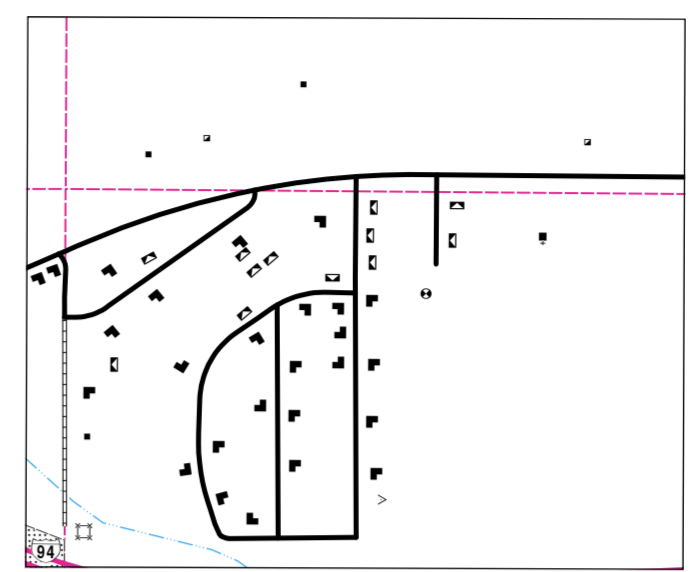

DICKINSON NO. 4  
SEC. 36, T. 149 N., R. 96 W. SEC. 31, T. 140 N., R. 95 W.  
SEC. 1, T. 139 N., R. 96 W. SEC. 6, T. 139 N., R. 95 W.

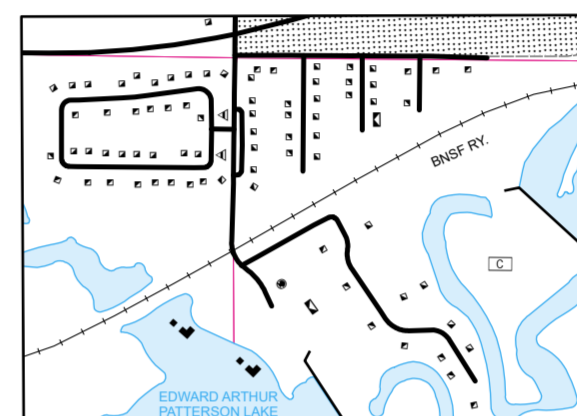

DICKINSON NO. 3  
SEC'S 5, 6, 7, & 8, T. 139 N., R. 96 W.

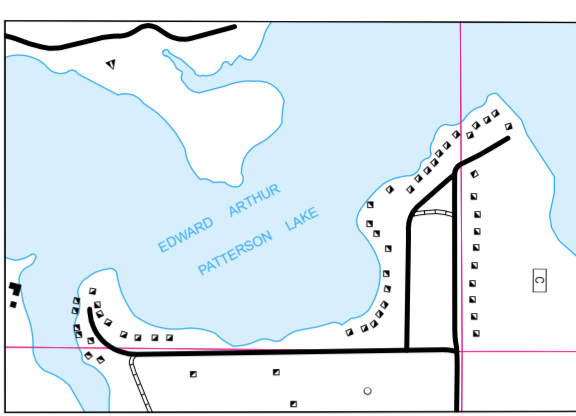

PATTERSON LAKE NO. 1  
SEC'S 7, 8, 17, & 18, T. 139 N., R. 96 W.

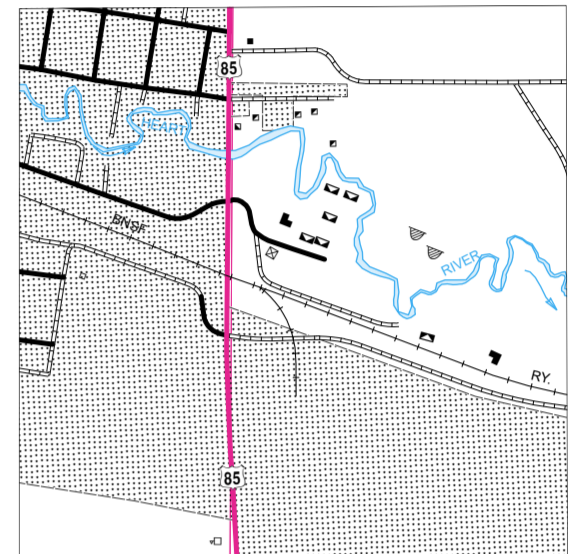

BELFIELD NO. 1  
SEC'S 4 & 5, T. 139 N., R. 99 W.

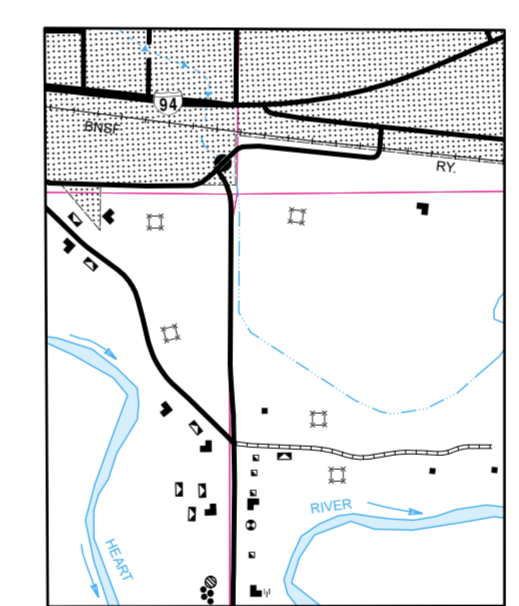

DICKINSON NO. 2  
SEC'S 2, 3, 10, & 11, T. 139 N., R. 96 W.

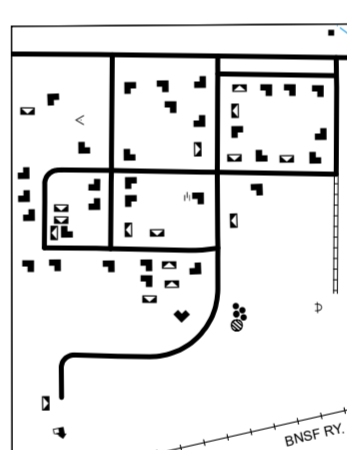

INSET NO. 4  
SEC'S 6, & 7, T. 139 N., R. 96 W.

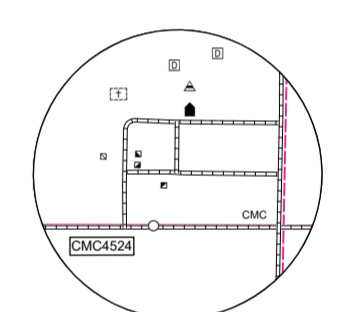

SCHEFIELD  
SEC'S 13 & 24, T. 137 N., R. 97 W.  
SEC'S 18 & 19, T. 137 N., R. 96 W.

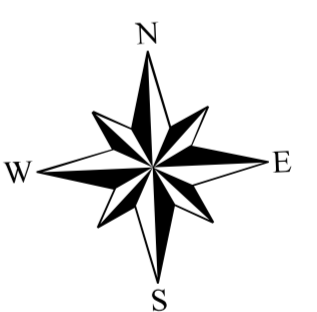

# GENERAL HIGHWAY MAP STARK COUNTY NORTH DAKOTA

PREPARED BY THE  
NORTH DAKOTA DEPARTMENT OF TRANSPORTATION  
PLANNING AND ASSET MANAGEMENT DIVISION  
IN COOPERATION WITH THE  
U.S. DEPARTMENT OF TRANSPORTATION  
FEDERAL HIGHWAY ADMINISTRATION

SCALE  
1 0.5 0 1 2 3 4 Miles

SCALE FOR ENLARGEMENTS  
0 0.25 0.5 Miles

1 0.5 0 1 2 3 4 Kilometers

2020

BASED ON AERIAL PHOTOGRAPHY OF 1993 UNIVERSAL TRANSVERSE MERCATOR ZONE 14  
AERIAL INVENTORY OF 2020 NORTH AMERICAN DATUM 83

**Notice of Disclaimer**  
The North Dakota Department of Transportation (NDOT) makes this map available on an "as is" basis as a public service. Under no circumstances does NDOT warrant or certify the information to be free of errors or deficiencies of any kind. NDOT specifically disclaims all warranties, express or implied, including but not limited to the warranties of merchantability and fitness for a particular purpose.